



MLS 5755194 Lake Home

\$249,900

900 sq ft
1 bedrooms
1 baths

715 Lake Shore Drive
Bemidji MN 56601

Waterfront: Bemidji (main lake)

Status: Hold

Description:

Welcome to Bemidji's premier condominium development on the South Shore of Lake Bemidji! The Bixby will offer secure indoor parking, two elevators, triple pane windows, soundproof insulation, and private balconies. Quartz countertops and Onyx Shower systems in every unit. Appliance, kitchen and trim packages available. Association fee will include natural gas, water, sewer and refuse. This floor plan, 'The Schoolcraft' is 1 bedroom 1 bath and 900 sf. Unit 203 is located on the second floor with south facing views. The Schoolcraft is available on both floors with southern exposure. Choose early and get your favorite unit just the way you like it!

Additional Details:

Year Built	2022
Lot Dimensions	348x228
Garage Stalls	1
School District	31
Taxes	\$982
Taxes with Assessments	\$982
Tax Year	2023

Additional Features:

Basement: None **Fuel:** Electric **Garage:** 1 **Heat:** Heat Pump **Sewer:** City Sewer/Connected **Water:** City Water/Connected **Air Conditioning:** Central Air

Driving Directions:

East on 1st Street to Central Ave SE, Left to Lakeshore Drive



Listed By:
Lake-N-Woods Realty, Inc.

Affinity Real Estate Inc. participates in the Regional Multiple Listing Service of Minnesota, Inc Broker Reciprocity (sm) program, allowing us to display other broker's listings on our website. All properties are subject to prior sale, change or withdrawal.



Call Affinity Real Estate

218-237-3333

info@affinityrealestate.com



Affinity Real Estate - 600 Park Avenue South - Park Rapids MN 56470

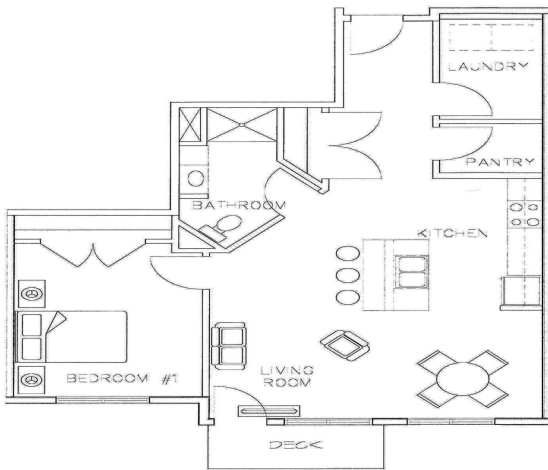

Updated May 30, 2023



LAKE VIEW

\$558,500	215	\$356,900	\$273,093	\$356,900	\$367,607	210	\$558,500
\$247,400	SOLD	SOLD	SOLD	SOLD	SOLD	SOLD	\$247,400
SOLD	201	202	203	LEASED	204	LEASED	205
\$237,200	\$314,100	\$249,900	\$249,900	\$314,100	\$249,900	\$314,100	\$237,200

LEVEL 2 PLAN

LAKE VIEW

\$558,500	115	\$346,595	\$259,708	\$336,500	\$346,595	110	\$558,500
\$233,900	LEASED	SOLD	LEASED	SOLD	LEASED	LEASED	\$233,900
LEASED	101	102	103	LEASED	104	105	106
\$227,000	\$303,900	\$239,600	\$224,300	\$303,900	\$239,600	\$303,900	\$227,000

UNIT 106
ADA ACCESSIBLE

LEVEL 1 PLAN

Lake N Woods Realty, Inc.
1032 Paul Bunyan Drive South (218) 751-2538 www.lakenwoods.com

©NWMAR



©NWMAR



©NWMAR

website: www.AffinityRealEstate.com | email: info@affinityrealestate.com | office: 218-237-3333 | fax: 218-237-3377



\$249,900
MLS 5755194 Lake Home
715 Lake Shore Drive
Bemidji MN 56601

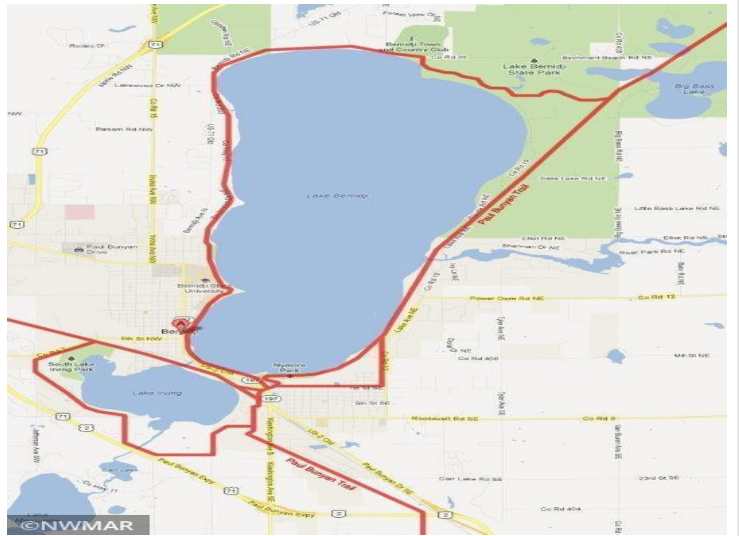

©NWMAR

©NWMAR

website: www.AffinityRealEstate.com | email: info@affinityrealestate.com | office: 218-237-3333 | fax:218-237-3377



\$249,900
MLS 5755194 Lake Home
715 Lake Shore Drive
Bemidji MN 56601



website: www.AffinityRealEstate.com | email: info@affinityrealestate.com | office: 218-237-3333 | fax:218-237-3377



\$249,900
MLS 5755194 Lake Home
715 Lake Shore Drive
Bemidji MN 56601