



MLS 6321928 Commercial

\$275,000

5024 State 84
Longville MN 56655

Status: Expired

Description:

Opportunity knocks! This charming cottage/cabin style building with great highway visibility (Hwy 184 & Co 5) is the perfect place to grow your business - the best location in the entire destination town of Longville - known for premium fishing, hunting and activities on Woman and Girl Lake for all ages – plus premium lakeshore to purchase and rent. The office is in excellent condition inside & out. It has been used as a real estate office. Open plan (9' ceiling) adjusts to your needs. Oversized 8' front windows provide exposure for showroom. There's ample space for company signs. There are 3 separate entrances & customer parking for 12. No building in town can boast of amenities included with this building. There's a lighted kiosk for product promotion in front at the HUB of the town. The Longville area is one of the strongest economic townships in the county. The building is located ¼ mile from airport & is walking distance to lakes!

Additional Details:

Year Built	2004
Lot Acres	0.1
Lot Dimensions	48 x 95
School District	118
Taxes	\$1,704
Taxes with Assessments	\$2,004
Tax Year	2023

Additional Features:

Basement: Concrete, Storage Space, Unfinished **Fuel:** Propane **Heat:** Forced Air **Sewer:** City Sewer/Connected **Water:** Sand Point, Well **Air Conditioning:** Central Air

Driving Directions:

From Brainerd N on 371 to Hackensack. E on Co 5 to Longville. Crossroads of Co 5 and St Hwy 84 - downtown Longville.



Listed By:
Dane Arthur Real Estate Agency-Longville

Affinity Real Estate Inc. participates in the Regional Multiple Listing Service of Minnesota, Inc Broker Reciprocity (sm) program, allowing us to display other broker's listings on our website. All properties are subject to prior sale, change or withdrawal.



Call Affinity Real Estate

218-237-3333

info@affinityrealestate.com



Affinity Real Estate - 600 Park Avenue South - Park Rapids MN 56470



website: www.AffinityRealEstate.com | email: info@affinityrealestate.com | office: 218-237-3333 | fax: 218-237-3377

Affinity
REAL ESTATE INC

\$275,000
MLS 6321928 Commercial
5024 State 84
Longville MN 56655



website: www.AffinityRealEstate.com | email: info@affinityrealestate.com | office: 218-237-3333 | fax: 218-237-3377

Affinity
REAL ESTATE INC

\$275,000
MLS 6321928 Commercial
5024 State 84
Longville MN 56655



website: www.AffinityRealEstate.com | email: info@affinityrealestate.com | office: 218-237-3333 | fax: 218-237-3377

Affinity
REAL ESTATE INC

\$275,000
MLS 6321928 Commercial
5024 State 84
Longville MN 56655

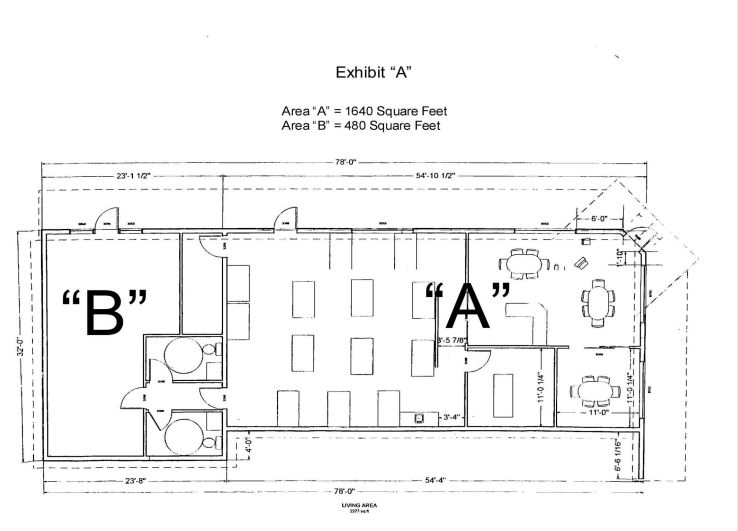

website: www.AffinityRealEstate.com | email: info@affinityrealestate.com | office: 218-237-3333 | fax: 218-237-3377

Affinity
REAL ESTATE INC

\$275,000
MLS 6321928 Commercial
5024 State 84
Longville MN 56655



website: www.AffinityRealEstate.com | email: info@affinityrealestate.com | office: 218-237-3333 | fax: 218-237-3377

Affinity
REAL ESTATE INC

\$275,000
MLS 6321928 Commercial
5024 State 84
Longville MN 56655