



MLS 6444443 Residential

\$252,000

1,160 sq ft
3 bedrooms
2 baths

9855 Boneset Drive
Bemidji MN 56601

Status: Active



FLOOR PLAN

This floor plan including furniture, fixture measurements and dimensions are approximate and for illustrative purposes only. BoxBrownie.com gives no guarantee, warranty or representation as to the accuracy and layout. All enquiries must be directed to the agent, vendor or party representing this floor plan.

Description:

Come home to this New Construction! 3 bedroom 2 bath one level home on a beautiful wooded lot. Open concept living, kitchen, dining. Two stall 24x28 heated garage. This home is located in Aspen Ridge one of the regions newest developments with close proximity to snowmobile trails and state land.

Additional Details:

Year Built	2023
Lot Acres	1.6
Lot Dimensions	320x355x420x75
Garage Stalls	2
School District	31
Taxes	\$254
Taxes with Assessments	\$254
Tax Year	2023

Additional Features:

Basement: None **Fuel:** Electric, Propane **Garage:** 2 **Heat:** Boiler, Ductless Mini-Split, Hot Water **Sewer:** Private Sewer, Septic System Compliant - Yes **Water:** Submersible - 4 Inch, Private, Well **Air Conditioning:** Ductless Mini-Split

Driving Directions:

Hwy 2 west to Wilton, turn north on Scribner Rd (Roth RV) 1 mile, left on Boneset, home is on the right.



Listed By:
Grimes Realty

Affinity Real Estate Inc. participates in the Regional Multiple Listing Service of Minnesota, Inc Broker Reciprocity (sm) program, allowing us to display other broker's listings on our website. All properties are subject to prior sale, change or withdrawal.



Call Affinity Real Estate

218-237-3333

info@affinityrealestate.com



Affinity Real Estate - 600 Park Avenue South - Park Rapids MN 56470

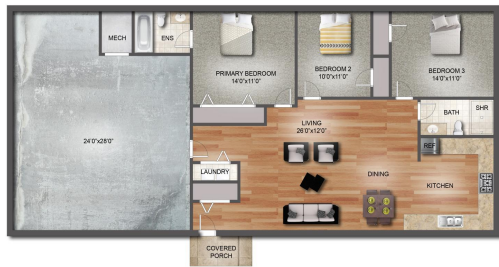

FLOOR PLAN

This floor plan including furniture, fixture measurements and dimensions are approximate and for illustrative purposes only. Measurements are given no guarantee, warranty or representation as to the accuracy and layout. All enquiries must be decided to the agent, vendor or party representing this floor plan.



website: www.AffinityRealEstate.com | email: info@affinityrealestate.com | office: 218-237-3333 | fax: 218-237-3377



\$252,000
MLS 6444443 Residential
9855 Boneset Drive
Bemidji MN 56601