



MLS 6479512 Lake Home

\$5,000,000

1,989 sq ft
4 bedrooms
3 baths

14588 230th Street
Park Rapids MN 56470

Waterfront: Potato

Status: Active

Description:

FAMILY RETREAT-FAMILY COMPOUND-INVESTMENT OPPORTUNITY...Step back in time to one of Minnesota's oldest resort getaways on Potato Lake, Park Rapids. This relic that features a main lodge built in 1914 also includes 21 separate cabins, complete with kitchens, bathrooms & guest quarters. This property boasts endless opportunities for recreation & entertainment. Play volleyball, shuffleboard, mini golf, ping pong, tennis (clay court) or sit in the beach pavilion, play in the lake or rent a boat for the day. Step inside the old lodge & read a book next to a roaring fire, or play pool & classic arcade games in the full game room. Children can also enjoy the upstairs reading and recreation room. Take a break in a massive, wood-burning sauna next to the lodge or build a campfire for the night. Other features include a laundry facility w/storage and 2 large log cabins that could be separate family homes all on their own. (Listed sq footage, bath & bed count refer to the largest log cabin #2).

Additional Details:

Year Built	1988
Lot Acres	35
Lot Dimensions	Irregular
School District	309
Taxes	\$28,861
Taxes with Assessments	\$30,520
Tax Year	2023

Additional Features:

Basement: None **Fuel:** Electric, Propane **Heat:** Baseboard, Forced Air, Space Heater **Sewer:** Shared Septic **Water:** Drilled, Shared System, Well
Air Conditioning: None

Driving Directions:

From Park Rapids go North on US-71 for 6.1 miles. Turn right on 230th St and follow to end of the road which will be 2 miles.



Listed By:
Your Home Sold Guaranteed Realty Exclusive

Affinity Real Estate Inc. participates in the Regional Multiple Listing Service of Minnesota, Inc Broker Reciprocity (sm) program, allowing us to display other broker's listings on our website. All properties are subject to prior sale, change or withdrawal.



Call Affinity Real Estate

218-237-3333

info@affinityrealestate.com



Affinity Real Estate - 600 Park Avenue South - Park Rapids MN 56470



website: www.AffinityRealEstate.com | email: info@affinityrealestate.com | office: 218-237-3333 | fax: 218-237-3377

Affinity
REAL ESTATE INC

\$5,000,000

MLS 6479512 Lake Home
14588 230th Street
Park Rapids MN 56470



website: www.AffinityRealEstate.com | email: info@affinityrealestate.com | office: 218-237-3333 | fax: 218-237-3377



\$5,000,000

MLS 6479512 Lake Home
14588 230th Street
Park Rapids MN 56470



website: www.AffinityRealEstate.com | email: info@affinityrealestate.com | office: 218-237-3333 | fax: 218-237-3377

Affinity
REAL ESTATE INC

\$5,000,000

MLS 6479512 Lake Home
14588 230th Street
Park Rapids MN 56470

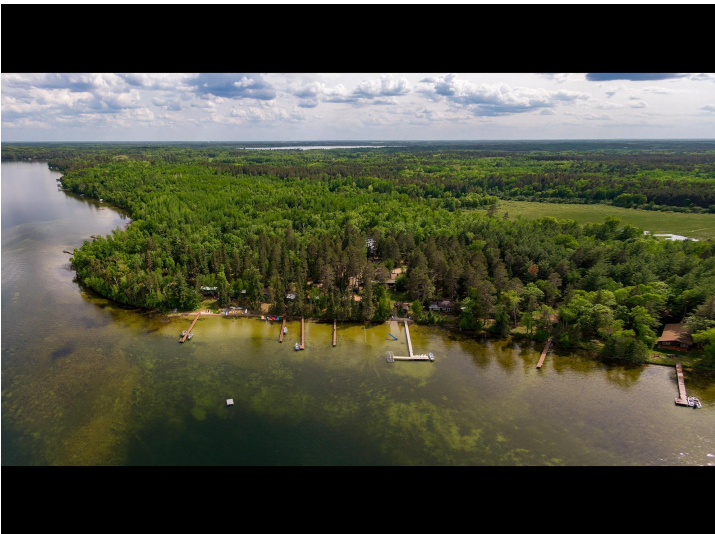

website: www.AffinityRealEstate.com | email: info@affinityrealestate.com | office: 218-237-3333 | fax: 218-237-3377

Affinity
REAL ESTATE INC

\$5,000,000

MLS 6479512 Lake Home
14588 230th Street
Park Rapids MN 56470

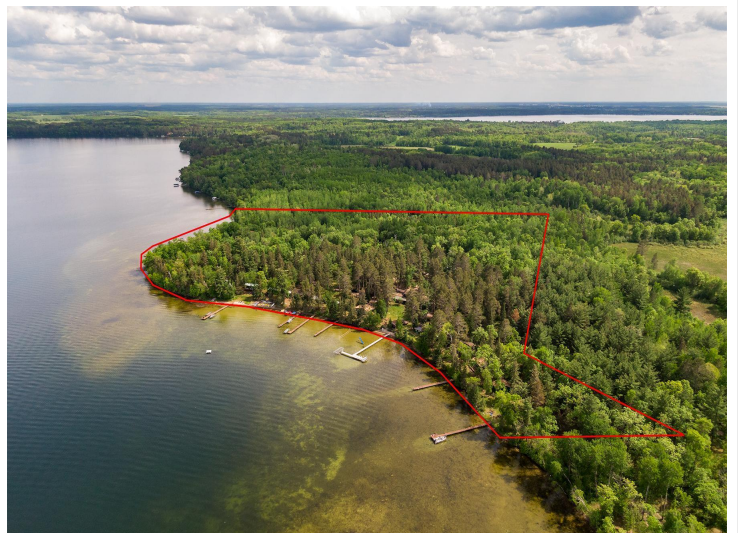

website: www.AffinityRealEstate.com | email: info@affinityrealestate.com | office: 218-237-3333 | fax: 218-237-3377



\$5,000,000
 MLS 6479512 Lake Home
 14588 230th Street
 Park Rapids MN 56470



website: www.AffinityRealEstate.com | email: info@affinityrealestate.com | office: 218-237-3333 | fax: 218-237-3377



\$5,000,000
MLS 6479512 Lake Home
14588 230th Street
Park Rapids MN 56470



website: www.AffinityRealEstate.com | email: info@affinityrealestate.com | office: 218-237-3333 | fax: 218-237-3377

Affinity
REAL ESTATE INC

\$5,000,000

MLS 6479512 Lake Home
14588 230th Street
Park Rapids MN 56470



website: www.AffinityRealEstate.com | email: info@affinityrealestate.com | office: 218-237-3333 | fax: 218-237-3377



\$5,000,000

MLS 6479512 Lake Home
14588 230th Street
Park Rapids MN 56470



website: www.AffinityRealEstate.com | email: info@affinityrealestate.com | office: 218-237-3333 | fax:218-237-3377



\$5,000,000

MLS 6479512 Lake Home
14588 230th Street
Park Rapids MN 56470