



MLS 6507557 Lake Land

\$1,599,500

Description:

Great Development Opportunity - 92 Acres consisting of 62 acres cropland, 10 acre wooded farmstead, 1,853 ft. waterfront with bay on Little Cormorant Lake (10-12 development lots possible), & or your own private compound! Farm rental income is also available. Easy access & commute to Fargo/Moorhead.

Additional Details:

Lot Acres	92
Lot Dimensions	1320 x
School District	2889
Taxes	\$5,110
Taxes with Assessments	\$5,110
Tax Year	2023

Additional Features:

Driving Directions:

Audubon, MN - South on Cty. Hwy. #11 for 3.7 miles, Right on 190th to signs on Left side of road.



Listed By:
SPILDE SUMMER REALTY

Affinity Real Estate Inc. participates in the Regional Multiple Listing Service of Minnesota, Inc Broker Reciprocity (sm) program, allowing us to display other broker's listings on our website. All properties are subject to prior sale, change or withdrawal.



Call Affinity Real Estate

218-237-3333

info@affinityrealestate.com



Affinity Real Estate - 600 Park Avenue South - Park Rapids MN 56470

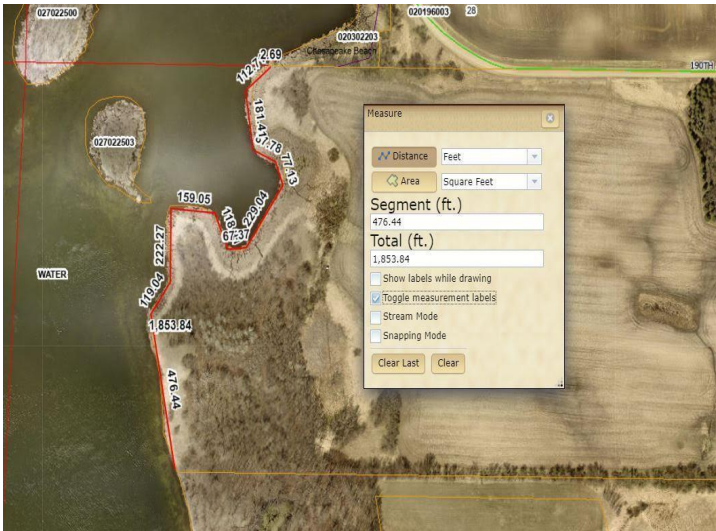
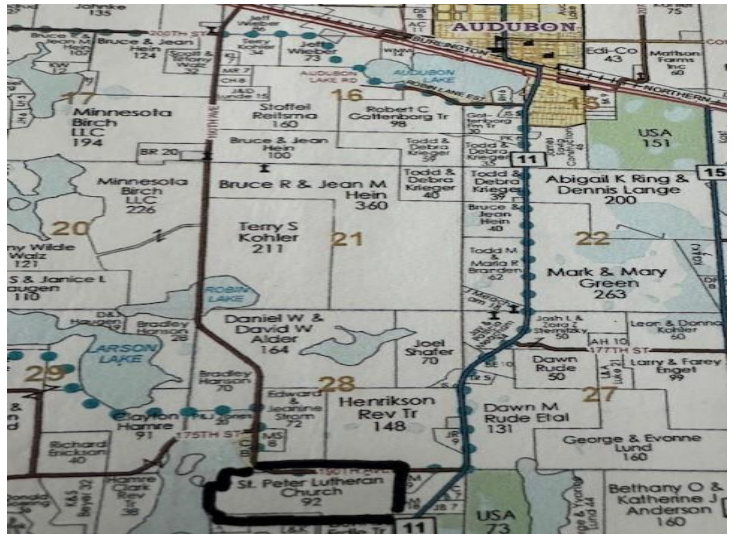

website: www.AffinityRealEstate.com | email: info@affinityrealestate.com | office: 218-237-3333 | fax: 218-237-3377



\$1,599,500
MLS 6507557 Lake Land
17354 190th Avenue
Audubon MN 56511



website: www.AffinityRealEstate.com | email: info@affinityrealestate.com | office: 218-237-3333 | fax: 218-237-3377



\$1,599,500
 MLS 6507557 Lake Land
 17354 190th Avenue
 Audubon MN 56511