



MLS 6511049 Commercial Sale

\$20

Description:

Location, Location! Just outside of downtown Bemidji, over 4000sf of space available adjacent to MN Dept. of Health. Rent includes taxes, insurance, CAM, Heat, Electric, and Water/Sewer/Garbage.

Additional Details:

Year Built	2005
Lot Acres	4.38
Lot Dimensions	320x600
School District	31
Taxes	\$36,472
Taxes with Assessments	\$36,472
Tax Year	2023

Additional Features:

Fuel: Natural Gas **Heat:** Forced Air **Sewer:** City Sewer/Connected **Water:** City Water/Connected

Driving Directions:

From Downtown: West on 5th Street past Post Office to property on Right. Space is next to MN Dept of Health.



Listed By:
Lake-N-Woods Realty, Inc.

Affinity Real Estate Inc. participates in the Regional Multiple Listing Service of Minnesota, Inc Broker Reciprocity (sm) program, allowing us to display other broker's listings on our website. All properties are subject to prior sale, change or withdrawal.



Call Affinity Real Estate

218-237-3333

info@affinityrealestate.com



Affinity Real Estate - 600 Park Avenue South - Park Rapids MN 56470

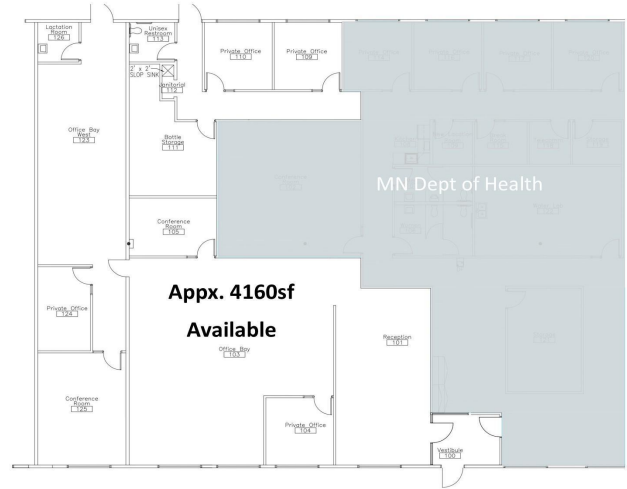

website: www.AffinityRealEstate.com | email: info@affinityrealestate.com | office: 218-237-3333 | fax:218-237-3377



\$20
MLS 6511049 Commercial
Sale
705 5th Street
Bemidji MN 56601