



MLS 6521043 Residential

\$349,800

2,371 sq ft
3 bedrooms
2 baths

46524 255th Avenue
Laporte MN 56461

Status: Active

Description:

Some say location is everything, and this location is for those who want Mother Nature to surround them with large pines, fruit trees, and nearby state land. This 3-bedroom, 2-bathroom home rests on 14.09 acres, and just 10 miles south of Bemidji MN! Within the boundaries of the 14.09 acres lies a 36'x48' 5" concrete-floored shop, partially insulated, along with a 24'x30' detached heated shop, and another lean-to for extra cover. This home boasts 2 large decks and a 4-season porch with a gas fireplace! With 2 bedrooms and 1 bath on the main floor and 1 bedroom, 1 bath in the basement, the home feels spacious and well put together. With floor heat, a gas-burning fireplace, and wood forced air, this well-insulated home gives you an abundance of options for heat. Reminder this property is on 2 separate adjoining parcels, of which there are other building sites to include power and a winding drive.

Additional Details:

Year Built	1982
Lot Acres	14.09
Lot Dimensions	640x1300
Garage Stalls	6
School District	31
Taxes	\$2,516
Taxes with Assessments	\$2,516
Tax Year	2024

Additional Features:

Basement: Daylight/Lookout Windows, Finished, Full **Fuel:** Electric, Wood **Garage:** 6 **Heat:** Baseboard, Forced Air, Fireplace(s), Radiant Floor, Wood Stove **Sewer:** Private Sewer, Septic System Compliant - Yes **Water:** Submersible - 4 Inch, Drilled, Well **Air Conditioning:** Window Unit(s)

Driving Directions:

From Paul and Babe Hwy 71 So 9.5 miles Left onto 47th st 1.5 miles right onto 255th Ave Home is on left



Listed By:
218 Real Estate

Affinity Real Estate Inc. participates in the Regional Multiple Listing Service of Minnesota, Inc Broker Reciprocity (sm) program, allowing us to display other broker's listings on our website. All properties are subject to prior sale, change or withdrawal.



Call Affinity Real Estate

218-237-3333

info@affinityrealestate.com



Affinity Real Estate - 600 Park Avenue South - Park Rapids MN 56470



website: www.AffinityRealEstate.com | email: info@affinityrealestate.com | office: 218-237-3333 | fax: 218-237-3377



\$349,800
 MLS 6521043 Residential
 46524 255th Avenue
 Laporte MN 56461



website: www.AffinityRealEstate.com | email: info@affinityrealestate.com | office: 218-237-3333 | fax: 218-237-3377

Affinity
REAL ESTATE INC

\$349,800
MLS 6521043 Residential
46524 255th Avenue
Laporte MN 56461



website: www.AffinityRealEstate.com | email: info@affinityrealestate.com | office: 218-237-3333 | fax: 218-237-3377



\$349,800
 MLS 6521043 Residential
 46524 255th Avenue
 Laporte MN 56461



website: www.AffinityRealEstate.com | email: info@affinityrealestate.com | office: 218-237-3333 | fax: 218-237-3377



\$349,800
MLS 6521043 Residential
46524 255th Avenue
Laporte MN 56461



website: www.AffinityRealEstate.com | email: info@affinityrealestate.com | office: 218-237-3333 | fax: 218-237-3377



\$349,800
 MLS 6521043 Residential
 46524 255th Avenue
 Laporte MN 56461



website: www.AffinityRealEstate.com | email: info@affinityrealestate.com | office: 218-237-3333 | fax: 218-237-3377



\$349,800
 MLS 6521043 Residential
 46524 255th Avenue
 Laporte MN 56461



website: www.AffinityRealEstate.com | email: info@affinityrealestate.com | office: 218-237-3333 | fax: 218-237-3377

Affinity
REAL ESTATE INC

\$349,800
MLS 6521043 Residential
46524 255th Avenue
Laporte MN 56461



website: www.AffinityRealEstate.com | email: info@affinityrealestate.com | office: 218-237-3333 | fax: 218-237-3377



\$349,800
 MLS 6521043 Residential
 46524 255th Avenue
 Laporte MN 56461

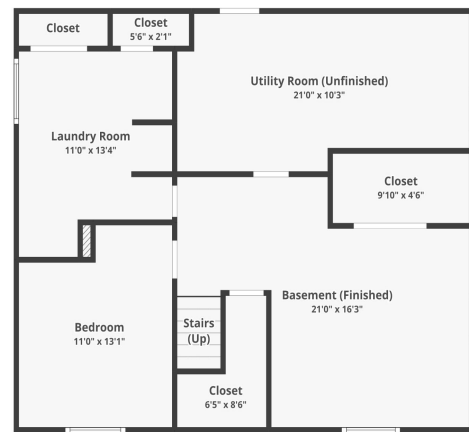

website: www.AffinityRealEstate.com | email: info@affinityrealestate.com | office: 218-237-3333 | fax: 218-237-3377



\$349,800
MLS 6521043 Residential
46524 255th Avenue
Laporte MN 56461