

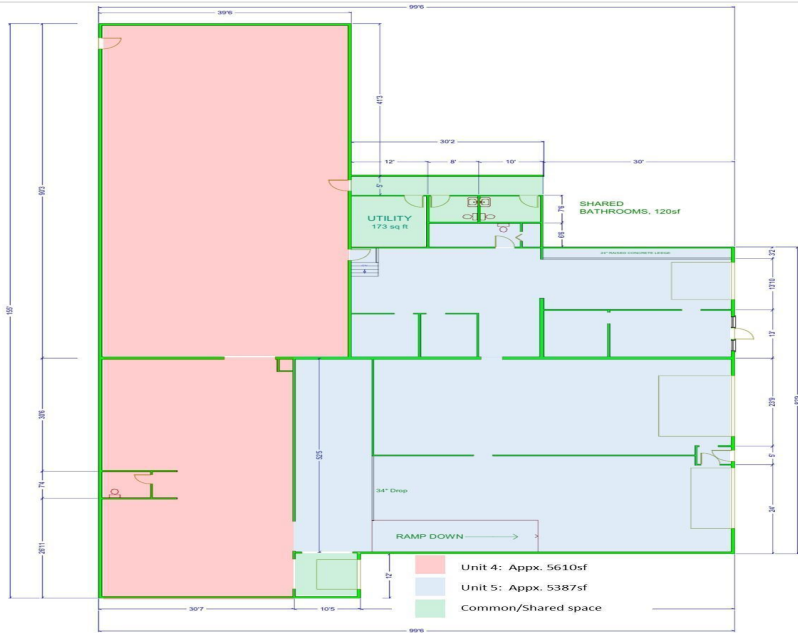

MLS 6543722 Commercial Sale

**\$7,900**



**Description:**

Over 11,000sf available on Paul Bunyan Drive NW with 3 garage/service doors, two @ 18w x 12h, one 10x10, off Delton. Wide variety of uses; appx 3600sf of office/retail fronting Paul Bunyan with another 2400sf of storage/warehouse behind. Loading dock at back of property. Space can be divided. Current lease expires September 30, 2024. Please respect existing business; direct all questions to listing Broker.

**Additional Details:**

Year Built	1960
Lot Acres	1.03
Lot Dimensions	230x325
Garage Stalls	3
School District	31
Taxes	\$24,508
Taxes with Assessments	\$24,508
Tax Year	2023

**Additional Features:**

**Fuel:** Natural Gas **Garage:** 3 **Heat:** Forced Air, Other **Sewer:** City Sewer/Connected **Water:** City Water/Connected **Air Conditioning:** Central Air

**Driving Directions:**

750 Paul Bunyan Drive NW; across from Chrysler Center.



Listed By:  
Lake-N-Woods Realty, Inc.

Affinity Real Estate Inc. participates in the Regional Multiple Listing Service of Minnesota, Inc Broker Reciprocity (sm) program, allowing us to display other broker's listings on our website. All properties are subject to prior sale, change or withdrawal.



Call Affinity Real Estate

**218-237-3333**

[info@affinityrealestate.com](mailto:info@affinityrealestate.com)



Affinity Real Estate - 600 Park Avenue South - Park Rapids MN 56470

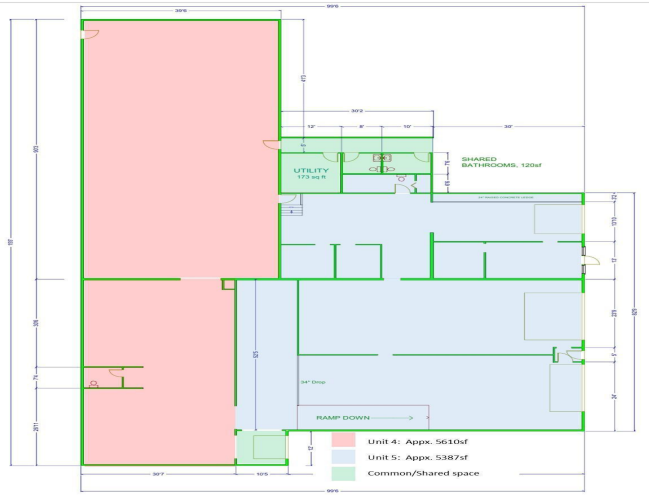

website: [www.AffinityRealEstate.com](http://www.AffinityRealEstate.com) | email: [info@affinityrealestate.com](mailto:info@affinityrealestate.com) | office: 218-237-3333 | fax:218-237-3377



**\$7,900**  
 MLS 6543722 Commercial  
 Sale  
 750 Paul Bunyan Drive  
 Bemidji MN 56601