



MLS 6552324 Lake Home

**\$599,900**

1,320 sq ft  
3 bedrooms  
2 baths

14408 Chippewa Loop  
Park Rapids MN 56470

Waterfront: Long Lake (29016100)

Status: Active

**Description:**

It's not too late! Perfect sand swimming frontage and level elevation on highly regarded Long Lake. The rare nature of the setting itself will leave you speechless. Towering pines and gorgeous waterfront views set the stage for this idyllic lake escape. Features a spotless, year round cabin spiked with a fun dose of nostalgia. Includes 1,320 finished sq ft on the main level with 3 bedrooms, 2 baths, vaulted ceilings, wood burning fireplace, laundry and a lakeside deck. The flooring in the living room and dining area are new. A partial basement sized at 350 sq ft +/- provides a perfect bonus for storage, storm shelter and easy access to utilities. There is a 20x22 garage and a backlot providing additional opportunities. Appliances, washer/dryer and the dock are included.

**Additional Details:**

Year Built	1940
Lot Acres	0.62
Lot Dimensions	75 x 366
Garage Stalls	1
School District	309
Taxes	\$2,860
Taxes with Assessments	\$3,070
Tax Year	2024

**Additional Features:**

**Basement:** Block, Partial, Unfinished **Fuel:** Propane, Wood **Garage:** 1 **Heat:** Forced Air, Fireplace(s) **Sewer:** Private Sewer, Tank with Drainage Field **Water:** Private, Sand Point, Well **Air Conditioning:** Central Air

**Driving Directions:**

From CR 6 / Hwy 34: Go South on CR 6 to a left on Chippewa Loop. Proceed to property on left.



Listed By:  
Affinity Real Estate Inc.

Affinity Real Estate Inc. participates in the Regional Multiple Listing Service of Minnesota, Inc Broker Reciprocity (sm) program, allowing us to display other broker's listings on our website. All properties are subject to prior sale, change or withdrawal.



**Call Affinity Real Estate**

**218-237-3333**

**info@affinityrealestate.com**



**Affinity Real Estate - 600 Park Avenue South - Park Rapids MN 56470**



website: [www.AffinityRealEstate.com](http://www.AffinityRealEstate.com) | email: [info@affinityrealestate.com](mailto:info@affinityrealestate.com) | office: 218-237-3333 | fax:218-237-3377



**\$599,900**  
MLS 6552324 Lake Home  
14408 Chippewa Loop  
Park Rapids MN 56470

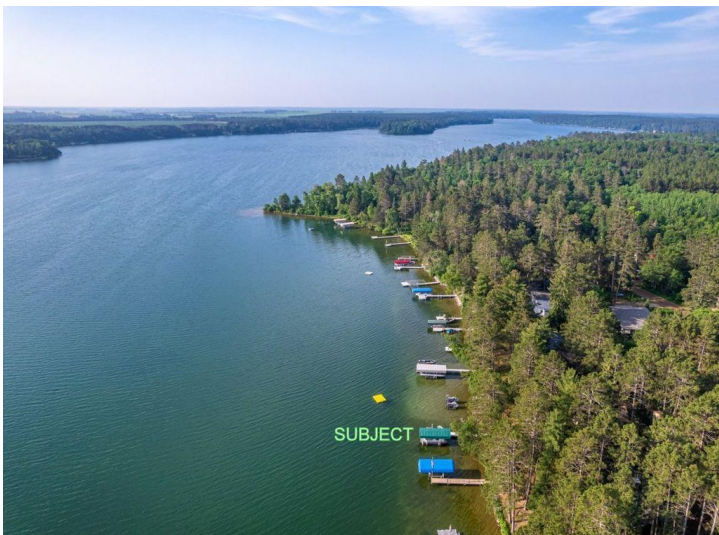

website: [www.AffinityRealEstate.com](http://www.AffinityRealEstate.com) | email: [info@affinityrealestate.com](mailto:info@affinityrealestate.com) | office: 218-237-3333 | fax:218-237-3377



**\$599,900**  
MLS 6552324 Lake Home  
14408 Chippewa Loop  
Park Rapids MN 56470



website: [www.AffinityRealEstate.com](http://www.AffinityRealEstate.com) | email: [info@affinityrealestate.com](mailto:info@affinityrealestate.com) | office: 218-237-3333 | fax:218-237-3377

**Affinity**  
REAL ESTATE INC

**\$599,900**  
MLS 6552324 Lake Home  
14408 Chippewa Loop  
Park Rapids MN 56470



website: [www.AffinityRealEstate.com](http://www.AffinityRealEstate.com) | email: [info@affinityrealestate.com](mailto:info@affinityrealestate.com) | office: 218-237-3333 | fax:218-237-3377



**\$599,900**  
MLS 6552324 Lake Home  
14408 Chippewa Loop  
Park Rapids MN 56470



website: [www.AffinityRealEstate.com](http://www.AffinityRealEstate.com) | email: [info@affinityrealestate.com](mailto:info@affinityrealestate.com) | office: 218-237-3333 | fax: 218-237-3377

**Affinity**  
REAL ESTATE INC

**\$599,900**  
MLS 6552324 Lake Home  
14408 Chippewa Loop  
Park Rapids MN 56470



website: [www.AffinityRealEstate.com](http://www.AffinityRealEstate.com) | email: [info@affinityrealestate.com](mailto:info@affinityrealestate.com) | office: 218-237-3333 | fax: 218-237-3377



**\$599,900**  
MLS 6552324 Lake Home  
14408 Chippewa Loop  
Park Rapids MN 56470