



MLS 6554432 Lake Land

**\$135,000**

**Description:**

Discover the ultimate lakeside living experience with this exceptional lakefront lot on Long Lake in Ottertail County. Perfectly situated to capture stunning sunsets, this prime piece of real estate offers endless possibilities for your dream lake home or a serene RV getaway. Enjoy panoramic views of Long Lake from your future home or RV, with ample space for construction and landscaping. Located in Ottertail County, known for its pristine lakes and outdoor recreational opportunities, this property provides easy access to fishing, boating, and other water activities. Whether you're looking to escape the hustle and bustle with a cozy RV setup or build a custom lakefront home, this lot offers endless possibilities. Embrace the beauty of Ottertail County and start living your dream lake life today.

**Additional Details:**

Lot Acres	0.44
Lot Dimensions	irr
School District	549
Taxes	\$648
Taxes with Assessments	\$648
Tax Year	2023

**Additional Features:**

**Driving Directions:**

ottertail to long lake



Listed By:  
Century 21 FM Realty

Affinity Real Estate Inc. participates in the Regional Multiple Listing Service of Minnesota, Inc Broker Reciprocity (sm) program, allowing us to display other broker's listings on our website. All properties are subject to prior sale, change or withdrawal.



**Call Affinity Real Estate**

**218-237-3333**

**info@affinityrealestate.com**



**Affinity Real Estate - 600 Park Avenue South - Park Rapids MN 56470**

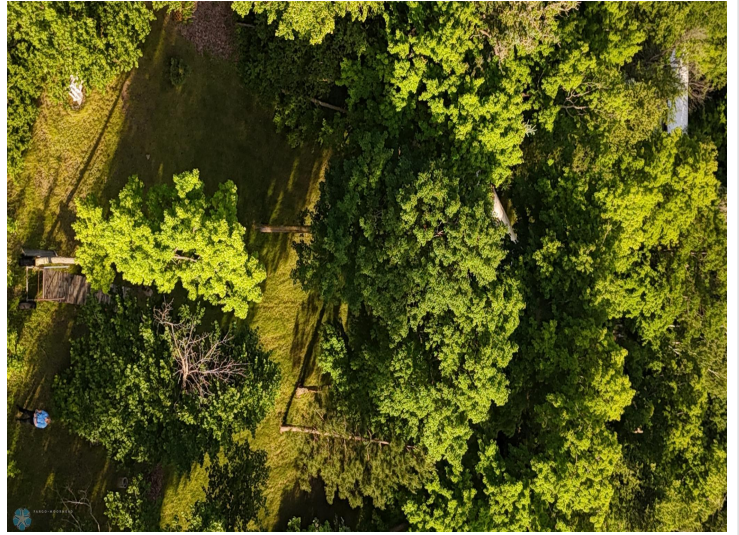

website: [www.AffinityRealEstate.com](http://www.AffinityRealEstate.com) | email: [info@affinityrealestate.com](mailto:info@affinityrealestate.com) | office: 218-237-3333 | fax:218-237-3377



**\$135,000**  
MLS 6554432 Lake Land  
41969 Sugar Maple Drive  
Ottertail MN 56571