



MLS 6564104 Lake Land

\$79,000

Description:

BRANCH CREEK-OFFERING DIRECT ACCESS TO DETROIT LAKE: Ideal location to build what fits your lifestyle. These spacious lots are framed by the Pelican River (offering direct access to Detroit Lake), Dunton Locks Park (now home to one of world famous Thomas Dambo's giant trolls) and the ever popular paved walking/bike path that meanders along the river to connect Detroit Lake and Sallie. With quick access to downtown Detroit Lakes, enough room to build a matching out building and PAVED roads, nothing can compare to this development. Bring your plans, builder and maybe even a boat! Currently we have boat slips available to purchase for an additional \$95,000. Excellent opportunity. Additional lots available

Additional Details:

Lot Acres	0.92
Lot Dimensions	Irr
School District	22
Taxes	\$16
Taxes with Assessments	\$36
Tax Year	2024

Additional Features:

Driving Directions:

From Detroit Lakes, Hwy 59 South, just before Village of Riverview Campground. On the East side of 59



Listed By:
RE/MAX LAKES REGION

Affinity Real Estate Inc. participates in the Regional Multiple Listing Service of Minnesota, Inc Broker Reciprocity (sm) program, allowing us to display other broker's listings on our website. All properties are subject to prior sale, change or withdrawal.



Call Affinity Real Estate

218-237-3333

info@affinityrealestate.com



Affinity Real Estate - 600 Park Avenue South - Park Rapids MN 56470

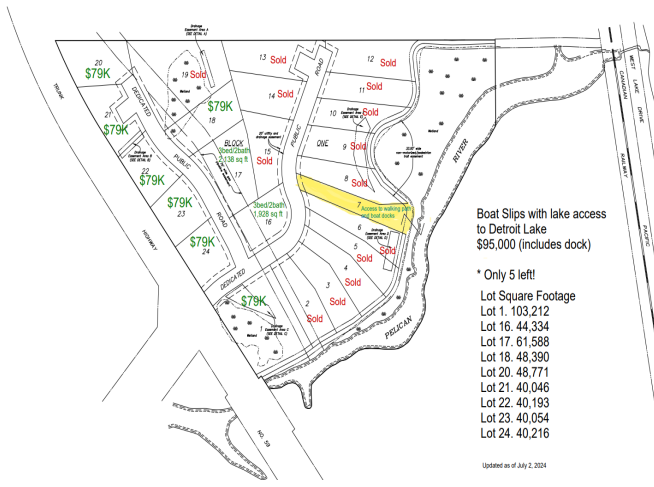

website: www.AffinityRealEstate.com | email: info@affinityrealestate.com | office: 218-237-3333 | fax:218-237-3377



\$79,000
 MLS 6564104 Lake Land
 21 Branch Creek Road
 Detroit Lakes MN 56501



website: www.AffinityRealEstate.com | email: info@affinityrealestate.com | office: 218-237-3333 | fax:218-237-3377



\$79,000
MLS 6564104 Lake Land
21 Branch Creek Road
Detroit Lakes MN 56501



website: www.AffinityRealEstate.com | email: info@affinityrealestate.com | office: 218-237-3333 | fax:218-237-3377



\$79,000

MLS 6564104 Lake Land
21 Branch Creek Road
Detroit Lakes MN 56501