



MLS 6565215 Lake Home

\$795,000

2,056 sq ft
2 bedrooms
3 baths

424 Glenmar Drive
Longville MN 56655

Waterfront: Woman (main lake)

Status: Active

Description:

Nestled on the shores of beautiful Woman Lake, part of a scenic chain of lakes, this welcoming home offers two bedrooms, three bathrooms, and plenty of extra sleeping space for guests. The large porch, adorned with cedar and arched ceilings, provides a separate, inviting space to relax and enjoy the lake views and sounds. The living room and dining room also feature elegant arched ceilings and a stunning wall of windows, creating an open, airy feel that showcases the lake. A wood-burning fireplace also takes the chill off the Minnesota winter days. The dining room and kitchen, complete with a peninsula for casual meals, make entertaining a breeze. The lower level is ideal for movies and games, and a walkout leads directly to the lake. Step outside onto the expansive deck that spans the entire lakeside. It's perfect for enjoying the panoramic lake views and hosting family gatherings in the spacious, flat yard. The property includes a convenient asphalt driveway and a 2+ car garage. An additional deck graces the entryway, providing a welcoming outdoor space, while a handy shed nearby offers extra storage. Woman Lake is part of a chain of lakes that includes Girl Lake and Child Lake, offering plenty of recreational activities to enjoy year-round.

Additional Details:

Year Built	1988
Lot Acres	0.54
Lot Dimensions	100x231x102x223
Garage Stalls	2
School District	118
Taxes	\$2,448
Taxes with Assessments	\$2,514
Tax Year	2024

Additional Features:

Basement: Block, Walkout, Wood **Fuel:** Electric **Garage:** 2 **Heat:** Baseboard **Sewer:** Tank with Drainage Field **Water:** Submersible - 4 Inch, Well
Air Conditioning: None

Driving Directions:

From Longville - Head S on Hwy 84 for 1mile. Turn right onto Glenmar Dr NE for approximately 2 miles to the subject property.



Listed By:
Heartland Real Estate

Affinity Real Estate Inc. participates in the Regional Multiple Listing Service of Minnesota, Inc Broker Reciprocity (sm) program, allowing us to display other broker's listings on our website. All properties are subject to prior sale, change or withdrawal.



Call Affinity Real Estate

218-237-3333

info@affinityrealestate.com



Affinity Real Estate - 600 Park Avenue South - Park Rapids MN 56470



website: www.AffinityRealEstate.com | email: info@affinityrealestate.com | office: 218-237-3333 | fax: 218-237-3377



\$795,000
 MLS 6565215 Lake Home
 424 Glenmar Drive
 Longville MN 56655



website: www.AffinityRealEstate.com | email: info@affinityrealestate.com | office: 218-237-3333 | fax: 218-237-3377



\$795,000
 MLS 6565215 Lake Home
 424 Glenmar Drive
 Longville MN 56655



website: www.AffinityRealEstate.com | email: info@affinityrealestate.com | office: 218-237-3333 | fax: 218-237-3377



\$795,000
 MLS 6565215 Lake Home
 424 Glenmar Drive
 Longville MN 56655



website: www.AffinityRealEstate.com | email: info@affinityrealestate.com | office: 218-237-3333 | fax: 218-237-3377

Affinity
REAL ESTATE INC

\$795,000
MLS 6565215 Lake Home
424 Glenmar Drive
Longville MN 56655



website: www.AffinityRealEstate.com | email: info@affinityrealestate.com | office: 218-237-3333 | fax: 218-237-3377



\$795,000
 MLS 6565215 Lake Home
 424 Glenmar Drive
 Longville MN 56655



website: www.AffinityRealEstate.com | email: info@affinityrealestate.com | office: 218-237-3333 | fax: 218-237-3377

Affinity
REAL ESTATE INC

\$795,000
MLS 6565215 Lake Home
424 Glenmar Drive
Longville MN 56655

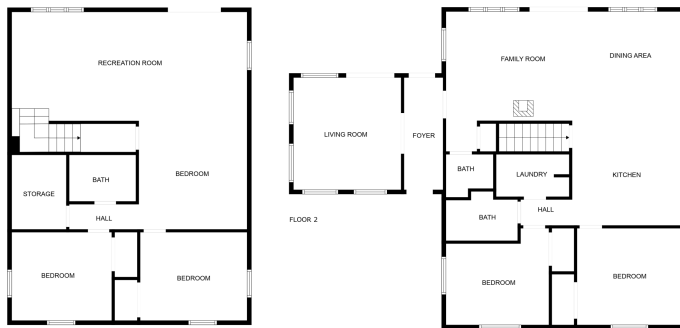

FLOOR PLAN CREATED BY CUBICASA APP. MEASUREMENTS DEEMED HIGHLY RELIABLE BUT NOT GUARANTEED.



website: www.AffinityRealEstate.com | email: info@affinityrealestate.com | office: 218-237-3333 | fax: 218-237-3377

Affinity
REAL ESTATE INC

\$795,000
MLS 6565215 Lake Home
424 Glenmar Drive
Longville MN 56655



website: www.AffinityRealEstate.com | email: info@affinityrealestate.com | office: 218-237-3333 | fax:218-237-3377



\$795,000

MLS 6565215 Lake Home
424 Glenmar Drive
Longville MN 56655