



MLS 6577814 Commercial

**\$4,959**

750 Paul Bunyan Drive  
Bemidji MN 56601

Status: Active

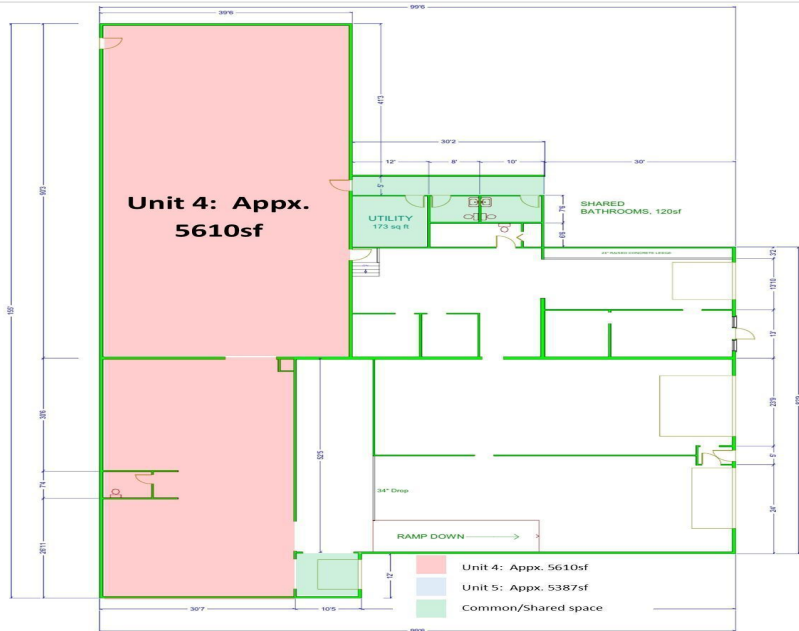

**Description:**

5,610sf available with frontage on Paul Bunyan Drive NW. Approximately 3500sf office/retail space with 3000sf+ warehouse/storage in back with shared (secure) loading dock. Additional 5,387sf available. Current lease expires September 30, 2024. Please respect existing business; direct all questions to listing Broker.

**Additional Details:**

Year Built	1960
Lot Acres	1.03
Lot Dimensions	230x325
School District	31
Taxes	\$24,508
Taxes with Assessments	\$24,508
Tax Year	2023

**Additional Features:**

**Fuel:** Natural Gas **Heat:** Forced Air, Other **Sewer:** City Sewer/Connected **Water:** City Water/Connected **Air Conditioning:** Central Air

**Driving Directions:**

750 Paul Bunyan Drive NW; across from Chrysler Center.



Listed By:  
Lake-N-Woods Realty, Inc.

Affinity Real Estate Inc. participates in the Regional Multiple Listing Service of Minnesota, Inc Broker Reciprocity (sm) program, allowing us to display other broker's listings on our website. All properties are subject to prior sale, change or withdrawal.



Call Affinity Real Estate

**218-237-3333**

[info@affinityrealestate.com](mailto:info@affinityrealestate.com)



Affinity Real Estate - 600 Park Avenue South - Park Rapids MN 56470

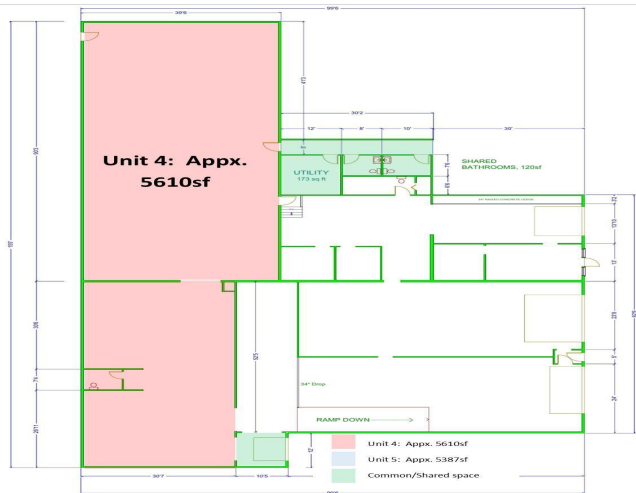

website: [www.AffinityRealEstate.com](http://www.AffinityRealEstate.com) | email: [info@affinityrealestate.com](mailto:info@affinityrealestate.com) | office: 218-237-3333 | fax: 218-237-3377



**\$4,959**

MLS 6577814 Commercial  
750 Paul Bunyan Drive  
Bemidji MN 56601