

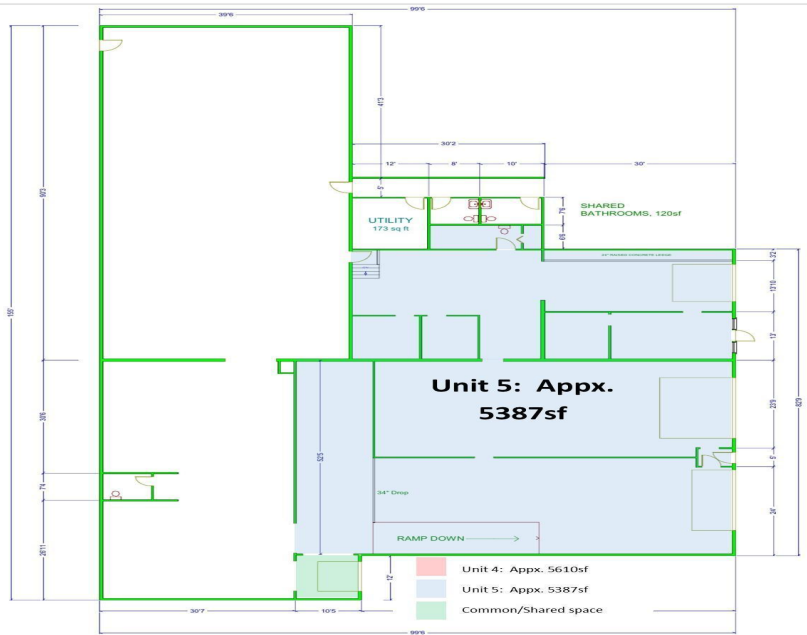

MLS 6577829 Commercial Sale

\$4,062



Description:

Over 5,300sf available just off Paul Bunyan Drive NW with facing on Delton Avenue NW across from Country Kitchen. Currently used as automotive service, space has three garage/service doors: two @ 18w x 12h, one 10x10 and a shared (secure) loading dock. Additional 5,610 sf available with retail and warehouse/storage behind.

Current lease expires September 30, 2024. Please respect existing business; direct all questions to listing Broker.

Additional Details:

Year Built	1960
Lot Acres	1.03
Lot Dimensions	230x325
Garage Stalls	3
School District	31
Taxes	\$24,508
Taxes with Assessments	\$24,508
Tax Year	2023

Additional Features:

Fuel: Natural Gas **Garage:** 3 **Heat:** Forced Air, Other **Sewer:** City Sewer/Connected **Water:** City Water/Connected **Air Conditioning:** Central Air

Driving Directions:

750 Paul Bunyan Drive NW; space is across the street from Country Kitchen with Delton Avenue facing.



Listed By:
Lake-N-Woods Realty, Inc.

Affinity Real Estate Inc. participates in the Regional Multiple Listing Service of Minnesota, Inc Broker Reciprocity (sm) program, allowing us to display other broker's listings on our website. All properties are subject to prior sale, change or withdrawal.



Call Affinity Real Estate

218-237-3333

info@affinityrealestate.com



Affinity Real Estate - 600 Park Avenue South - Park Rapids MN 56470

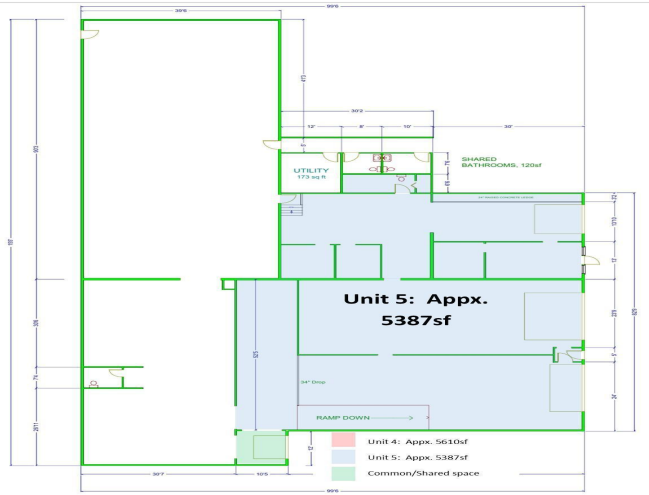

website: www.AffinityRealEstate.com | email: info@affinityrealestate.com | office: 218-237-3333 | fax:218-237-3377



\$4,062
 MLS 6577829 Commercial
 Sale
 750 Paul Bunyan Drive
 Bemidji MN 56601