



MLS 6578690 Land

\$265,000

31.9 Acres
Raw Land

TBD River Dr
Frazee MN 56544

Status: Active

Description:

Located just North of the Frazee ballfield on the way to Wannigan Park is this 31+ acre parcel. Currently used as agricultural land, this parcel has immense possibilities. Preliminary plat available.

Additional Details:

Lot Acres	31.9
Lot Dimensions	258x1995
School District	23
Taxes	\$258
Taxes with Assessments	\$250
Tax Year	2024

Additional Features:

Driving Directions:

From Frazee head out on County 29 then take the first right. Follow the troll sign. Property will be on the left across the street from the ball field.



Listed By:
Counselor Realty of Detroit Lakes

Affinity Real Estate Inc. participates in the Regional Multiple Listing Service of Minnesota, Inc Broker Reciprocity (sm) program, allowing us to display other broker's listings on our website. All properties are subject to prior sale, change or withdrawal.



Call Affinity Real Estate

218-237-3333

info@affinityrealestate.com



Affinity Real Estate - 600 Park Avenue South - Park Rapids MN 56470

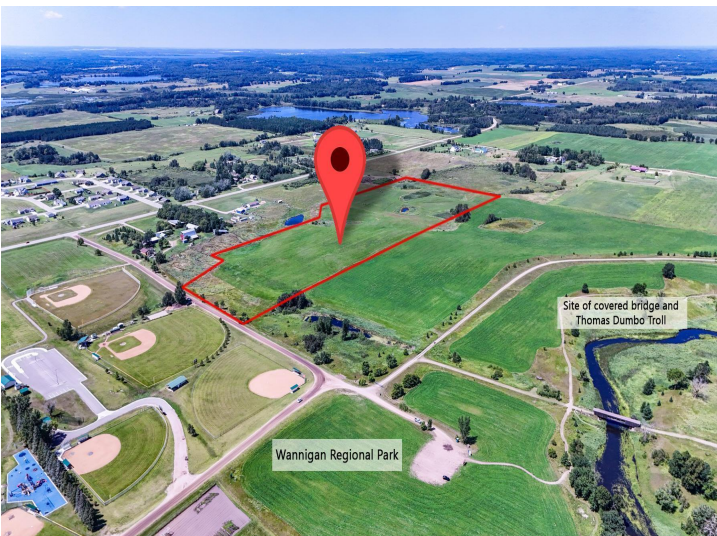

website: www.AffinityRealEstate.com | email: info@affinityrealestate.com | office: 218-237-3333 | fax:218-237-3377



\$265,000
MLS 6578690 Land
TBD River Dr
Frazee MN 56544