



MLS 6599468 Lake Home

\$234,900

936 sq ft
1 bedrooms
1 baths

25340 County 2
Nevis MN 56467

Waterfront: Middle Crooked

Status: Active

Description:

The ultimate recreational hotspot! This Middle Crooked Lake property features 7+ acres, 400ft of frontage (main body), 600ft (bay), total privacy, stunning tree cover and more! Includes a 936 sq ft shouse with newer septic and a drilled well. Approximately half has been finished into a 1 bedroom apartment that can sleep 6 while the other half is insulated garage space with a floor drain. A covered porch with patio and firepit area tie it together perfectly! A bunkhouse waiting for interior finishing touches is also included. NO restrictive covenants and there is plenty of density should you ever wish to build a home or an additional garage/shop. Sits on a county maintained blacktop road just a stones throw to the Paul Bunyan Forest. You will never need to trailer for fun as your gateway to the trails are right here!

Additional Details:

Year Built	1992
Lot Acres	7.11
Lot Dimensions	400 x irr
Garage Stalls	1
School District	308
Taxes	\$608
Taxes with Assessments	\$608
Tax Year	2024

Additional Features:

Basement: Slab **Fuel:** Electric **Garage:** 1 **Heat:** Other **Sewer:** Private Sewer, Tank with Drainage Field **Water:** Drilled, Private, Well **Air Conditioning:** Window Unit(s)

Driving Directions:

From Nevis: Go North on County 2 just past Breezy Pines Resort to property on right.



Listed By:
Affinity Real Estate Inc.

Affinity Real Estate Inc. participates in the Regional Multiple Listing Service of Minnesota, Inc Broker Reciprocity (sm) program, allowing us to display other broker's listings on our website. All properties are subject to prior sale, change or withdrawal.



Call Affinity Real Estate

218-237-3333

info@affinityrealestate.com



Affinity Real Estate - 600 Park Avenue South - Park Rapids MN 56470



website: www.AffinityRealEstate.com | email: info@affinityrealestate.com | office: 218-237-3333 | fax:218-237-3377



\$234,900
MLS 6599468 Lake Home
25340 County 2
Nevis MN 56467



SCENIC WALKING / ATV PATH TO LAKE. 3 MINUTES BY FOOT. 1 MINUTE BY ATV.



website: www.AffinityRealEstate.com | email: info@affinityrealestate.com | office: 218-237-3333 | fax:218-237-3377



\$234,900
MLS 6599468 Lake Home
25340 County 2
Nevis MN 56467



website: www.AffinityRealEstate.com | email: info@affinityrealestate.com | office: 218-237-3333 | fax:218-237-3377

Affinity
REAL ESTATE INC

\$234,900
MLS 6599468 Lake Home
25340 County 2
Nevis MN 56467

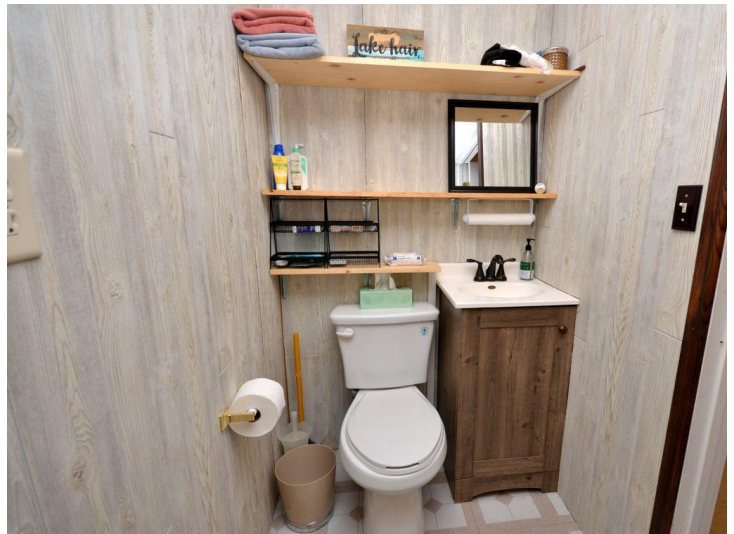

website: www.AffinityRealEstate.com | email: info@affinityrealestate.com | office: 218-237-3333 | fax: 218-237-3377

Affinity
REAL ESTATE INC

\$234,900
MLS 6599468 Lake Home
25340 County 2
Nevis MN 56467

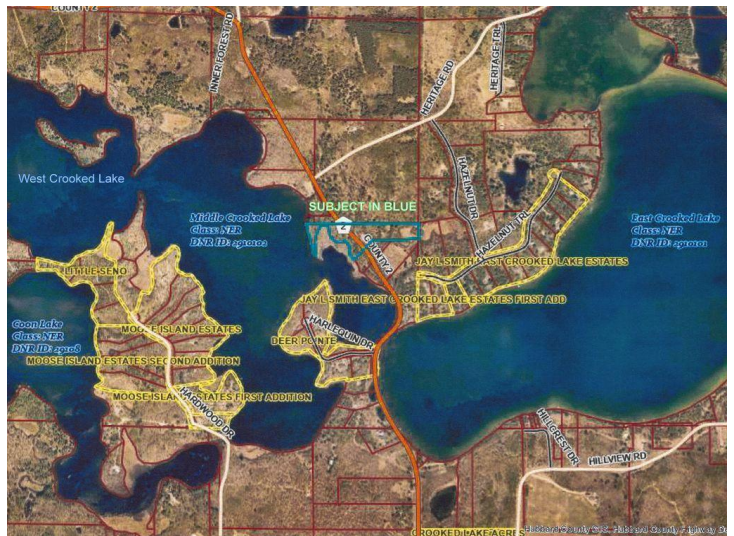

website: www.AffinityRealEstate.com | email: info@affinityrealestate.com | office: 218-237-3333 | fax: 218-237-3377



\$234,900
 MLS 6599468 Lake Home
 25340 County 2
 Nevis MN 56467