



MLS 6633317 Residential

\$99,500

1,848 sq ft
3 bedrooms
2 baths

5330 King Richard Avenue
Motley MN 56466

Status: Active

Description:

This 3-bedroom, 2-bath home offers 1,845 sq. ft. of living space, featuring both a living room and a family room, along with an enclosed 3-season porch for added versatility. The property includes an oversized 32x42 garage, a deck, and a guest cabin awaiting your finishing touches. As part of the Wilderness Park Association, residents enjoy access to a range of amenities, including showers, restrooms, a clubhouse with an in-ground swimming pool, and lake access, making it an excellent opportunity for comfortable living and recreation.

Additional Details:

Year Built	1990
Lot Acres	0.94
Lot Dimensions	.94 acres
Garage Stalls	2
School District	2170
Taxes	\$970
Taxes with Assessments	\$1,036
Tax Year	2024

Additional Features:

Basement: Crawl Space **Fuel:** Propane **Garage:** 2 **Heat:** Forced Air **Sewer:** Tank with Drainage Field **Water:** Well **Air Conditioning:** None

Driving Directions:

From Leader: East on 76th St SW for 3.4 miles. Continue straight on King Richard Ave SW to property on Right



Listed By:
Gallery of Homes

Affinity Real Estate Inc. participates in the Regional Multiple Listing Service of Minnesota, Inc Broker Reciprocity (sm) program, allowing us to display other broker's listings on our website. All properties are subject to prior sale, change or withdrawal.



Call Affinity Real Estate

218-237-3333

info@affinityrealestate.com



Affinity Real Estate - 600 Park Avenue South - Park Rapids MN 56470



website: www.AffinityRealEstate.com | email: info@affinityrealestate.com | office: 218-237-3333 | fax:218-237-3377



\$99,500
MLS 6633317 Residential
5330 King Richard Avenue
Motley MN 56466



website: www.AffinityRealEstate.com | email: info@affinityrealestate.com | office: 218-237-3333 | fax:218-237-3377



\$99,500
MLS 6633317 Residential
5330 King Richard Avenue
Motley MN 56466



website: www.AffinityRealEstate.com | email: info@affinityrealestate.com | office: 218-237-3333 | fax:218-237-3377

Affinity
REAL ESTATE INC

\$99,500
MLS 6633317 Residential
5330 King Richard Avenue
Motley MN 56466



website: www.AffinityRealEstate.com | email: info@affinityrealestate.com | office: 218-237-3333 | fax:218-237-3377



\$99,500
MLS 6633317 Residential
5330 King Richard Avenue
Motley MN 56466



website: www.AffinityRealEstate.com | email: info@affinityrealestate.com | office: 218-237-3333 | fax:218-237-3377



\$99,500
MLS 6633317 Residential
5330 King Richard Avenue
Motley MN 56466

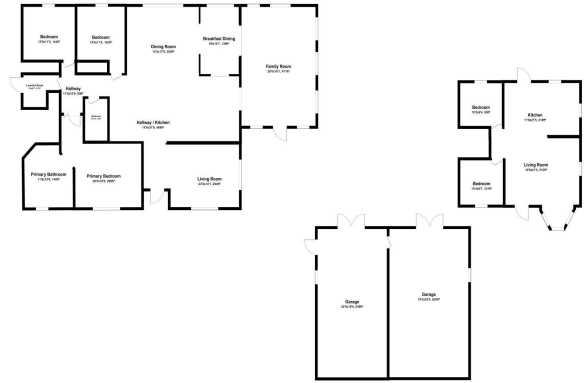

For illustration purposes only. Not to scale.

Ground Floor

website: www.AffinityRealEstate.com | email: info@affinityrealestate.com | office: 218-237-3333 | fax:218-237-3377



\$99,500
MLS 6633317 Residential
5330 King Richard Avenue
Motley MN 56466