

BUTTERNUT ROAD

17 lots available



MLS 6633446 Residential

\$529,900

2,536 sq ft
4 bedrooms
3 baths

xxx Butternut Road
Brainerd MN 56401

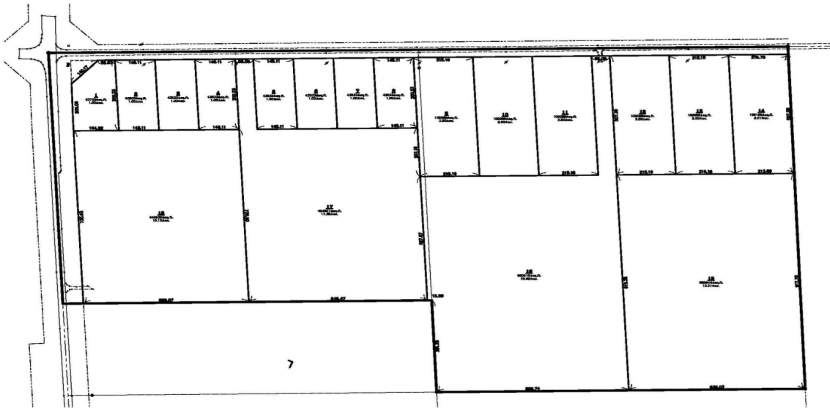

WELCOME TO OUR EXCITING NEW DEVELOPMENT, CONVENIENTLY LOCATED WITHIN WALKING DISTANCE OF THE DENNIS DRUMMOND WINE CO WINERY, AS WELL AS SCENIC WALKING TRAILS AND 311 ACRES OF PUBLIC HUNTING LAND RIGHT ACROSS THE STREET!

Status: Active

Description:

Welcome to our exciting new development, conveniently located within walking distance of the Dennis Drummond Wine Co winery, as well as scenic walking trails and 311 acres of public hunting land right across the street! Construction is set to begin soon. This stunning new custom home boasts four bedrooms and three bathrooms, along with impressive upgrades such as granite countertops throughout, a cozy fireplace, lockers, and an irrigation system. With a spacious three-car garage, there's plenty of room for all your toys! The location is ideal, offering easy access to schools, restaurants, fishing, shopping, and everything the Lakes area has to offer. Additional floor plans, developments, and lots are also available!

Additional Details:

Year Built	2025
Lot Acres	1
Lot Dimensions	150x300
Garage Stalls	3
School District	181
Taxes	(unreported)
Taxes with Assessments	(unreported)
Tax Year	2025

Additional Features:

Basement: Unfinished **Fuel:** Natural Gas **Garage:** 3 **Heat:** Forced Air, Fireplace(s) **Sewer:** Mound Septic, Private Sewer, Tank with Drainage Field **Water:** Submersible - 4 Inch, Drilled, Well **Air Conditioning:** Central Air

Driving Directions:

Take Hwy 210 East to Hwy 25 and continue straight. Take a left onto Butternut Road, property will be on the right.



Listed By:
Counselor Realty Brainerd Lakes

Affinity Real Estate Inc. participates in the Regional Multiple Listing Service of Minnesota, Inc Broker Reciprocity (sm) program, allowing us to display other broker's listings on our website. All properties are subject to prior sale, change or withdrawal.



Call Affinity Real Estate

218-237-3333

info@affinityrealestate.com



Affinity Real Estate - 600 Park Avenue South - Park Rapids MN 56470

BUTTERNUT ROAD

17 lots available

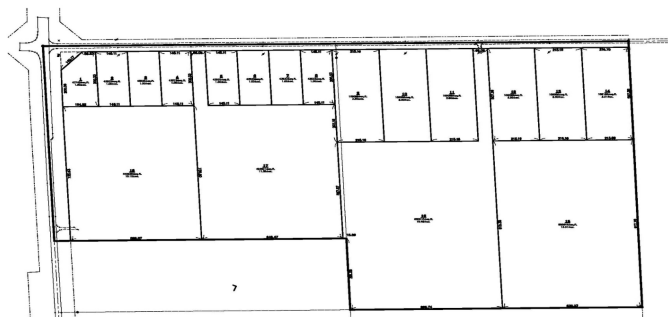

WELCOME TO OUR EXCITING NEW DEVELOPMENT, CONVENIENTLY LOCATED WITHIN WALKING DISTANCE OF THE DENNIS DRUMMOND WINE CO WINERY, AS WELL AS SCENIC WALKING TRAILS AND 311 ACRES OF PUBLIC HUNTING LAND RIGHT ACROSS THE STREET!



website: www.AffinityRealEstate.com | email: info@affinityrealestate.com | office: 218-237-3333 | fax: 218-237-3377

Affinity
REAL ESTATE INC

\$529,900

MLS 6633446 Residential
xxx Butternut Road
Brainerd MN 56401



website: www.AffinityRealEstate.com | email: info@affinityrealestate.com | office: 218-237-3333 | fax: 218-237-3377



\$529,900
MLS 6633446 Residential
xxx Butternut Road
Brainerd MN 56401



website: www.AffinityRealEstate.com | email: info@affinityrealestate.com | office: 218-237-3333 | fax: 218-237-3377



\$529,900
MLS 6633446 Residential
xxx Butternut Road
Brainerd MN 56401



website: www.AffinityRealEstate.com | email: info@affinityrealestate.com | office: 218-237-3333 | fax: 218-237-3377



\$529,900
MLS 6633446 Residential
xxx Butternut Road
Brainerd MN 56401



website: www.AffinityRealEstate.com | email: info@affinityrealestate.com | office: 218-237-3333 | fax: 218-237-3377



\$529,900
 MLS 6633446 Residential
 xxx Butternut Road
 Brainerd MN 56401



website: www.AffinityRealEstate.com | email: info@affinityrealestate.com | office: 218-237-3333 | fax: 218-237-3377



\$529,900
MLS 6633446 Residential
xxx Butternut Road
Brainerd MN 56401