



MLS 6672128 Lake Home

**\$439,900**

864 sq ft  
2 bedrooms  
1 baths

7789 Partridge Point Trail  
Longville MN 56655

Waterfront: Leech

Status: Pending

#### Description:

Welcome to your two-bedroom lakeside retreat on beautiful Leech Lake, featuring over 112,000 acres of exceptional trophy fishing opportunities as well as endless recreational fun. Just steps from the hard-bottom shoreline, you'll drift off each night to the soothing sounds of gentle waves and the calls of wildlife. As you enter, you're greeted by a delightful interior adorned with knotty pine walls and ceilings, creating a warm, inviting atmosphere that feels like home. The thoughtfully designed kitchen features a raised ceiling, an island for effortless meal preparation, and ample space for a dining table, perfect for intimate gatherings and shared memories. Large windows offer breathtaking lake views, while a door opens to a deck that invites you to savor spectacular sunsets over the water. Both bedrooms include a pass-through door, enhancing the continuity of space and adding a unique charm. Beautiful wood floors elevate the home's aesthetic, and a circular driveway ensures convenience and ample parking. With 94 feet of pristine shoreline, a handy storage shed, and endless opportunities for outdoor adventures—be it ice fishing, snowmobiling, hunting, or exploring vast lake landscapes—this property is your gateway to living the ultimate Minnesota lake country lifestyle.

#### Additional Details:

Year Built	1995
Lot Acres	0.5
Lot Dimensions	94x196x90x224
School District	118
Taxes	\$1,928
Taxes with Assessments	\$1,994
Tax Year	2025

#### Additional Features:

**Fuel:** Electric **Heat:** Baseboard

#### Driving Directions:

From Longville - Head N on Hwy 84 for 4.6 miles. Turn left onto State Hwy 200 for 3.5 miles. Turn right onto Co Rd 39 NE for 2.2 miles. Turn left onto Partridge Dr NE, slight left onto Partridge Point Trl NE to the subject property.



Listed By:  
Heartland Real Estate

Affinity Real Estate Inc. participates in the Regional Multiple Listing Service of Minnesota, Inc Broker Reciprocity (sm) program, allowing us to display other broker's listings on our website. All properties are subject to prior sale, change or withdrawal.



**Call Affinity Real Estate**

**218-237-3333**

**info@affinityrealestate.com**



**Affinity Real Estate - 600 Park Avenue South - Park Rapids MN 56470**



website: [www.AffinityRealEstate.com](http://www.AffinityRealEstate.com) | email: [info@affinityrealestate.com](mailto:info@affinityrealestate.com) | office: 218-237-3333 | fax: 218-237-3377

**Affinity**  
REAL ESTATE INC

**\$439,900**  
MLS 6672128 Lake Home  
7789 Partridge Point Trail  
Longville MN 56655



website: [www.AffinityRealEstate.com](http://www.AffinityRealEstate.com) | email: [info@affinityrealestate.com](mailto:info@affinityrealestate.com) | office: 218-237-3333 | fax: 218-237-3377



**\$439,900**  
MLS 6672128 Lake Home  
7789 Partridge Point Trail  
Longville MN 56655



website: [www.AffinityRealEstate.com](http://www.AffinityRealEstate.com) | email: [info@affinityrealestate.com](mailto:info@affinityrealestate.com) | office: 218-237-3333 | fax: 218-237-3377



**\$439,900**

MLS 6672128 Lake Home  
7789 Partridge Point Trail  
Longville MN 56655



website: [www.AffinityRealEstate.com](http://www.AffinityRealEstate.com) | email: [info@affinityrealestate.com](mailto:info@affinityrealestate.com) | office: 218-237-3333 | fax: 218-237-3377

**Affinity**  
REAL ESTATE INC

**\$439,900**  
MLS 6672128 Lake Home  
7789 Partridge Point Trail  
Longville MN 56655

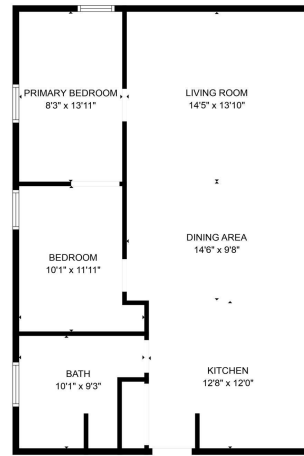

FLOOR PLAN CREATED BY CURBCASA APP. MEASUREMENTS DEEMED HIGHLY RELIABLE BUT NOT GUARANTEED.

website: [www.AffinityRealEstate.com](http://www.AffinityRealEstate.com) | email: [info@affinityrealestate.com](mailto:info@affinityrealestate.com) | office: 218-237-3333 | fax: 218-237-3377



**\$439,900**

MLS 6672128 Lake Home  
7789 Partridge Point Trail  
Longville MN 56655