



MLS 6676831 Residential

**\$249,900**

2,900 sq ft  
3 bedrooms  
3 baths

1807 Beltrami Court  
Bemidji MN 56601

Status: Active

**Description:**

This 3 bedroom home is a must see. Walking distance to Bemidji State University and with in minutes of any needs you can think of!! When you tour this home you will find plenty of storage, detached double stall garage, finished sun room with cooking space, huge deck in the back yard, all on a cul-de-sac. The home has 3 bedrooms on the main floor, with 2 bathrooms, 2 living rooms an open concept kitchen and fire place to boot. As you go through the basement you will find a large gathering space, and plenty of storage, and your own private SAUNA!!

**Additional Details:**

Year Built	1958
Lot Acres	0.15
Lot Dimensions	60x105
Garage Stalls	2
School District	31
Taxes	\$2,856
Taxes with Assessments	\$2,856
Tax Year	2024

**Additional Features:**

**Basement:** Finished **Fuel:** Natural Gas **Garage:** 2 **Heat:** Forced Air, Fireplace(s) **Sewer:** City Sewer/Connected **Water:** City Water/Connected  
**Air Conditioning:** Central Air

**Driving Directions:**

Bemidji Ave to 18th St to Beltrami CT



Listed By:  
218 Real Estate

Affinity Real Estate Inc. participates in the Regional Multiple Listing Service of Minnesota, Inc Broker Reciprocity (sm) program, allowing us to display other broker's listings on our website. All properties are subject to prior sale, change or withdrawal.



Call Affinity Real Estate

**218-237-3333**

[info@affinityrealestate.com](mailto:info@affinityrealestate.com)



Affinity Real Estate - 600 Park Avenue South - Park Rapids MN 56470





website: [www.AffinityRealEstate.com](http://www.AffinityRealEstate.com) | email: [info@affinityrealestate.com](mailto:info@affinityrealestate.com) | office: 218-237-3333 | fax:218-237-3377



**\$249,900**  
MLS 6676831 Residential  
1807 Beltrami Court  
Bemidji MN 56601





website: [www.AffinityRealEstate.com](http://www.AffinityRealEstate.com) | email: [info@affinityrealestate.com](mailto:info@affinityrealestate.com) | office: 218-237-3333 | fax:218-237-3377

**Affinity**  
REAL ESTATE INC

**\$249,900**  
MLS 6676831 Residential  
1807 Beltrami Court  
Bemidji MN 56601





website: [www.AffinityRealEstate.com](http://www.AffinityRealEstate.com) | email: [info@affinityrealestate.com](mailto:info@affinityrealestate.com) | office: 218-237-3333 | fax: 218-237-3377

**Affinity**  
REAL ESTATE INC

**\$249,900**  
MLS 6676831 Residential  
1807 Beltrami Court  
Bemidji MN 56601





website: [www.AffinityRealEstate.com](http://www.AffinityRealEstate.com) | email: [info@affinityrealestate.com](mailto:info@affinityrealestate.com) | office: 218-237-3333 | fax:218-237-3377



**\$249,900**  
MLS 6676831 Residential  
1807 Beltrami Court  
Bemidji MN 56601





website: [www.AffinityRealEstate.com](http://www.AffinityRealEstate.com) | email: [info@affinityrealestate.com](mailto:info@affinityrealestate.com) | office: 218-237-3333 | fax:218-237-3377

**Affinity**  
REAL ESTATE INC

**\$249,900**  
MLS 6676831 Residential  
1807 Beltrami Court  
Bemidji MN 56601





website: [www.AffinityRealEstate.com](http://www.AffinityRealEstate.com) | email: [info@affinityrealestate.com](mailto:info@affinityrealestate.com) | office: 218-237-3333 | fax:218-237-3377

**Affinity**  
REAL ESTATE INC

**\$249,900**  
MLS 6676831 Residential  
1807 Beltrami Court  
Bemidji MN 56601





website: [www.AffinityRealEstate.com](http://www.AffinityRealEstate.com) | email: [info@affinityrealestate.com](mailto:info@affinityrealestate.com) | office: 218-237-3333 | fax:218-237-3377

**Affinity**  
REAL ESTATE INC

**\$249,900**  
MLS 6676831 Residential  
1807 Beltrami Court  
Bemidji MN 56601





website: [www.AffinityRealEstate.com](http://www.AffinityRealEstate.com) | email: [info@affinityrealestate.com](mailto:info@affinityrealestate.com) | office: 218-237-3333 | fax: 218-237-3377

**Affinity**  
REAL ESTATE INC

**\$249,900**  
MLS 6676831 Residential  
1807 Beltrami Court  
Bemidji MN 56601



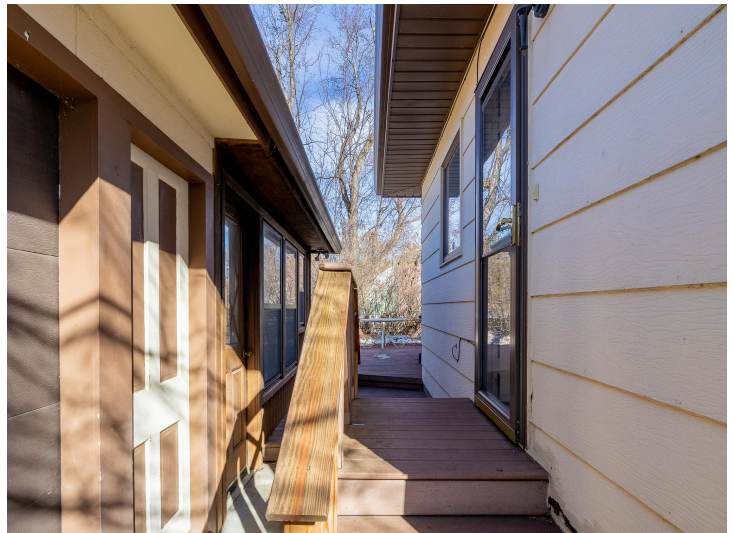

website: [www.AffinityRealEstate.com](http://www.AffinityRealEstate.com) | email: [info@affinityrealestate.com](mailto:info@affinityrealestate.com) | office: 218-237-3333 | fax:218-237-3377



**\$249,900**  
MLS 6676831 Residential  
1807 Beltrami Court  
Bemidji MN 56601





1807 Beltrami Ct NW, Bemidji, MN 56601  
Floor 1

Floor plan/area cannot be used for building or design purposes. Sizes and dimensions are approximate.

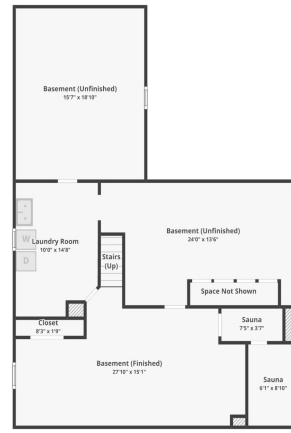

1807 Beltrami Ct NW, Bemidji, MN 56601  
Basement

Floor plan/area cannot be used for building or design purposes. Sizes and dimensions are approximate.

website: [www.AffinityRealEstate.com](http://www.AffinityRealEstate.com) | email: [info@affinityrealestate.com](mailto:info@affinityrealestate.com) | office: 218-237-3333 | fax:218-237-3377



**\$249,900**  
MLS 6676831 Residential  
1807 Beltrami Court  
Bemidji MN 56601