



MLS 6682009 Residential

\$314,900

2,000 sq ft
3 bedrooms
2 baths

34926 Rock Ridge Road
Shevlin MN 56676

Status: Active

Description:

Country life at its best!! Welcome to Rock Ridge, where you'll find this well-laid-out one-level home resting on over 3 acres. This home features an attached heated and finished garage that flows into an open floor plan right off the kitchen. The home showcases two large bedrooms and a spacious primary suite with a custom ensuite, including a walk-in shower, jetted tub, and custom tile throughout. For ample storage, a massive 30x60 shop awaits, with a lean-to, 12' sidewalls, 10x10' doors, and 30x40 of finished space ready for heat. Come take a look at the value this home has to offer!

Additional Details:

| | |
|------------------------|-----------------|
| Year Built | 2012 |
| Lot Acres | 3.9 |
| Lot Dimensions | 200x730x280x900 |
| Garage Stalls | 8 |
| School District | 162 |
| Taxes | \$1,558 |
| Taxes with Assessments | \$1,558 |
| Tax Year | 2024 |

Additional Features:

Basement: None **Fuel:** Electric, Propane **Garage:** 8 **Heat:** Boiler, Dual, Forced Air, Hot Water, Radiant Floor **Sewer:** Private Sewer, Tank with Drainage Field **Water:** Submersible - 4 Inch, Drilled, Well **Air Conditioning:** Central Air

Driving Directions:

From Bemidji Airport: West on US 2 15 miles, South on 243rd Ave, West on Rock Ridge Rd 1.5 miles.



Listed By:
218 Real Estate

Affinity Real Estate Inc. participates in the Regional Multiple Listing Service of Minnesota, Inc Broker Reciprocity (sm) program, allowing us to display other broker's listings on our website. All properties are subject to prior sale, change or withdrawal.



Call Affinity Real Estate

218-237-3333

info@affinityrealestate.com



Affinity Real Estate - 600 Park Avenue South - Park Rapids MN 56470



website: www.AffinityRealEstate.com | email: info@affinityrealestate.com | office: 218-237-3333 | fax: 218-237-3377



\$314,900
 MLS 6682009 Residential
 34926 Rock Ridge Road
 Shevlin MN 56676



website: www.AffinityRealEstate.com | email: info@affinityrealestate.com | office: 218-237-3333 | fax: 218-237-3377



\$314,900
MLS 6682009 Residential
34926 Rock Ridge Road
Shevlin MN 56676



website: www.AffinityRealEstate.com | email: info@affinityrealestate.com | office: 218-237-3333 | fax: 218-237-3377



\$314,900
 MLS 6682009 Residential
 34926 Rock Ridge Road
 Shevlin MN 56676



website: www.AffinityRealEstate.com | email: info@affinityrealestate.com | office: 218-237-3333 | fax: 218-237-3377



\$314,900
 MLS 6682009 Residential
 34926 Rock Ridge Road
 Shevlin MN 56676



website: www.AffinityRealEstate.com | email: info@affinityrealestate.com | office: 218-237-3333 | fax: 218-237-3377



\$314,900
 MLS 6682009 Residential
 34926 Rock Ridge Road
 Shevlin MN 56676

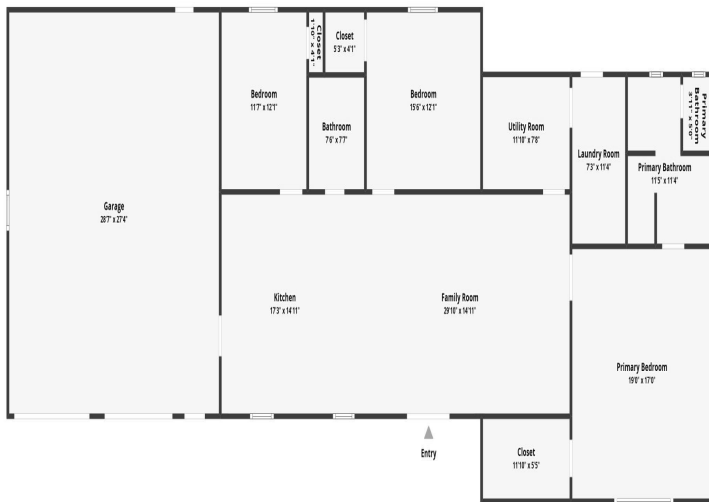

website: www.AffinityRealEstate.com | email: info@affinityrealestate.com | office: 218-237-3333 | fax:218-237-3377

\$314,900
MLS 6682009 Residential
34926 Rock Ridge Road
Shevlin MN 56676



website: www.AffinityRealEstate.com | email: info@affinityrealestate.com | office: 218-237-3333 | fax: 218-237-3377

Affinity
REAL ESTATE INC

\$314,900
MLS 6682009 Residential
34926 Rock Ridge Road
Shevlin MN 56676



website: www.AffinityRealEstate.com | email: info@affinityrealestate.com | office: 218-237-3333 | fax:218-237-3377



\$314,900

MLS 6682009 Residential
34926 Rock Ridge Road
Shevlin MN 56676