



MLS 6682271 Lake Land

\$197,500

Description:

This stunning 1.11 acre lot with nearly 200 feet of shoreline is nestled along Hartley Lake between Brainerd and Nisswa right in the heart of lake country. Level lot with gradual ten to fifteen feet elevation to the waters edge with mature pines and hardwoods. This panoramic lake view provides an ideal setting for building your dream home or vacation retreat. Enjoy year around activities , including fishing, boating, and watching the wildlife. Located just minutes from Brainerd and Nisswa shopping, restaurants, dinning, golf and all of the other area recreational amenities. Don't miss out on this great opportunity!

Additional Details:

Lot Acres	1.11
Lot Dimensions	199x214x60x204x163
School District	181
Taxes	\$744
Taxes with Assessments	\$744
Tax Year	2023

Additional Features:

Driving Directions:

Hwy 371, West on Gull Lake Dam Road, North on Hartley Lake Rd, Property on right.



Listed By:
Northland Sotheby's International Realty

Affinity Real Estate Inc. participates in the Regional Multiple Listing Service of Minnesota, Inc Broker Reciprocity (sm) program, allowing us to display other broker's listings on our website. All properties are subject to prior sale, change or withdrawal.



Call Affinity Real Estate

218-237-3333

info@affinityrealestate.com



Affinity Real Estate - 600 Park Avenue South - Park Rapids MN 56470



website: www.AffinityRealEstate.com | email: info@affinityrealestate.com | office: 218-237-3333 | fax: 218-237-3377



\$197,500
 MLS 6682271 Lake Land
 TBD Hartley Lake Road
 Brainerd MN 56401

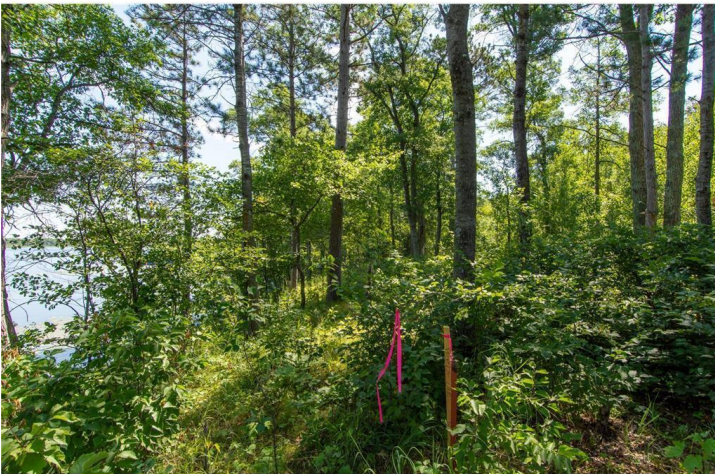
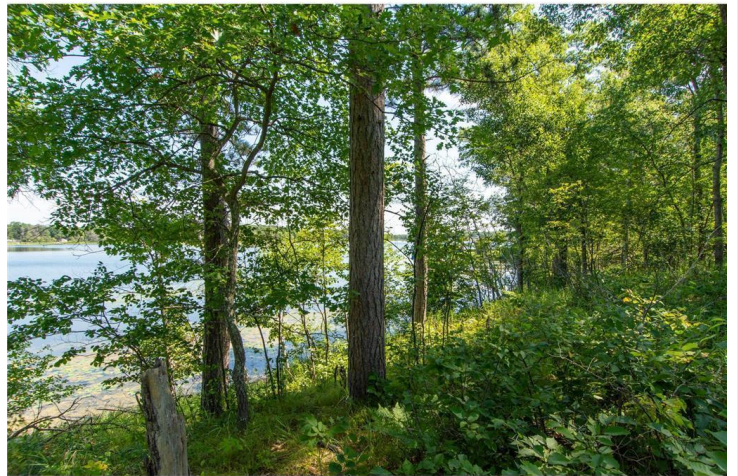

website: www.AffinityRealEstate.com | email: info@affinityrealestate.com | office: 218-237-3333 | fax: 218-237-3377



\$197,500
 MLS 6682271 Lake Land
 TBD Hartley Lake Road
 Brainerd MN 56401