



MLS 6683658 Lake Home

**\$699,900**

3,024 sq ft  
2 bedrooms  
3 baths

19605 Jigsaw Drive  
Park Rapids MN 56470

Waterfront: Bad Axe

Status: Active



**Description:**

Your Dream Log Home on Bad Axe Lake Awaits! Discover the beauty of custom living in this stunning log home, perfectly situated on the tranquil shores of Bad Axe Lake. With spectacular views and surrounded by hundreds of acres of county land for you to explore, this property offers the ultimate escape. Step inside to find a welcoming open layout featuring oak flooring and a cozy fieldstone propane fireplace, creating a warm ambiance perfect for those chilly evenings. The kitchen is excellent for cooking and entertaining, featuring granite counters and a modern design. This home offers two spacious bedrooms and three bathrooms. The fully finished basement has two bonus rooms with full egress windows, in-floor heating, and elegant ceramic tile. An energy-efficient dual fuel high-efficiency furnace keeps you comfortable year-round, while LED lighting ensures a bright, modern feel. Plus, you'll love the convenience of the heated attached garage, providing ample space for all your outdoor gear. Enjoy excellent fishing on Bad Axe Lake, known for its undisturbed beauty due to the limited development of the lake's pristine shoreline and the absence of public boat access. Don't miss this exceptional opportunity to own a slice of paradise! Schedule your showing today and experience lakeside living at its finest!

**Additional Details:**

Year Built	2004
Lot Acres	1.04
Lot Dimensions	155x279x157x303
Garage Stalls	2
School District	309
Taxes	\$2,914
Taxes with Assessments	\$3,124
Tax Year	2024

**Additional Features:**

**Fuel:** Electric, Propane **Heat:** Dual, Forced Air, Fireplace(s), Radiant Floor

**Driving Directions:**

Traveling North from Park Rapids on Highway 4, travel past Emmaville, and in about 2 miles, take a right onto Jigsaw Drive. Follow until the property is on the right.



Listed By:  
Wolff & Simon Real Estate

Affinity Real Estate Inc. participates in the Regional Multiple Listing Service of Minnesota, Inc Broker Reciprocity (sm) program, allowing us to display other broker's listings on our website. All properties are subject to prior sale, change or withdrawal.



**Call Affinity Real Estate**

**218-237-3333**

**info@affinityrealestate.com**



**Affinity Real Estate - 600 Park Avenue South - Park Rapids MN 56470**



website: [www.AffinityRealEstate.com](http://www.AffinityRealEstate.com) | email: [info@affinityrealestate.com](mailto:info@affinityrealestate.com) | office: 218-237-3333 | fax:218-237-3377



**\$699,900**  
MLS 6683658 Lake Home  
19605 Jigsaw Drive  
Park Rapids MN 56470



website: [www.AffinityRealEstate.com](http://www.AffinityRealEstate.com) | email: [info@affinityrealestate.com](mailto:info@affinityrealestate.com) | office: 218-237-3333 | fax: 218-237-3377

**Affinity**  
REAL ESTATE INC

**\$699,900**  
MLS 6683658 Lake Home  
19605 Jigsaw Drive  
Park Rapids MN 56470



website: [www.AffinityRealEstate.com](http://www.AffinityRealEstate.com) | email: [info@affinityrealestate.com](mailto:info@affinityrealestate.com) | office: 218-237-3333 | fax: 218-237-3377

**Affinity**  
REAL ESTATE INC

**\$699,900**  
MLS 6683658 Lake Home  
19605 Jigsaw Drive  
Park Rapids MN 56470



website: [www.AffinityRealEstate.com](http://www.AffinityRealEstate.com) | email: [info@affinityrealestate.com](mailto:info@affinityrealestate.com) | office: 218-237-3333 | fax:218-237-3377

**Affinity**  
REAL ESTATE INC

**\$699,900**  
MLS 6683658 Lake Home  
19605 Jigsaw Drive  
Park Rapids MN 56470



website: [www.AffinityRealEstate.com](http://www.AffinityRealEstate.com) | email: [info@affinityrealestate.com](mailto:info@affinityrealestate.com) | office: 218-237-3333 | fax: 218-237-3377

**Affinity**  
REAL ESTATE INC

**\$699,900**  
MLS 6683658 Lake Home  
19605 Jigsaw Drive  
Park Rapids MN 56470



website: [www.AffinityRealEstate.com](http://www.AffinityRealEstate.com) | email: [info@affinityrealestate.com](mailto:info@affinityrealestate.com) | office: 218-237-3333 | fax: 218-237-3377

**Affinity**  
REAL ESTATE INC

**\$699,900**  
MLS 6683658 Lake Home  
19605 Jigsaw Drive  
Park Rapids MN 56470



**Jigsaw Drive**  
 Hubbard County - 301 Court Ave, Park Rapids, MN 56470  
 Created 8/12/2025 at 10:15 AM

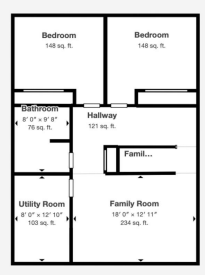

**Matterport Property Report**  
 19065 Jig Saw Dr  
 Gross Floor Area - Full Property 3,337 sq. ft. | Floor 1,067 sq. ft.  
 Sizes and Dimensions are approximate. Actual may vary.

Visit 3D spaces on  
**Matterport**

website: [www.AffinityRealEstate.com](http://www.AffinityRealEstate.com) | email: [info@affinityrealestate.com](mailto:info@affinityrealestate.com) | office: 218-237-3333 | fax: 218-237-3377



**\$699,900**  
 MLS 6683658 Lake Home  
 19065 Jigsaw Drive  
 Park Rapids MN 56470



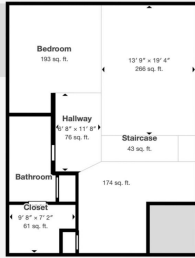

Matterport Property Report  
 19605 Jig Saw Dr  
 Gross Floor Area - Full Property 3,337 sq. ft. | Floor 3 1,030 sq. ft.  
Dates and dimensions are approximate, actual may vary.

Visit 3D space on  
 Matterport

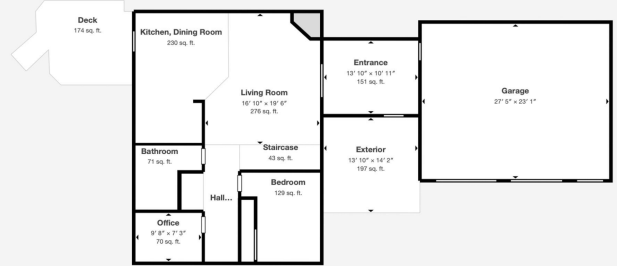
Matterport Property Report  
 19605 Jig Saw Dr  
 Gross Floor Area - Full Property 3,337 sq. ft. | Floor 2 1,241 sq. ft.  
Dates and dimensions are approximate, actual may vary.

Visit 3D space on  
 Matterport



website: [www.AffinityRealEstate.com](http://www.AffinityRealEstate.com) | email: [info@affinityrealestate.com](mailto:info@affinityrealestate.com) | office: 218-237-3333 | fax: 218-237-3377



**\$699,900**  
 MLS 6683658 Lake Home  
 19605 Jigsaw Drive  
 Park Rapids MN 56470

website: [www.AffinityRealEstate.com](http://www.AffinityRealEstate.com) | email: [info@affinityrealestate.com](mailto:info@affinityrealestate.com) | office: 218-237-3333 | fax:218-237-3377



**\$699,900**

MLS 6683658 Lake Home  
19605 Jigsaw Drive  
Park Rapids MN 56470