



MLS 6685514 Residential

\$664,900

3,635 sq ft
5 bedrooms
4 baths

16839 Piper Lane
Brainerd MN 56401

Status: Pending

Description:

This stunning, custom-built 5-bedroom, 4-bath home, built in 2022, is nestled on a picturesque 2.5-acre wooded lot in Barbeau Rd Estates. Designed with style and functionality in mind, it boasts high-end upgrades, including granite countertops, a sleek tile backsplash in the kitchen, a cozy fireplace, custom lockers, and an irrigation system. The spacious layout features four bedrooms on the upper level, a loft, and a convenient upstairs laundry. Enjoy the bright and inviting sunroom, as well as the newly finished lower level which includes a family room, full bath and a bedroom. A four-car garage provides ample storage for all your toys. A cement parking pad on the south side of the garage can store your RV or boat. Ideally situated between Baxter and Nisswa, this home offers easy access to shopping, dining, and Gull Lake while maintaining the privacy of a wooded retreat.

Additional Details:

Year Built	2022
Lot Acres	2.53
Lot Dimensions	536x213x501x215
Garage Stalls	4
School District	181
Taxes	\$3,558
Taxes with Assessments	\$3,558
Tax Year	2025

Additional Features:

Basement: 8 ft+ Pour, Finished **Fuel:** Natural Gas **Garage:** 4 **Heat:** Forced Air, Fireplace(s) **Sewer:** Private Sewer **Water:** Submersible - 4 Inch, Private **Air Conditioning:** Central Air

Driving Directions:

From Hwy 371, West on Barbeau Rd to Left on Piper Lane to property on the left. For sale sign on property.



Listed By:
Keller Williams Realty Professionals

Affinity Real Estate Inc. participates in the Regional Multiple Listing Service of Minnesota, Inc Broker Reciprocity (sm) program, allowing us to display other broker's listings on our website. All properties are subject to prior sale, change or withdrawal.



Call Affinity Real Estate

218-237-3333

info@affinityrealestate.com



Affinity Real Estate - 600 Park Avenue South - Park Rapids MN 56470



website: www.AffinityRealEstate.com | email: info@affinityrealestate.com | office: 218-237-3333 | fax: 218-237-3377



\$664,900
 MLS 6685514 Residential
 16839 Piper Lane
 Brainerd MN 56401



website: www.AffinityRealEstate.com | email: info@affinityrealestate.com | office: 218-237-3333 | fax: 218-237-3377

Affinity
REAL ESTATE INC

\$664,900
MLS 6685514 Residential
16839 Piper Lane
Brainerd MN 56401



website: www.AffinityRealEstate.com | email: info@affinityrealestate.com | office: 218-237-3333 | fax: 218-237-3377

Affinity
REAL ESTATE INC

\$664,900
MLS 6685514 Residential
16839 Piper Lane
Brainerd MN 56401



website: www.AffinityRealEstate.com | email: info@affinityrealestate.com | office: 218-237-3333 | fax: 218-237-3377

Affinity
REAL ESTATE INC

\$664,900
MLS 6685514 Residential
16839 Piper Lane
Brainerd MN 56401



website: www.AffinityRealEstate.com | email: info@affinityrealestate.com | office: 218-237-3333 | fax: 218-237-3377



\$664,900
 MLS 6685514 Residential
 16839 Piper Lane
 Brainerd MN 56401



website: www.AffinityRealEstate.com | email: info@affinityrealestate.com | office: 218-237-3333 | fax: 218-237-3377



\$664,900
MLS 6685514 Residential
16839 Piper Lane
Brainerd MN 56401

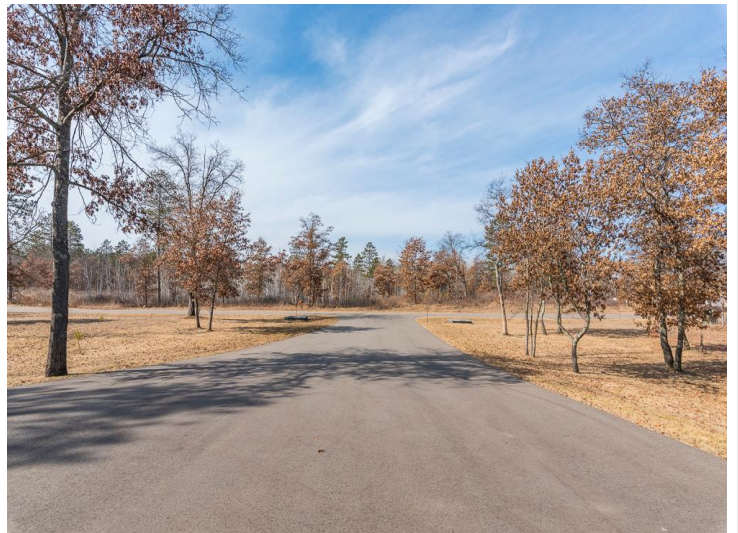

website: www.AffinityRealEstate.com | email: info@affinityrealestate.com | office: 218-237-3333 | fax: 218-237-3377



\$664,900
 MLS 6685514 Residential
 16839 Piper Lane
 Brainerd MN 56401



website: www.AffinityRealEstate.com | email: info@affinityrealestate.com | office: 218-237-3333 | fax: 218-237-3377



\$664,900
 MLS 6685514 Residential
 16839 Piper Lane
 Brainerd MN 56401

website: www.AffinityRealEstate.com | email: info@affinityrealestate.com | office: 218-237-3333 | fax:218-237-3377



\$664,900

MLS 6685514 Residential
16839 Piper Lane
Brainerd MN 56401

website: www.AffinityRealEstate.com | email: info@affinityrealestate.com | office: 218-237-3333 | fax:218-237-3377



\$664,900

MLS 6685514 Residential
16839 Piper Lane
Brainerd MN 56401