



MLS 6700487 Land

**\$110,000**

10 Acres  
Raw Land

TBD 405th Avenue  
Perham MN 56573

Status: Pending

**Description:**

10 acres of rolling hills 5 minutes to Perham makes a wonderful building spot! Located just off of Hwy 10, this land offers a great place to build a home, make a hobby farm, or keep as an investment. Rolling open land provides a blank slate to plant trees in desired locations. Restrictive covenants planned including residential only (no commercial use). Great location on the west side of Perham. Seller will survey off the 10 acres prior to sale and may consider a smaller, 5AC piece on the southerly line instead of the 10 acres. Take a look today!

**Additional Details:**

Lot Acres	10
Lot Dimensions	10 Acres
School District	549
Taxes	(unreported)
Taxes with Assessments	(unreported)
Tax Year	2025

**Additional Features:**

**Driving Directions:**

From Perham W on St Hwy 10, left on 405th Ave, property on the left.



Listed By:  
Real Estate Results

Affinity Real Estate Inc. participates in the Regional Multiple Listing Service of Minnesota, Inc Broker Reciprocity (sm) program, allowing us to display other broker's listings on our website. All properties are subject to prior sale, change or withdrawal.



**Call Affinity Real Estate**

**218-237-3333**

**info@affinityrealestate.com**



**Affinity Real Estate - 600 Park Avenue South - Park Rapids MN 56470**



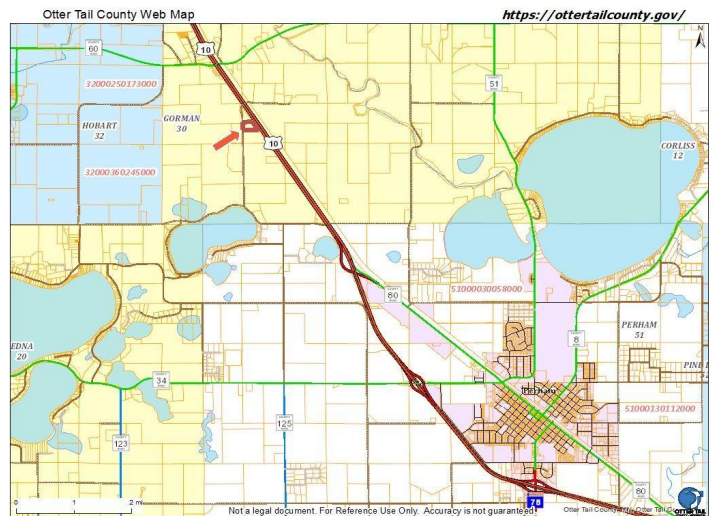

website: [www.AffinityRealEstate.com](http://www.AffinityRealEstate.com) | email: [info@affinityrealestate.com](mailto:info@affinityrealestate.com) | office: 218-237-3333 | fax: 218-237-3377



**\$110,000**  
 MLS 6700487 Land  
 TBD 405th Avenue  
 Perham MN 56573





website: [www.AffinityRealEstate.com](http://www.AffinityRealEstate.com) | email: [info@affinityrealestate.com](mailto:info@affinityrealestate.com) | office: 218-237-3333 | fax: 218-237-3377



**\$110,000**  
MLS 6700487 Land  
TBD 405th Avenue  
Perham MN 56573