



MLS 6703734 Commercial

**\$795,000**

16396 State Highway 371  
Brainerd MN 56401

Status: Active

**Description:**

Prime Commercial Opportunity on the Booming 371 Corridor!

Looking to expand your business in one of the fastest-growing areas in the Lakes Region? Don't miss this prime location right on the sought-after 371 corridor!

**Key Features:**

Almost 10 Acres

Zoned - 233 - 3A COMMERCIAL PREFERENTIAL, Unorganized Territory

Room to grow – ample space for expansion

Full of character – a unique property with personality

Unbeatable location – centrally nestled between Baxter/Brainerd and Nisswa

Close to shopping, dining, recreation, and all the top amenities the thriving Lakes Area has to offer

Location, location, location – this is your chance to position your business in the heart of a vibrant, growing market.

**Additional Details:**

Year Built	1993
Lot Acres	9.97
Lot Dimensions	499x591x745x1145
Garage Stalls	5
School District	181
Taxes	\$3,586
Taxes with Assessments	\$3,616

1 Listed By: 2025  
Edina Realty, Inc.

**Additional Features:**  
Affinity Real Estate Inc. participates in the Regional Multiple Listing Service of Minnesota, Inc. Broker Reciprocity (sm) program, allowing us to display other broker's listings on our website. All properties are subject to prior sale, change or withdrawal.

**Driving Directions:**

From Highway Intersection 371 & 210 go North on 371 approximately 3.5 miles Property on East side of highway, between Landsburg and Living Word North Church.



**Call Affinity Real Estate**

**218-237-3333**

**info@affinityrealestate.com**



Affinity Real Estate - 600 Park Avenue South - Park Rapids MN 56470





website: [www.AffinityRealEstate.com](http://www.AffinityRealEstate.com) | email: [info@affinityrealestate.com](mailto:info@affinityrealestate.com) | office: 218-237-3333 | fax: 218-237-3377



**\$795,000**  
 MLS 6703734 Commercial  
 16396 State Highway 371  
 Brainerd MN 56401





website: [www.AffinityRealEstate.com](http://www.AffinityRealEstate.com) | email: [info@affinityrealestate.com](mailto:info@affinityrealestate.com) | office: 218-237-3333 | fax: 218-237-3377



**\$795,000**  
 MLS 6703734 Commercial  
 16396 State Highway 371  
 Brainerd MN 56401





website: [www.AffinityRealEstate.com](http://www.AffinityRealEstate.com) | email: [info@affinityrealestate.com](mailto:info@affinityrealestate.com) | office: 218-237-3333 | fax: 218-237-3377

**Affinity**  
REAL ESTATE INC

**\$795,000**  
MLS 6703734 Commercial  
16396 State Highway 371  
Brainerd MN 56401





Old barn converted to DWEL

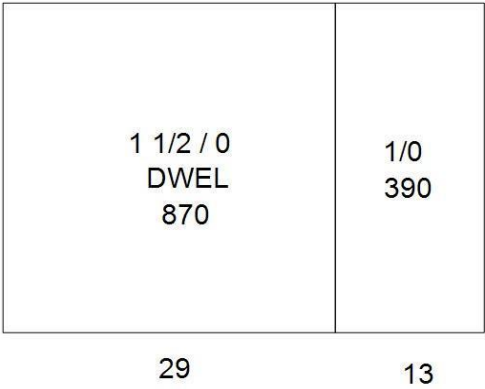
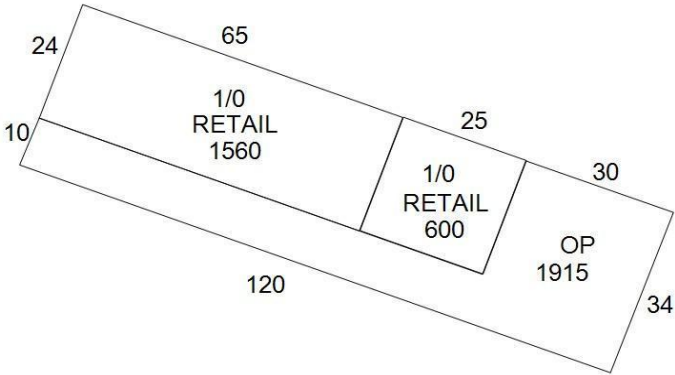

website: [www.AffinityRealEstate.com](http://www.AffinityRealEstate.com) | email: [info@affinityrealestate.com](mailto:info@affinityrealestate.com) | office: 218-237-3333 | fax: 218-237-3377



**\$795,000**  
MLS 6703734 Commercial  
16396 State Highway 371  
Brainerd MN 56401