



MLS 6705827 Lake Land

\$3,590,000

Description:

Welcome to Your Lakeside Sanctuary on the Whitefish Chain with over 8+ Acres and 263+ feet of sand shoreline. Pull up a chair and let the world slow down as you settle onto the rooftop deck of your private boathouse, where the only thing more captivating than the view is the sense of peace that comes with it. From this serene perch, take in sweeping vistas of Upper Whitefish Lake: glimmering waters stretching out beneath a canopy of trees, a gentle breeze whispering through the pines. This lakefront lot is a rare gem, offering a protected, woodsy setting and a shoreline that's both sandy and pebbly. It's perfect for barefoot walks, morning paddles, or simply watching the waterfowl. Whether you're drawn to tranquil mornings or the excitement of summer adventure, this place is ready for it all.

A large, well-constructed garage awaits your outdoor gear and lake toys, featuring three oversized overhead doors, a durable concrete floor, and ample room for vehicles, boats, or even a workshop. 7.59+ Acres, there's even a creek that winds its way through the property, adding to the natural charm and privacy of this unique retreat. Located in the heart of Minnesota's beloved Whitefish Chain of Lakes, just minutes from the vibrant town of Crosslake, this is more than just a property, it's an invitation to a lifestyle of lake days, starry nights, and memories that will last a lifetime.

Additional Details:

Lot Acres	8.36
Lot Dimensions	263x1592x191x1445
School District	2174
Taxes	\$10,035
Taxes with Assessments	\$10,035
Tax Year	2025

Additional Features:

Driving Directions:

From Pine River go East out of town on County Road 2, which turns into County Road 1 after the roundabout. After roundabout go approx. 5.8 miles, take a Right on Mink Lane. First driveway on the right.



Listed By:
Your Home Sold Guaranteed Realty Exclusive

Affinity Real Estate Inc. participates in the Regional Multiple Listing Service of Minnesota, Inc Broker Reciprocity (sm) program, allowing us to display other broker's listings on our website. All properties are subject to prior sale, change or withdrawal.



Call Affinity Real Estate

218-237-3333

info@affinityrealestate.com



Affinity Real Estate - 600 Park Avenue South - Park Rapids MN 56470

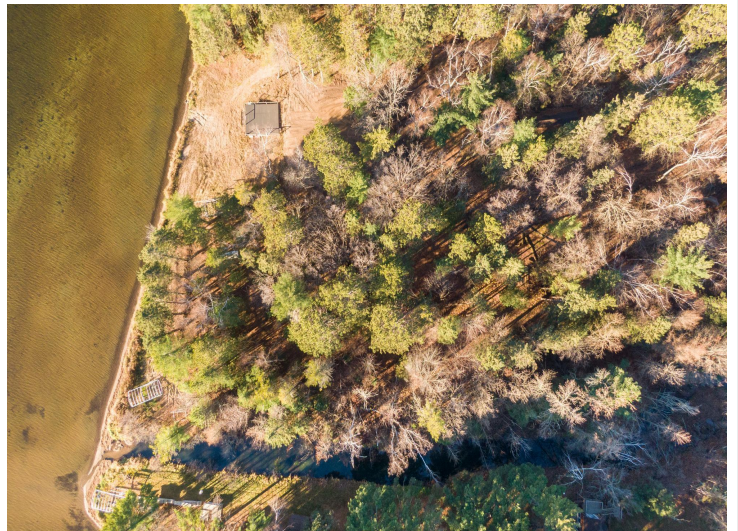

website: www.AffinityRealEstate.com | email: info@affinityrealestate.com | office: 218-237-3333 | fax: 218-237-3377



\$3,590,000

MLS 6705827 Lake Land
38981 Mink Lane
Pine River MN 56474



website: www.AffinityRealEstate.com | email: info@affinityrealestate.com | office: 218-237-3333 | fax: 218-237-3377



\$3,590,000

MLS 6705827 Lake Land
38981 Mink Lane
Pine River MN 56474



website: www.AffinityRealEstate.com | email: info@affinityrealestate.com | office: 218-237-3333 | fax: 218-237-3377



\$3,590,000

MLS 6705827 Lake Land
38981 Mink Lane
Pine River MN 56474



website: www.AffinityRealEstate.com | email: info@affinityrealestate.com | office: 218-237-3333 | fax: 218-237-3377



\$3,590,000

MLS 6705827 Lake Land
38981 Mink Lane
Pine River MN 56474



website: www.AffinityRealEstate.com | email: info@affinityrealestate.com | office: 218-237-3333 | fax: 218-237-3377



\$3,590,000

MLS 6705827 Lake Land
38981 Mink Lane
Pine River MN 56474

website: www.AffinityRealEstate.com | email: info@affinityrealestate.com | office: 218-237-3333 | fax:218-237-3377



\$3,590,000

MLS 6705827 Lake Land
38981 Mink Lane
Pine River MN 56474

website: www.AffinityRealEstate.com | email: info@affinityrealestate.com | office: 218-237-3333 | fax:218-237-3377



\$3,590,000

MLS 6705827 Lake Land
38981 Mink Lane
Pine River MN 56474

website: www.AffinityRealEstate.com | email: info@affinityrealestate.com | office: 218-237-3333 | fax: 218-237-3377



\$3,590,000

MLS 6705827 Lake Land
38981 Mink Lane
Pine River MN 56474