



MLS 6722070 Lake Home

**\$139,900**

850 sq ft  
1 bedrooms  
1 baths

28435 392nd Street  
Browerville MN 56438

Waterfront: Fawn

Status: Pending

**Description:**

Don't miss this affordable weekend retreat. This year-round home has a freshly painted interior, a free-standing wood fireplace, in-floor heat, a low-maintenance metal roof and vinyl siding, an impressive two-story living room, and a large loft area. Home sits on .46 acre wooded lot that over looks large wetland full of wildlife. Property belongs to the Sylvan Shores Association, \$120 per year, and enjoy access to four lakes, the Long Prairie River, clubhouse, tennis, basketball & volleyball courts, swimming pool, lakeside beach, community center, campgrounds, and boat landings. Set up a showing today.

**Additional Details:**

Year Built	1990
Lot Acres	0.46
Lot Dimensions	111x205
School District	2170
Taxes	\$824
Taxes with Assessments	\$824
Tax Year	2025

**Additional Features:**

**Basement:** None **Fuel:** Electric, Wood **Heat:** Boiler, Radiant Floor, Wood Stove **Sewer:** Mound Septic, Private Sewer, Septic System Compliant - Yes **Water:** Drilled, Well **Air Conditioning:** Window Unit(s)

**Driving Directions:**

From Hwy 10, go west on County Rd 18 for 8.5 miles, turn right on County Rd 17, turn left onto 392nd Street, to home on left.



Listed By:  
eXp Realty

Affinity Real Estate Inc. participates in the Regional Multiple Listing Service of Minnesota, Inc Broker Reciprocity (sm) program, allowing us to display other broker's listings on our website. All properties are subject to prior sale, change or withdrawal.



**Call Affinity Real Estate**

**218-237-3333**

**info@affinityrealestate.com**



**Affinity Real Estate - 600 Park Avenue South - Park Rapids MN 56470**





website: [www.AffinityRealEstate.com](http://www.AffinityRealEstate.com) | email: [info@affinityrealestate.com](mailto:info@affinityrealestate.com) | office: 218-237-3333 | fax: 218-237-3377

**Affinity**  
REAL ESTATE INC

**\$139,900**  
MLS 6722070 Lake Home  
28435 392nd Street  
Browerville MN 56438





website: [www.AffinityRealEstate.com](http://www.AffinityRealEstate.com) | email: [info@affinityrealestate.com](mailto:info@affinityrealestate.com) | office: 218-237-3333 | fax:218-237-3377

**Affinity**  
REAL ESTATE INC

**\$139,900**  
MLS 6722070 Lake Home  
28435 392nd Street  
Browerville MN 56438





website: [www.AffinityRealEstate.com](http://www.AffinityRealEstate.com) | email: [info@affinityrealestate.com](mailto:info@affinityrealestate.com) | office: 218-237-3333 | fax:218-237-3377

**Affinity**  
REAL ESTATE INC

**\$139,900**  
MLS 6722070 Lake Home  
28435 392nd Street  
Browerville MN 56438





website: [www.AffinityRealEstate.com](http://www.AffinityRealEstate.com) | email: [info@affinityrealestate.com](mailto:info@affinityrealestate.com) | office: 218-237-3333 | fax: 218-237-3377

**Affinity**  
REAL ESTATE INC

**\$139,900**  
MLS 6722070 Lake Home  
28435 392nd Street  
Browerville MN 56438



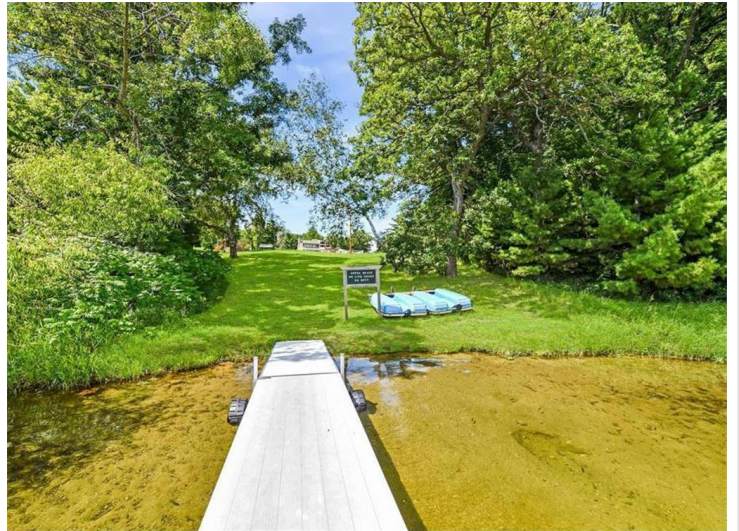

website: [www.AffinityRealEstate.com](http://www.AffinityRealEstate.com) | email: [info@affinityrealestate.com](mailto:info@affinityrealestate.com) | office: 218-237-3333 | fax:218-237-3377

**Affinity**  
REAL ESTATE INC

**\$139,900**  
MLS 6722070 Lake Home  
28435 392nd Street  
Browerville MN 56438





website: [www.AffinityRealEstate.com](http://www.AffinityRealEstate.com) | email: [info@affinityrealestate.com](mailto:info@affinityrealestate.com) | office: 218-237-3333 | fax:218-237-3377



**\$139,900**  
MLS 6722070 Lake Home  
28435 392nd Street  
Browerville MN 56438