

MLS 6729333 Land

**\$125,000**

0.98 Acres  
Raw Land

TBD Tract C Height Of Land Drive  
Rochert MN 56578

Status: Active

**Description:**

This property on Height of Land Lake offers a serene natural setting with privacy. With approximately 1 acre of land and 156 feet of hard-bottom lakeshore, it's an ideal spot for those looking to enjoy waterfront living, and stunning views. The availability of electricity on-site adds convenience, and the absence of covenants provides flexibility for development. The access road off of SW HOL Drive leads you to the lots that are surrounded by mature oak trees that enhances the peaceful atmosphere, making it a perfect retreat from busy life. This lot presents a great opportunity for various possibilities, whether for building a home or other recreational uses.

**Additional Details:**

Lot Acres	0.98
Lot Dimensions	156x274
School District	1106
Taxes	\$824
Taxes with Assessments	\$824
Tax Year	2024

**Additional Features:**

**Driving Directions:**

From Detroit Lakes or Park Rapids, take MN State Hwy 34 to Charlie's and turn onto SW Height of Land Dr at the public access. Go W/NW on the tar. When the road turns to gravel, go approx. 1/4 mile until you come to the property, marked with signs.



Listed By:  
HomeSmart Adventure Realty

Affinity Real Estate Inc. participates in the Regional Multiple Listing Service of Minnesota, Inc Broker Reciprocity (sm) program, allowing us to display other broker's listings on our website. All properties are subject to prior sale, change or withdrawal.



**Call Affinity Real Estate**

**218-237-3333**

**info@affinityrealestate.com**



**Affinity Real Estate - 600 Park Avenue South - Park Rapids MN 56470**

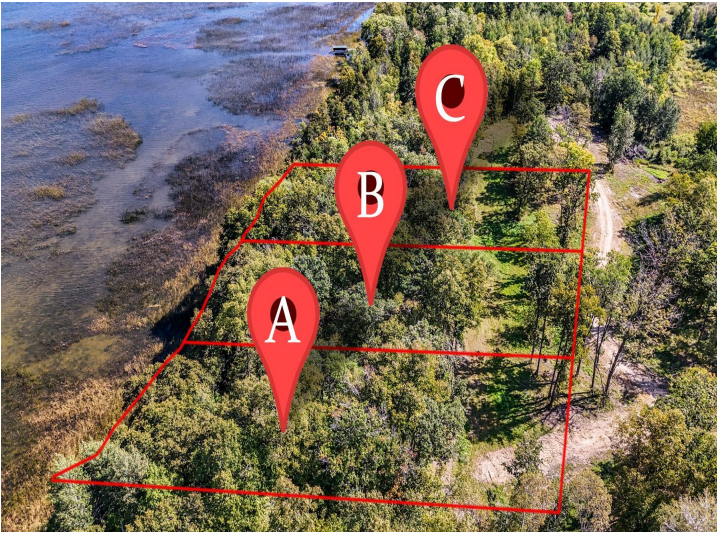

website: [www.AffinityRealEstate.com](http://www.AffinityRealEstate.com) | email: [info@affinityrealestate.com](mailto:info@affinityrealestate.com) | office: 218-237-3333 | fax:218-237-3377



**\$125,000**  
MLS 6729333 Land  
TBD Tract C Height Of Land  
Drive  
Rochert MN 56578