



MLS 6740446 Residential

\$84,900

1,584 sq ft
2 bedrooms
2 baths

196 Beaulieu Street
Motley MN 56466

Status: Pending

Description:

Affordable, quaint home on a large corner lot. Conveniently located. Roof is 2 yrs old. All living is on one level with generously sized rooms and plenty of storage. Bonus extra

Additional Details:

Year Built	1860
Lot Acres	0.34
Lot Dimensions	150'x100'x150'x100'
School District	2170
Taxes	\$1,536
Taxes with Assessments	\$1,536
Tax Year	2024

Additional Features:

Basement: Crawl Space, Unfinished **Fuel:** Natural Gas **Heat:** Radiant **Sewer:** City Sewer/Connected **Water:** City Water/Connected **Air Conditioning:** None

Driving Directions:

South in Motley to Left on Beaulieu.



Listed By:
HOMESTEAD ROAD

Affinity Real Estate Inc. participates in the Regional Multiple Listing Service of Minnesota, Inc Broker Reciprocity (sm) program, allowing us to display other broker's listings on our website. All properties are subject to prior sale, change or withdrawal.



Call Affinity Real Estate

218-237-3333

info@affinityrealestate.com



Affinity Real Estate - 600 Park Avenue South - Park Rapids MN 56470



website: www.AffinityRealEstate.com | email: info@affinityrealestate.com | office: 218-237-3333 | fax: 218-237-3377

Affinity
REAL ESTATE INC

\$84,900
MLS 6740446 Residential
196 Beaulieu Street
Motley MN 56466



website: www.AffinityRealEstate.com | email: info@affinityrealestate.com | office: 218-237-3333 | fax: 218-237-3377



\$84,900
 MLS 6740446 Residential
 196 Beaulieu Street
 Motley MN 56466

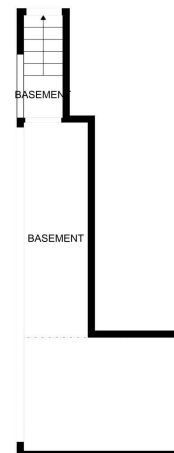

FLOOR PLAN CREATED BY CURBICASA APP. MEASUREMENTS DEEMED HIGHLY RELIABLE BUT NOT GUARANTEED.

website: www.AffinityRealEstate.com | email: info@affinityrealestate.com | office: 218-237-3333 | fax: 218-237-3377



\$84,900
 MLS 6740446 Residential
 196 Beaulieu Street
 Motley MN 56466



FLOOR PLAN CREATED BY CUBICASA APP. MEASUREMENTS DEEMED HIGHLY RELIABLE BUT NOT GUARANTEED.

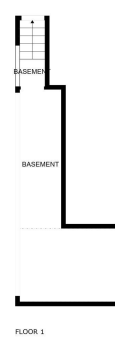

FLOOR 1

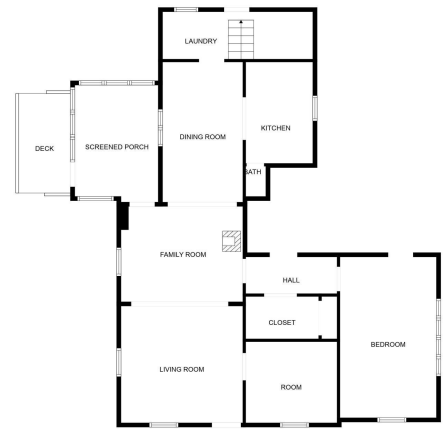

FLOOR 2

FLOOR PLAN CREATED BY CUBICASA APP. MEASUREMENTS DEEMED HIGHLY RELIABLE BUT NOT GUARANTEED.

website: www.AffinityRealEstate.com | email: info@affinityrealestate.com | office: 218-237-3333 | fax: 218-237-3377



\$84,900
 MLS 6740446 Residential
 196 Beaulieu Street
 Motley MN 56466