



MLS 6747499 Land

**\$199,900**

1.13 Acres

Raw Land

TBD Eddie Baxter Drive  
Park Rapids MN 56470

Status: Pending

**Description:**

To be built, this appealing 40x60 pole building will feature 16' sidewalls, two 12x14 garage doors, 200-amp service, in-floor tubing, and will be prepped for a well and bathroom. Situated on over an acre of land with a variety of trees, it is conveniently positioned between Nevis and Park Rapids. This property can fulfill all your storage needs and offers potential for a workshop in the sought-after lakes area.

**Additional Details:**

Lot Acres	1.13
Lot Dimensions	152x345x150x314
School District	309
Taxes	\$142
Taxes with Assessments	\$142
Tax Year	2025

**Additional Features:**

**Driving Directions:**

From 34/71 in Park Rapids, East on 34 to a right on County Road 11 to a left on Eddie Baxter Dr. to property.



Listed By:  
Wolff & Simon Real Estate

Affinity Real Estate Inc. participates in the Regional Multiple Listing Service of Minnesota, Inc Broker Reciprocity (sm) program, allowing us to display other broker's listings on our website. All properties are subject to prior sale, change or withdrawal.



**Call Affinity Real Estate**

**218-237-3333**

**info@affinityrealestate.com**



**Affinity Real Estate - 600 Park Avenue South - Park Rapids MN 56470**

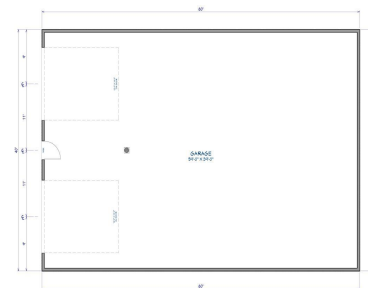

website: [www.AffinityRealEstate.com](http://www.AffinityRealEstate.com) | email: [info@affinityrealestate.com](mailto:info@affinityrealestate.com) | office: 218-237-3333 | fax: 218-237-3377



**\$199,900**  
 MLS 6747499 Land  
 TBD Eddie Baxter Drive  
 Park Rapids MN 56470