



MLS 6761014 Lake Land

\$175,000

Description:

Welcome to Minnesota Lake Life!

Discover the perfect lakeside retreat on Big Sugarbush Lake—one of the area's most pristine and picturesque destinations. This rare 1.6-acre lot features an impressive 205 feet of shoreline and offers the ideal mix of relaxation and recreation.

Whether you're looking to park your camper for the weekend or build your dream lake home, this property delivers. The level building site at the entrance makes for easy access, and with water and electricity already available, you're ready to start enjoying right away.

Big Sugarbush is known for its crystal-clear waters and excellent fishing—making it a year-round destination for anglers and outdoor enthusiasts alike. Spend your days listening to the soothing calls of loons, surrounded by peace and natural beauty.

An adorable bunkhouse with a spacious deck adds charm and functionality, creating the perfect space for family gatherings, summer BBQs, or cozy weekend getaways.

Opportunities like this don't come along often—don't miss your chance to own a slice of Minnesota lake paradise!

Additional Details:

Lot Acres	1.62
Lot Dimensions	205x310
School District	22
Taxes	\$562
Taxes with Assessments	\$562
Tax Year	2025

Additional Features:



Listed By:
HomeSmart Adventure Realty

For more information, please contact the listing agent. This listing is part of the Regional Multiple Listing Service of Minnesota, Inc Broker Reciprocity (sm) program, allowing us to display other broker's listings on our website. All properties are subject to prior sale, change or withdrawal.



Call Affinity Real Estate

218-237-3333

info@affinityrealestate.com



Affinity Real Estate - 600 Park Avenue South - Park Rapids MN 56470

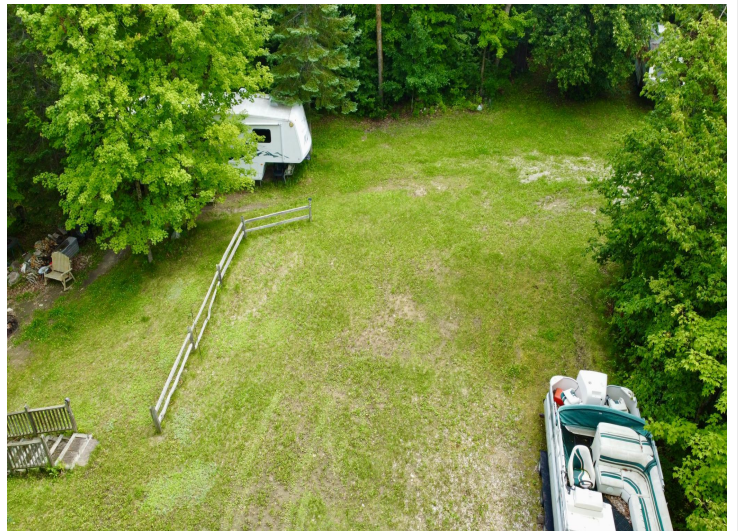

website: www.AffinityRealEstate.com | email: info@affinityrealestate.com | office: 218-237-3333 | fax: 218-237-3377

Affinity
REAL ESTATE INC

\$175,000
MLS 6761014 Lake Land
29860 Sugarbush Road
Ogema MN 56569

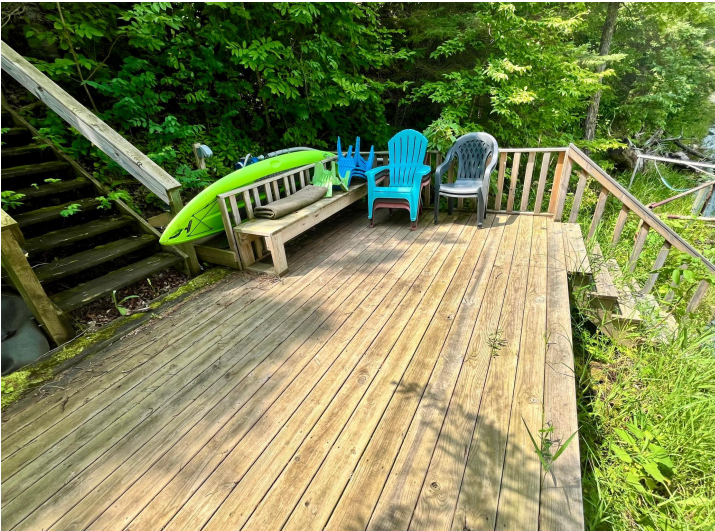

website: www.AffinityRealEstate.com | email: info@affinityrealestate.com | office: 218-237-3333 | fax: 218-237-3377

Affinity
REAL ESTATE INC

\$175,000

MLS 6761014 Lake Land
29860 Sugarbush Road
Ogema MN 56569



website: www.AffinityRealEstate.com | email: info@affinityrealestate.com | office: 218-237-3333 | fax:218-237-3377



\$175,000

MLS 6761014 Lake Land
29860 Sugarbush Road
Ogema MN 56569

website: www.AffinityRealEstate.com | email: info@affinityrealestate.com | office: 218-237-3333 | fax:218-237-3377



\$175,000

MLS 6761014 Lake Land
29860 Sugarbush Road
Ogema MN 56569