



MLS 6777545 Land

\$129,900

0.07 Square Feet
Site Plan Approved

#1 State Highway 371 NW
Backus MN 56435

Status: Active

Description:

Need just a little more space than your garage can handle? Whether it's for your boat, RV, car, snowmobile, or ATV — these to-be-built pole buildings have you covered! Own your space! With only 27 buildings available, now's the time to secure your spot. Each 32x48 steel building features a concrete floor with in-floor heat ran, four daylight windows, a 16x14 overhead door, and connected electric. This larger lot offers options for a private well and septic holding tank, giving you even more flexibility! Swing in and out with ease located right off Highway 371 in Backus, MN, this secure development will soon include a gated entrance, paved road, and a common building with a kitchenette and bathroom. Perfect for cabin owners, hobbyists, or anyone needing extra space Up North!

Additional Details:

Lot Acres	0.07
Lot Dimensions	32x82
School District	2174
Taxes	\$196
Taxes with Assessments	\$196
Tax Year	2025

Additional Features:

Driving Directions:

Heading North on MN-371 coming into Backus. Property will be on the left just before leaving Backus. Follow signs.



Listed By:
Realty ONE Group Choice

Affinity Real Estate Inc. participates in the Regional Multiple Listing Service of Minnesota, Inc Broker Reciprocity (sm) program, allowing us to display other broker's listings on our website. All properties are subject to prior sale, change or withdrawal.



Call Affinity Real Estate

218-237-3333

info@affinityrealestate.com



Affinity Real Estate - 600 Park Avenue South - Park Rapids MN 56470

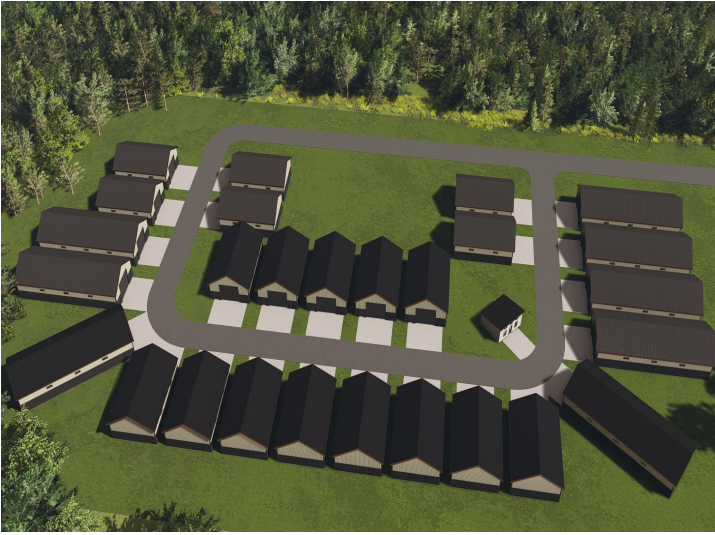

website: www.AffinityRealEstate.com | email: info@affinityrealestate.com | office: 218-237-3333 | fax: 218-237-3377



\$129,900
 MLS 6777545 Land
 #1 State Highway 371 NW
 Backus MN 56435

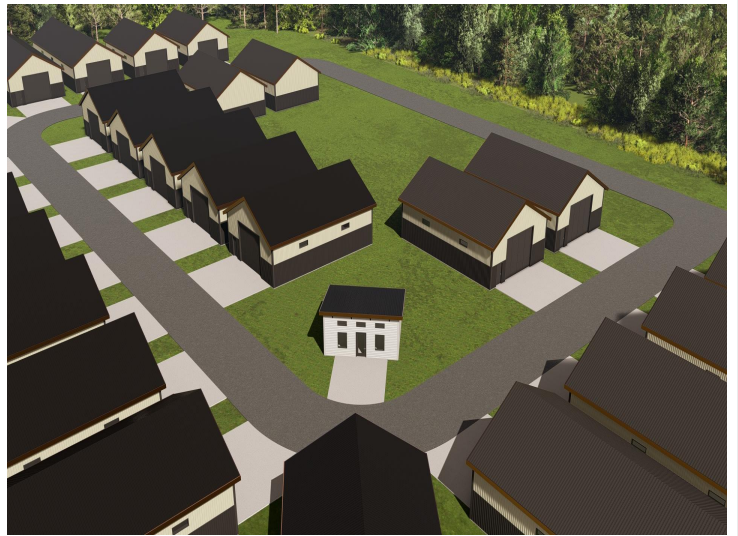

website: www.AffinityRealEstate.com | email: info@affinityrealestate.com | office: 218-237-3333 | fax: 218-237-3377



\$129,900
MLS 6777545 Land
#1 State Highway 371 NW
Backus MN 56435