



MLS 6781490 Lake Home

\$469,000

768 sq ft
3 bedrooms
1 baths

1155 Horseshoe Drive
Backus MN 56435

Waterfront: Horseshoe Lake
(Powers Twp.)

Status: Pending

Description:

Nestled in an up-north paradise, this charming three-bedroom, one-bath home on Horseshoe Lake in Backus, Minnesota offers a perfect retreat. The lake is renowned for its crystal-clear water and excellent fishing, providing endless opportunities for recreation. The property has a full basement that includes a workshop, offering plenty of space for hobbies and storage. It also comes with a storage shed, a gazebo for outdoor relaxation and a beautiful picnic area perfect for gatherings. A fantastic bonus is the extra 50-foot lot that accompanies the property, offering additional space and privacy. This is a rare find and a true lakeside gem.

Additional Details:

Year Built	1980
Lot Acres	1.35
Lot Dimensions	210x248x185x310
School District	2174
Taxes	\$1,352
Taxes with Assessments	\$1,418
Tax Year	2025

Additional Features:

Basement: Full, Unfinished, Walkout **Fuel:** Propane **Heat:** Baseboard, Wood Stove **Sewer:** Tank with Drainage Field **Water:** Submersible - 4 Inch, Drilled **Air Conditioning:** None

Driving Directions:

From Highway 371 go east on HWY 87 to E. Horseshoe Lake Road. Go north and follow the signs to #1155.



Listed By:
Heartland Real Estate

Affinity Real Estate Inc. participates in the Regional Multiple Listing Service of Minnesota, Inc Broker Reciprocity (sm) program, allowing us to display other broker's listings on our website. All properties are subject to prior sale, change or withdrawal.



Call Affinity Real Estate

218-237-3333

info@affinityrealestate.com



Affinity Real Estate - 600 Park Avenue South - Park Rapids MN 56470



website: www.AffinityRealEstate.com | email: info@affinityrealestate.com | office: 218-237-3333 | fax: 218-237-3377

Affinity
REAL ESTATE INC

\$469,000

MLS 6781490 Lake Home
1155 Horseshoe Drive
Backus MN 56435



website: www.AffinityRealEstate.com | email: info@affinityrealestate.com | office: 218-237-3333 | fax: 218-237-3377

Affinity
REAL ESTATE INC

\$469,000
MLS 6781490 Lake Home
1155 Horseshoe Drive
Backus MN 56435



website: www.AffinityRealEstate.com | email: info@affinityrealestate.com | office: 218-237-3333 | fax: 218-237-3377

Affinity
REAL ESTATE INC

\$469,000
MLS 6781490 Lake Home
1155 Horseshoe Drive
Backus MN 56435



website: www.AffinityRealEstate.com | email: info@affinityrealestate.com | office: 218-237-3333 | fax: 218-237-3377

Affinity
REAL ESTATE INC

\$469,000
MLS 6781490 Lake Home
1155 Horseshoe Drive
Backus MN 56435



website: www.AffinityRealEstate.com | email: info@affinityrealestate.com | office: 218-237-3333 | fax: 218-237-3377

Affinity
REAL ESTATE INC

\$469,000
MLS 6781490 Lake Home
1155 Horseshoe Drive
Backus MN 56435



website: www.AffinityRealEstate.com | email: info@affinityrealestate.com | office: 218-237-3333 | fax: 218-237-3377



\$469,000
MLS 6781490 Lake Home
1155 Horseshoe Drive
Backus MN 56435

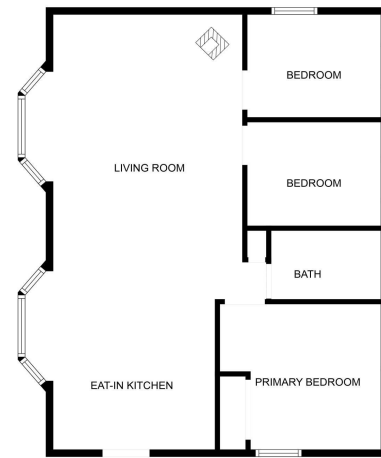

FLOOR PLAN CREATED BY CUBICASA APP. MEASUREMENTS DEEMED HIGHLY RELIABLE BUT NOT GUARANTEED.



website: www.AffinityRealEstate.com | email: info@affinityrealestate.com | office: 218-237-3333 | fax: 218-237-3377



\$469,000
MLS 6781490 Lake Home
1155 Horseshoe Drive
Backus MN 56435