



MLS 6798217 Lake Land

\$175,000

Description:

6 Acres on Little Moose Lake – Private, Wooded, and Ready to Build! Looking for a peaceful getaway spot? This 6-acre level wooded lot on Little Moose Lake, just north of Deer River, could be the perfect place. It offers a great building site with plenty of privacy and space to spread out. A permanent dock is already in place, so you can start enjoying the lake right away. Little Moose Lake is known for great fishing—walleye, muskie, northern, and crappie are all here. Whether you're dreaming of a cabin in the woods or just want a quiet place to escape, this lot has a lot to offer.

Additional Details:

Lot Acres	6
Lot Dimensions	6 acres x 400ff
School District	318
Taxes	(unreported)
Taxes with Assessments	(unreported)
Tax Year	2025

Additional Features:

Driving Directions:

From Grand Rapids, Hwy 38 N to L on CR 19 to R on 238 to property on R



Listed By:
CENTURY 21 LAND OF LAKES

Affinity Real Estate Inc. participates in the Regional Multiple Listing Service of Minnesota, Inc Broker Reciprocity (sm) program, allowing us to display other broker's listings on our website. All properties are subject to prior sale, change or withdrawal.



Call Affinity Real Estate

218-237-3333

info@affinityrealestate.com



Affinity Real Estate - 600 Park Avenue South - Park Rapids MN 56470

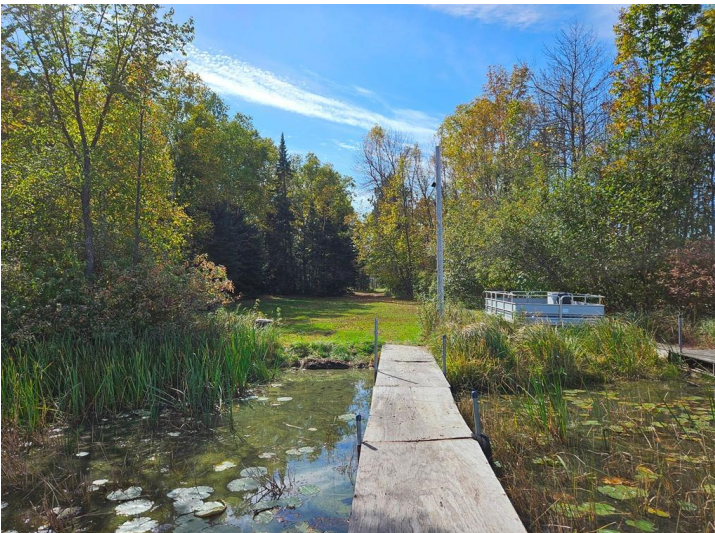

website: www.AffinityRealEstate.com | email: info@affinityrealestate.com | office: 218-237-3333 | fax: 218-237-3377



\$175,000

MLS 6798217 Lake Land
Lt 2 Blk 1 County Rd 238
Deer River MN 56636



website: www.AffinityRealEstate.com | email: info@affinityrealestate.com | office: 218-237-3333 | fax: 218-237-3377



\$175,000

MLS 6798217 Lake Land
Lt 2 Blk 1 County Rd 238
Deer River MN 56636



website: www.AffinityRealEstate.com | email: info@affinityrealestate.com | office: 218-237-3333 | fax: 218-237-3377



\$175,000

MLS 6798217 Lake Land
Lt 2 Blk 1 County Rd 238
Deer River MN 56636