



MLS 6806568 Land

\$189,000

0.04 Square Feet
Plat Designed

#27 TBD State Hwy 371
Backus MN 56435

Status: Active

Description:

Need just a little more space than your garage can handle? Whether it's for your boat, RV, car, snowmobile, or ATV — this finished to-be-built premium buildings have you covered! Own your space! With only 27 buildings available, now's the time to secure your spot. 32 x 48 steel building will be finished turn key with heat and a bathroom, 2 x 6 framing 16" on the center with 26-gauge painted steel, 2' overhangs, a concrete floor with in-floor heat run, floor drain and inflammable waste trap, four daylight windows, a 16' x 14' insulated 2" steel back overhead door with commercial opener, 32' x 20' concrete apron, 200 amp connected electric ready for hook up. Well and septic connections give you even more flexibility! Swing in and out with ease. Located right off Highway 371 in Backus, MN, this development will soon include paved road, and a common building with a kitchenette and bathroom. Perfect for cabin owners, hobbyists, or anyone needing extra space Up North!

Additional Details:

Lot Acres	0.04
Lot Dimensions	32x48
School District	2174
Taxes	\$196
Taxes with Assessments	\$196
Tax Year	2025

Additional Features:

Driving Directions:

Heading North on MN-371 coming into Backus. Property will be on the left just before leaving Backus. Follow signs.



Listed By:
Realty ONE Group Choice

Affinity Real Estate Inc. participates in the Regional Multiple Listing Service of Minnesota, Inc Broker Reciprocity (sm) program, allowing us to display other broker's listings on our website. All properties are subject to prior sale, change or withdrawal.



Call Affinity Real Estate

218-237-3333

info@affinityrealestate.com



Affinity Real Estate - 600 Park Avenue South - Park Rapids MN 56470

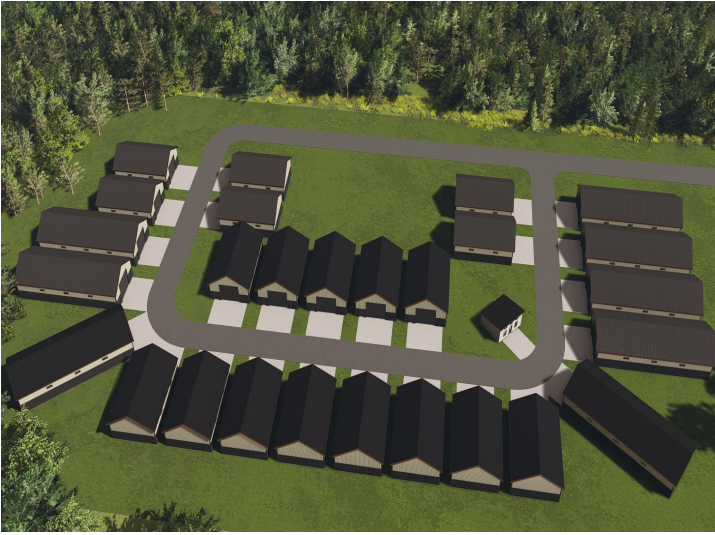

website: www.AffinityRealEstate.com | email: info@affinityrealestate.com | office: 218-237-3333 | fax: 218-237-3377



\$189,000
 MLS 6806568 Land
 #27 TBD State Hwy 371
 Backus MN 56435

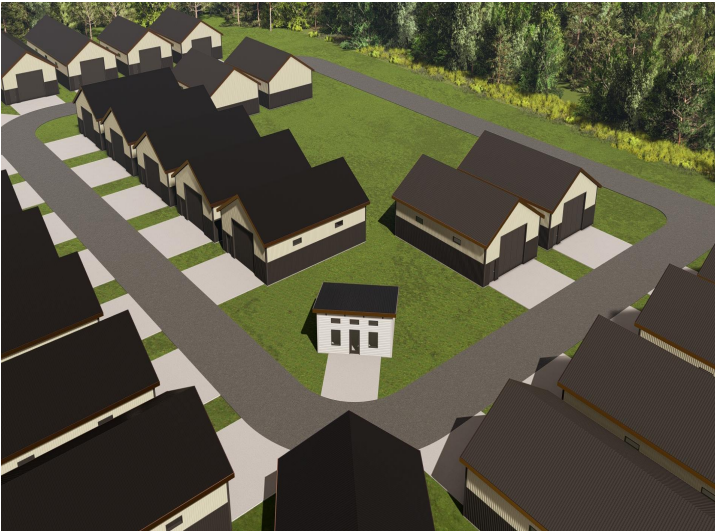

website: www.AffinityRealEstate.com | email: info@affinityrealestate.com | office: 218-237-3333 | fax: 218-237-3377



\$189,000
 MLS 6806568 Land
 #27 TBD State Hwy 371
 Backus MN 56435