



MLS 6823753 Residential

\$324,900

1,980 sq ft
4 bedrooms
2 baths

839 Bluff Avenue
Brainerd MN 56401

Status: Active

Description:

Beautiful home on Bluff Avenue in Brainerd's north side neighborhood — and the inside is truly cozy and charming. This home features geothermal-assisted, highly efficient heating, making it extremely economical to operate year-round. It is also located just minutes from the hospital and everything Brainerd has to offer; it offers convenience and quick access to essential services.

The home has been remodeled in the last several years, and nearly everything is newer: carpeting, laminate flooring, stainless steel kitchen appliances, kitchen counters and sink, the main-floor bath, most windows and doors, light fixtures, furnace, water heater, electrical panel, and interior paint. High ceilings and two gas fireplaces add warmth and charm, making this property stand out as well above average for the neighborhood in both features and condition.

The lot backs directly up to public DNR land that stretches all the way to the Mississippi River, providing wonderful wooded views and no neighbors behind you. The owners have also installed a private fenced-in backyard with a fire pit and a beautiful, quiet setting to enjoy.

The exterior is low-maintenance vinyl siding, and the garage (built in 1999) is in excellent condition and has a great workshop opportunity. This home offers comfort, efficiency, and an exceptional location that is hard to match in this price range.

Note: We will be adding new photos / video tour/ & full supplements in the next day.

Additional Details:

Year Built	1905
Lot Acres	0.19
Lot Dimensions	50x140
Garage Stalls	1
School District	181
Taxes	\$3,424
Taxes with Assessments	\$3,424

1  Listed By: 2025
MN Real Estate and Management LLC

Additional Features:

Affinity Real Estate Inc. participates in the Regional Multiple Listing Service of Minnesota, Inc. Broker Reciprocity (RM) program, allowing us to display the Broker's listings on our Website. All properties are subject to prior sale, change or withdrawal.

Driving Directions:



Call Affinity Real Estate

218-237-3333

info@affinityrealestate.com

Garage: 1, 1999 **Fireplace(s):** 2 **Geothermal:** Yes **Sewer:** City Sewer



Affinity Real Estate - 600 Park Avenue South - Park Rapids MN 56470

Bluff Ave runs on the North side of the neighborhood and this home is just north of St Frances church.



website: www.AffinityRealEstate.com | email: info@affinityrealestate.com | office: 218-237-3333 | fax: 218-237-3377



\$324,900
 MLS 6823753 Residential
 839 Bluff Avenue
 Brainerd MN 56401



website: www.AffinityRealEstate.com | email: info@affinityrealestate.com | office: 218-237-3333 | fax: 218-237-3377

Affinity
REAL ESTATE INC

\$324,900
MLS 6823753 Residential
839 Bluff Avenue
Brainerd MN 56401



website: www.AffinityRealEstate.com | email: info@affinityrealestate.com | office: 218-237-3333 | fax: 218-237-3377

Affinity
REAL ESTATE INC

\$324,900
MLS 6823753 Residential
839 Bluff Avenue
Brainerd MN 56401



website: www.AffinityRealEstate.com | email: info@affinityrealestate.com | office: 218-237-3333 | fax: 218-237-3377

Affinity
REAL ESTATE INC

\$324,900
MLS 6823753 Residential
839 Bluff Avenue
Brainerd MN 56401



website: www.AffinityRealEstate.com | email: info@affinityrealestate.com | office: 218-237-3333 | fax: 218-237-3377



\$324,900
 MLS 6823753 Residential
 839 Bluff Avenue
 Brainerd MN 56401

1ST FLOOR



2ND FLOOR



BASEMENT 1



TOTAL: 1980 sq. ft.
 BELOW GRADE: 0 sq. ft., 1st floor: 1106 sq. ft., 2nd floor: 874 sq. ft.
 EXCLUDED AREAS: STORAGE: 179 sq. ft., UTILITY: 213 sq. ft., UNDEFINED: 42 sq. ft.
 GARAGE: 362 sq. ft., WALLS: 229 sq. ft.

PLEASE PLAN CREATED BY CUBICOLA API. MEASUREMENTS DERIVED FROM A RELIABLE BUT NOT GUARANTEED.

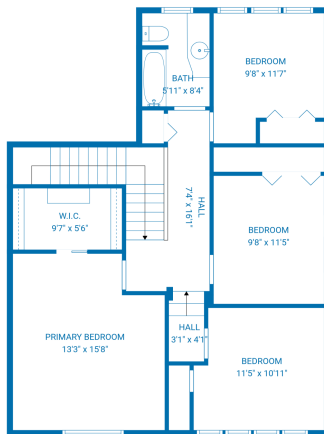

TOTAL: 1980 sq. ft.
 BELOW GRADE: 0 sq. ft., 1st floor: 1106 sq. ft., 2nd floor: 874 sq. ft.
 EXCLUDED AREAS: STORAGE: 179 sq. ft., UTILITY: 213 sq. ft., UNDEFINED: 42 sq. ft.
 GARAGE: 362 sq. ft., WALLS: 229 sq. ft.

PLEASE PLAN CREATED BY CUBICOLA API. MEASUREMENTS DERIVED FROM A RELIABLE BUT NOT GUARANTEED.

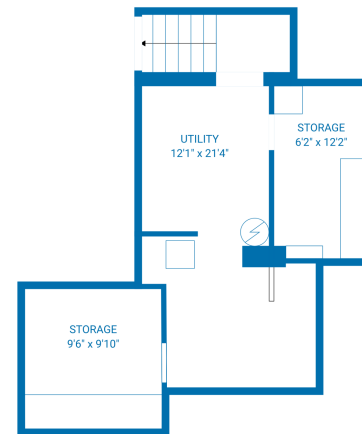

TOTAL: 1980 sq. ft.
 BELOW GRADE: 0 sq. ft., 1st floor: 1106 sq. ft., 2nd floor: 874 sq. ft.
 EXCLUDED AREAS: STORAGE: 179 sq. ft., UTILITY: 213 sq. ft., UNDEFINED: 42 sq. ft.
 GARAGE: 362 sq. ft., WALLS: 229 sq. ft.

PLEASE PLAN CREATED BY CUBICOLA API. MEASUREMENTS DERIVED FROM A RELIABLE BUT NOT GUARANTEED.

website: www.AffinityRealEstate.com | email: info@affinityrealestate.com | office: 218-237-3333 | fax: 218-237-3377



\$324,900
 MLS 6823753 Residential
 839 Bluff Avenue
 Brainerd MN 56401

website: www.AffinityRealEstate.com | email: info@affinityrealestate.com | office: 218-237-3333 | fax:218-237-3377



\$324,900
MLS 6823753 Residential
839 Bluff Avenue
Brainerd MN 56401

website: www.AffinityRealEstate.com | email: info@affinityrealestate.com | office: 218-237-3333 | fax:218-237-3377



\$324,900
MLS 6823753 Residential
839 Bluff Avenue
Brainerd MN 56401

website: www.AffinityRealEstate.com | email: info@affinityrealestate.com | office: 218-237-3333 | fax:218-237-3377



\$324,900
MLS 6823753 Residential
839 Bluff Avenue
Brainerd MN 56401

website: www.AffinityRealEstate.com | email: info@affinityrealestate.com | office: 218-237-3333 | fax:218-237-3377



\$324,900
MLS 6823753 Residential
839 Bluff Avenue
Brainerd MN 56401