



MLS 7005516 Land

\$79,000

1.03 Acres
Raw Land

TBD Gordon Circle
Crosslake MN 56442

Status: Active

Description:

Build your dream home or getaway in the heart of the Brainerd Lakes Area. This level, wooded lot is tucked away at the end of a quiet paved cul-de-sac in desirable Crosslake, offering privacy and a peaceful setting. Electric and natural gas are conveniently available at the road, making future development easy and efficient. Enjoy close proximity to the renowned of the Whitefish Chain of Lakes for boating, fishing, and recreation, along with excellent nearby golf courses, dining, and all the amenities & activities that Crosslake is well known for. Whether you're planning a year-round residence or a seasonal retreat, this property provides an ideal location with natural beauty and convenience combined.

Additional Details:

Lot Acres	1.03
Lot Dimensions	173x246x295x250
School District	909
Taxes	\$292
Taxes with Assessments	\$292
Tax Year	2025

Additional Features:

Driving Directions:

From Crosslake- South on CR 3 to Right on CR 103 approx 1.7 miles to Right on Happy Landing Rd to first Right on Gordon Circle to property on Right



Listed By:
Positive Realty

Affinity Real Estate Inc. participates in the Regional Multiple Listing Service of Minnesota, Inc Broker Reciprocity (sm) program, allowing us to display other broker's listings on our website. All properties are subject to prior sale, change or withdrawal.



Call Affinity Real Estate

218-237-3333

info@affinityrealestate.com



Affinity Real Estate - 600 Park Avenue South - Park Rapids MN 56470



website: www.AffinityRealEstate.com | email: info@affinityrealestate.com | office: 218-237-3333 | fax: 218-237-3377

Affinity
REAL ESTATE INC

\$79,000
MLS 7005516 Land
TBD Gordon Circle
Crosslake MN 56442



website: www.AffinityRealEstate.com | email: info@affinityrealestate.com | office: 218-237-3333 | fax:218-237-3377



\$79,000
MLS 7005516 Land
TBD Gordon Circle
Crosslake MN 56442



website: www.AffinityRealEstate.com | email: info@affinityrealestate.com | office: 218-237-3333 | fax: 218-237-3377



\$79,000
MLS 7005516 Land
TBD Gordon Circle
Crosslake MN 56442

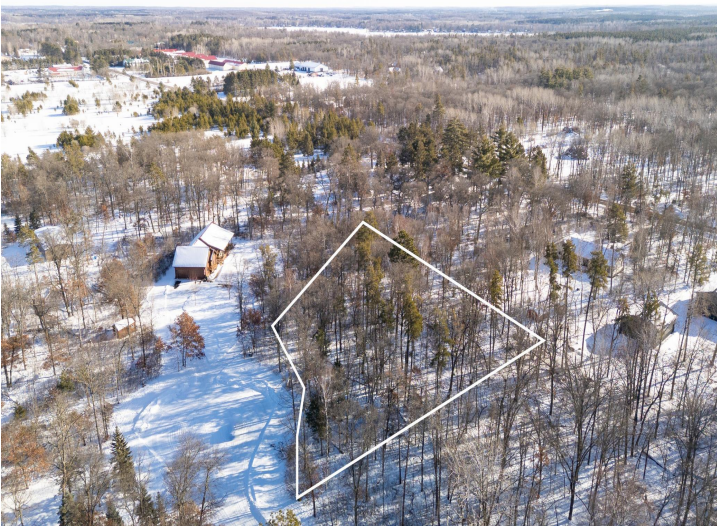

website: www.AffinityRealEstate.com | email: info@affinityrealestate.com | office: 218-237-3333 | fax:218-237-3377



\$79,000
MLS 7005516 Land
TBD Gordon Circle
Crosslake MN 56442