



MLS 7011147 Residential

**\$149,900**

2,504 sq ft  
5 bedrooms  
3 baths

38516 Blueberry View  
Menahga MN 56464

Status: Pending

**Description:**

This private country home is situated on a wooded 1.2-acre lot near Big Blueberry Lake, offering a quiet rural setting with convenient access to Menahga and Park Rapids. The property features five bedrooms and three bathrooms with a functional layout, including finished lower-level living space and additional unfinished areas for storage or future use. A new furnace has been installed, and a detached two-stall garage provides ample parking and utility space. Outdoor features include a deck and expansive yard, creating room for recreation and outdoor enjoyment. The setting offers a balance of privacy, space, and accessibility, well suited for year-round living or a northern Minnesota retreat.

**Additional Details:**

Year Built	2000
Lot Acres	1.217
Lot Dimensions	193x257x187x307
Garage Stalls	2
School District	2286
Taxes	\$2,066
Taxes with Assessments	\$2,066
Tax Year	2025

**Additional Features:**

**Basement:** Partially Finished **Fuel:** Array **Garage:** 2 **Heat:** Baseboard, Forced Air **Sewer:** Tank with Drainage Field **Water:** Drilled, Well **Air Conditioning:** Central Air

**Driving Directions:**

From Menahga, follow 1st St NE and Twin Lakes Rd 3.1 miles to 384th St. Drive 0.6 miles, turn right on E Blueberry Dr. to property on right.



Listed By:  
Gallery of Homes

Affinity Real Estate Inc. participates in the Regional Multiple Listing Service of Minnesota, Inc Broker Reciprocity (sm) program, allowing us to display other broker's listings on our website. All properties are subject to prior sale, change or withdrawal.



**Call Affinity Real Estate**

**218-237-3333**

**info@affinityrealestate.com**



**Affinity Real Estate - 600 Park Avenue South - Park Rapids MN 56470**





website: [www.AffinityRealEstate.com](http://www.AffinityRealEstate.com) | email: [info@affinityrealestate.com](mailto:info@affinityrealestate.com) | office: 218-237-3333 | fax: 218-237-3377



**\$149,900**  
 MLS 7011147 Residential  
 38516 Blueberry View  
 Menahga MN 56464





website: [www.AffinityRealEstate.com](http://www.AffinityRealEstate.com) | email: [info@affinityrealestate.com](mailto:info@affinityrealestate.com) | office: 218-237-3333 | fax: 218-237-3377

**Affinity**  
REAL ESTATE INC

**\$149,900**  
MLS 7011147 Residential  
38516 Blueberry View  
Menahga MN 56464





website: [www.AffinityRealEstate.com](http://www.AffinityRealEstate.com) | email: [info@affinityrealestate.com](mailto:info@affinityrealestate.com) | office: 218-237-3333 | fax: 218-237-3377

**Affinity**  
REAL ESTATE INC

**\$149,900**  
MLS 7011147 Residential  
38516 Blueberry View  
Menahga MN 56464





website: [www.AffinityRealEstate.com](http://www.AffinityRealEstate.com) | email: [info@affinityrealestate.com](mailto:info@affinityrealestate.com) | office: 218-237-3333 | fax: 218-237-3377



**\$149,900**  
 MLS 7011147 Residential  
 38516 Blueberry View  
 Menahga MN 56464





website: [www.AffinityRealEstate.com](http://www.AffinityRealEstate.com) | email: [info@affinityrealestate.com](mailto:info@affinityrealestate.com) | office: 218-237-3333 | fax: 218-237-3377



**\$149,900**  
 MLS 7011147 Residential  
 38516 Blueberry View  
 Menahga MN 56464



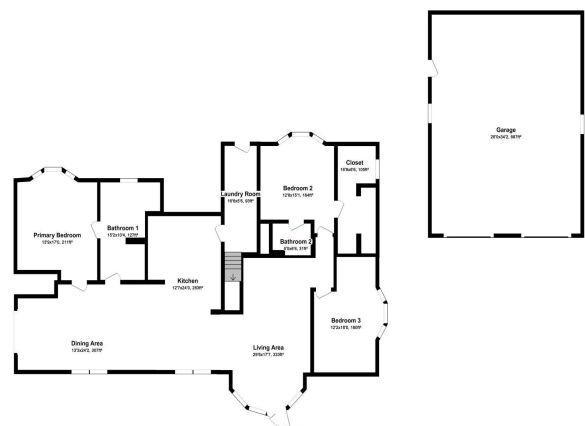

For illustration purposes only. Not to scale.

Ground Floor

website: [www.AffinityRealEstate.com](http://www.AffinityRealEstate.com) | email: [info@affinityrealestate.com](mailto:info@affinityrealestate.com) | office: 218-237-3333 | fax: 218-237-3377



**\$149,900**  
MLS 7011147 Residential  
38516 Blueberry View  
Menahga MN 56464



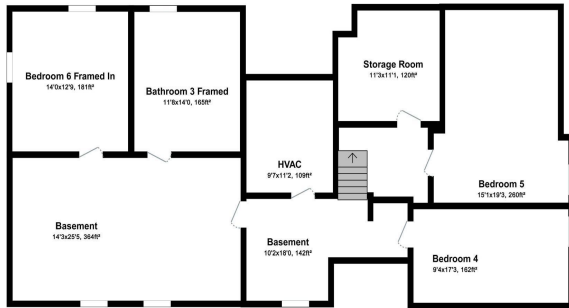

For illustration purposes only. Not to scale.

## Basement

website: [www.AffinityRealEstate.com](http://www.AffinityRealEstate.com) | email: [info@affinityrealestate.com](mailto:info@affinityrealestate.com) | office: 218-237-3333 | fax: 218-237-3377



**\$149,900**

MLS 7011147 Residential  
38516 Blueberry View  
Menahga MN 56464