



MLS 7042020 Residential

\$549,000

3,419 sq ft
5 bedrooms
4 baths

23259 Lampi Road
Cohasset MN 55721

Status: Coming Soon

Description:

Spacious Craftsman-inspired home on 3.5 private acres showcasing stunning woodwork throughout. A grand foyer and impressive staircase create a beautiful entry, with a built-in upper-level home office overlooking the space. Featuring 5 bedrooms and 4 baths, including a large primary suite with private deck. Convenient upper-level laundry. Enjoy outdoor living with a screened porch, multiple decks, and a fire ring. Beautiful natural setting with apple and maple trees, raspberry bushes, flower gardens, and abundant wildlife. Limited easement access to Pokegama Lake shoreline. Excellent storage with attached and detached garages; detached garage includes a heated woodstove room with access to an outdoor hockey rink. Newer roof (3 years) and concrete driveway. Quiet, scenic, and highly desirable location. PROFESSIONAL PHOTOS TO COME

Additional Details:

Year Built	1991
Lot Acres	3.29
Lot Dimensions	423x416
Garage Stalls	6
School District	1410
Taxes	\$5,082
Taxes with Assessments	\$5,082
Tax Year	2025

Additional Features:

Basement: Finished, Walkout, Wood **Fuel:** Array **Garage:** 6 **Heat:** Forced Air **Sewer:** Mound Septic **Water:** 4-Inch Submersible **Air Conditioning:** Central Air

Driving Directions:

Tioga

 Listed By:
COLDWELL BANKER NORTHWOODS

Affinity Real Estate Inc. participates in the Regional Multiple Listing Service of Minnesota, Inc Broker Reciprocity (sm) program, allowing us to display other broker's listings on our website. All properties are subject to prior sale, change or withdrawal.



Call Affinity Real Estate

218-237-3333

info@affinityrealestate.com



Affinity Real Estate - 600 Park Avenue South - Park Rapids MN 56470

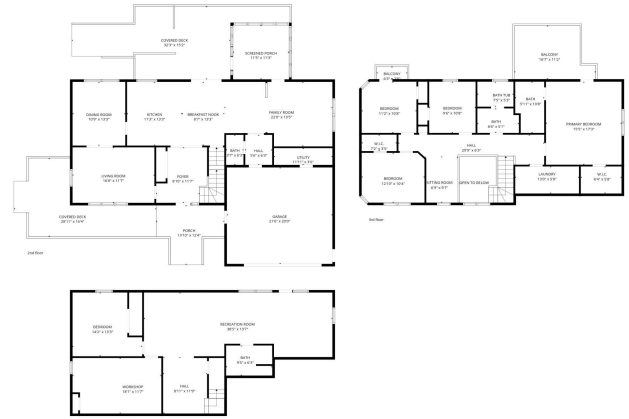

TOTAL: 3209 sq. ft.
 1st floor: 901 sq. ft. 2nd floor: 1114 sq. ft. 3rd floor: 1194 sq. ft.
 EXCLUDED AREAS: WORKSHOP: 209 sq. ft. GARAGE: 431 sq. ft. UTILITY: 42 sq. ft.
 SCREENED PORCH: 129 sq. ft. PORCH: 128 sq. ft. COVERED DECK: 694 sq. ft.
 BALCONY: 175 sq. ft. LOW CEILING: 24 sq. ft. OPEN TO BELOW: 66 sq. ft.
 WALLS: 281 sq. ft.

website: www.AffinityRealEstate.com | email: info@affinityrealestate.com | office: 218-237-3333 | fax: 218-237-3377



\$549,000
 MLS 7042020 Residential
 23259 Lampi Road
 Cohasset MN 55721