



MLS 7048375 Residential

\$1,489,900

3,550 sq ft
4 bedrooms
5 baths

3913 Bather DR #819 Grand View Lodge
Nisswa MN 56468

Status: Active

Description:

Custom 2022-built residence at the end of a private no-through road in North Pines at Grand View Lodge — delivering front-row views of the 3rd green of The Pines' Woods Nine. Offered fully furnished and turn-key: 4 bedrooms, 5 bathrooms, 3,718 sq ft, 3-car garage.

The main level opens with 9-ft ceilings and upgraded finishes throughout. A great room — warmed by the first of three stone, natural-gas fireplaces — flows into a showstopping four-season porch, where a wall of glass and a second stone fireplace frame panoramic fairway views year-round. The kitchen features natural-gas appliances, a large island, and custom cabinetry, with a separate formal dining room for holiday gatherings. Step onto the main-level deck, outfitted with a full dining set and plumbed natural-gas grill, then down to an 8-person firepit.

The primary suite anchors the main level as a private retreat — spa-inspired ensuite, walk-in closet, and elevated fairway views. A second main-level bedroom and bath accommodate visiting family or those who prefer single-level living.

The walk-out lower level is built for entertaining: a spacious family room with the third stone fireplace, a dedicated game room with wet bar, and two additional bedrooms — each with ensuite or adjacent bath. A covered patio beneath the porch includes a high-top table and is plumbed for a hot tub.

Every bedroom has its own bath. Professional irrigation, 3-car garage, and all furnishings included. Established rental history within Grand View Lodge's professional Rental Management Program; all reservations on the books must be honored for 12 months from closing. Rental data available upon request.

As part of the exclusive 27-lot North Pines Association, Unit 819 includes private community perks: a putting green, playset, and walking/biking paths connecting to downtown Nisswa and Grand View Lodge. A new trail connection to the south end of County Road 77 is currently under construction, with completion expected in spring 2026.

Ownership at North Pines opens the door to one of the Midwest's most storied resort experiences. Grand View Lodge has welcomed families to the shores of Gull Lake since 1916. The optional Rental Management Program through Grand View Lodge creates a true lock-and-leave experience — this property is currently enrolled in the Grand View Lodge Rental Management Agreement.

Office of Real Estate Services, the North Park Recreation Center, tennis courts, 2,600 feet of private sand beach, boat ramp, and Gull Lake Watersports program with an ideal location for the well-known CHAR Craft Steaks to the Northwoods Pub, 45 holes of championship golf (Woods, Marsh, and Lakes Nines) and The Preserve; the Glacial Waters Spa, and the Grand View Lodge Golf Course.



Call Affinity Real Estate

218-237-3333

info@affinityrealestate.com

in the Rental Management Agreement may purchase a resort membership to gain access to Grand View Lodge amenities.
©2026 Acme Webwerks - Affinity Real Estate Inc - Licensed in Minnesota - Brochure v.2019.05.23.2 - 216.73.217.42 - 2026.04.24 09:26:33 Page 1 of 12



website: www.AffinityRealEstate.com | email: info@affinityrealestate.com | office: 218-237-3333 | fax:218-237-3377



\$1,489,900
MLS 7048375 Residential
3913 Bather DR #819 Grand
View Lodge
Nisswa MN 56468



website: www.AffinityRealEstate.com | email: info@affinityrealestate.com | office: 218-237-3333 | fax:218-237-3377

Affinity
REAL ESTATE INC

\$1,489,900
MLS 7048375 Residential
3913 Bather DR #819 Grand
View Lodge
Nisswa MN 56468



website: www.AffinityRealEstate.com | email: info@affinityrealestate.com | office: 218-237-3333 | fax: 218-237-3377

Affinity
REAL ESTATE INC

\$1,489,900
MLS 7048375 Residential
3913 Bather DR #819 Grand
View Lodge
Nisswa MN 56468



website: www.AffinityRealEstate.com | email: info@affinityrealestate.com | office: 218-237-3333 | fax:218-237-3377

Affinity
REAL ESTATE INC

\$1,489,900
MLS 7048375 Residential
3913 Bather DR #819 Grand
View Lodge
Nisswa MN 56468



website: www.AffinityRealEstate.com | email: info@affinityrealestate.com | office: 218-237-3333 | fax:218-237-3377

Affinity
REAL ESTATE INC

\$1,489,900
MLS 7048375 Residential
3913 Bather DR #819 Grand
View Lodge
Nisswa MN 56468



website: www.AffinityRealEstate.com | email: info@affinityrealestate.com | office: 218-237-3333 | fax:218-237-3377



\$1,489,900
MLS 7048375 Residential
3913 Bather DR #819 Grand
View Lodge
Nisswa MN 56468



website: www.AffinityRealEstate.com | email: info@affinityrealestate.com | office: 218-237-3333 | fax:218-237-3377

Affinity
REAL ESTATE INC

\$1,489,900
MLS 7048375 Residential
3913 Bather DR #819 Grand
View Lodge
Nisswa MN 56468



website: www.AffinityRealEstate.com | email: info@affinityrealestate.com | office: 218-237-3333 | fax:218-237-3377



\$1,489,900
MLS 7048375 Residential
3913 Bather DR #819 Grand
View Lodge
Nisswa MN 56468



website: www.AffinityRealEstate.com | email: info@affinityrealestate.com | office: 218-237-3333 | fax:218-237-3377



\$1,489,900
MLS 7048375 Residential
3913 Bather DR #819 Grand
View Lodge
Nisswa MN 56468



website: www.AffinityRealEstate.com | email: info@affinityrealestate.com | office: 218-237-3333 | fax:218-237-3377



\$1,489,900
MLS 7048375 Residential
3913 Bather DR #819 Grand
View Lodge
Nisswa MN 56468

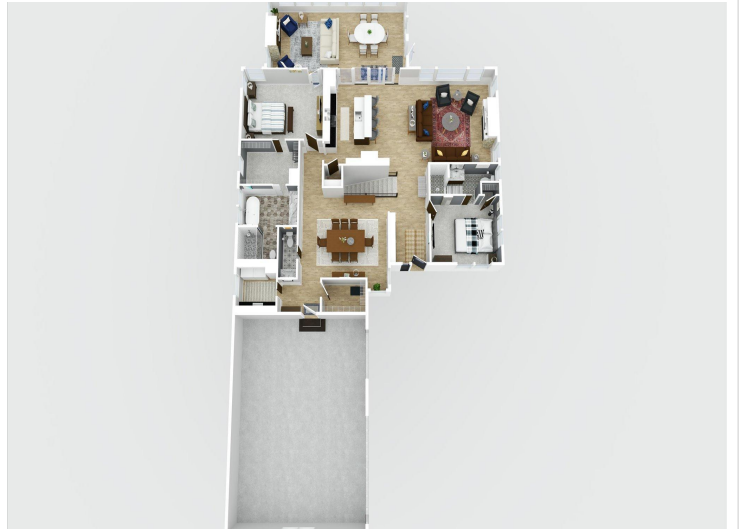

website: www.AffinityRealEstate.com | email: info@affinityrealestate.com | office: 218-237-3333 | fax:218-237-3377



\$1,489,900
MLS 7048375 Residential
3913 Bather DR #819 Grand
View Lodge
Nisswa MN 56468