



MLS 7050504 Residential

\$595,000

2,144 sq ft
4 bedrooms
1 baths

12745 County 18
Brainerd MN 56401

Status: Active

Description:

Welcome to 12745 County Rd 18 just minutes to Baxter or Pillager! This property provides over 6 acres and a 4,000 sqft shouse with multiple uses. With 16' sidewalls, 14' overhead doors on the south and west sides, the opportunity for expansion, storage, and use are unlimited. Inside you will find 40'x70' shop, currently split into a sandblasting area, paint bay area, workshop, and storage along with mechanical rooms. The house portion provides ample space for everyone. Currently designed as 4 bed design with an office above the shop and game room/bar set up overlooking the living room. Looking for a new business location with easy access to 210 and Brainerd/Baxter or looking for a place for everyone and all the toys, here is your spot! Schedule a private showing today!

Additional Details:

Year Built	2025
Lot Acres	6.25
Lot Dimensions	813x335
Garage Stalls	6
School District	726
Taxes	\$1,114
Taxes with Assessments	\$1,200
Tax Year	2026

Additional Features:

Basement: None **Fuel:** Array **Garage:** 6 **Heat:** Boiler, In-Floor Heating **Sewer:** Septic System Compliant - Yes, Tank with Drainage Field
Water: Drilled **Air Conditioning:** None

Driving Directions:

From Hwy 210



Listed By:
Edina Realty, Inc.

Affinity Real Estate Inc. participates in the Regional Multiple Listing Service of Minnesota, Inc Broker Reciprocity (sm) program, allowing us to display other broker's listings on our website. All properties are subject to prior sale, change or withdrawal.



Call Affinity Real Estate

218-237-3333

info@affinityrealestate.com



Affinity Real Estate - 600 Park Avenue South - Park Rapids MN 56470



website: www.AffinityRealEstate.com | email: info@affinityrealestate.com | office: 218-237-3333 | fax: 218-237-3377

Affinity
REAL ESTATE INC

\$595,000
MLS 7050504 Residential
12745 County 18
Brainerd MN 56401



website: www.AffinityRealEstate.com | email: info@affinityrealestate.com | office: 218-237-3333 | fax: 218-237-3377

Affinity
REAL ESTATE INC

\$595,000
MLS 7050504 Residential
12745 County 18
Brainerd MN 56401



website: www.AffinityRealEstate.com | email: info@affinityrealestate.com | office: 218-237-3333 | fax:218-237-3377

Affinity
REAL ESTATE INC

\$595,000
MLS 7050504 Residential
12745 County 18
Brainerd MN 56401



website: www.AffinityRealEstate.com | email: info@affinityrealestate.com | office: 218-237-3333 | fax:218-237-3377

Affinity
REAL ESTATE INC

\$595,000
MLS 7050504 Residential
12745 County 18
Brainerd MN 56401



website: www.AffinityRealEstate.com | email: info@affinityrealestate.com | office: 218-237-3333 | fax:218-237-3377



\$595,000
MLS 7050504 Residential
12745 County 18
Brainerd MN 56401

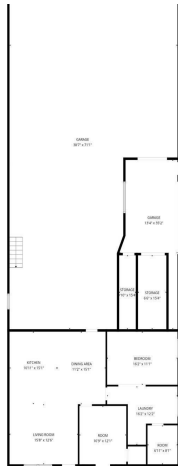
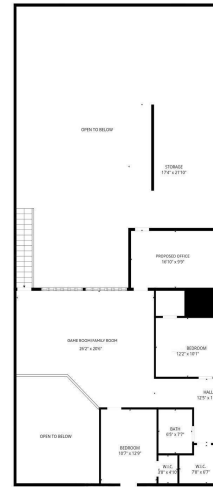

website: www.AffinityRealEstate.com | email: info@affinityrealestate.com | office: 218-237-3333 | fax: 218-237-3377



\$595,000
 MLS 7050504 Residential
 12745 County 18
 Brainerd MN 56401