



MLS 7053132 Residential

\$309,000

2,052 sq ft
4 bedrooms
2 baths

12755 57th Avenue
Motley MN 56466

Status: Active

Description:

A lush 9.94 acres of woods is home to this immaculate manufactured home with 4 bedrooms, 2 full baths, a bonus family room and a great 30 x 48 insulated and heated garage/shop. The updated kitchen includes granite countertops and a granite topped center island. Numerous recent upgrades, including a new roof, new toilets, new faucets, new range hood and a new dishwasher, all of which were done in 2023. The refrigerator was new in 2023. The washer and dryer were new in 2020 and range and microwave in 2021. Conveniently located between Pillager and Motley, the site has a mowed (obviously optional) trail system and even includes an elevated deer stand. The garage/shop is wired for 220 and has its' own propane tank. CTC fiber optic is available.

Additional Details:

Year Built	2004
Lot Acres	9.94
Lot Dimensions	331 x 1302 x 332 x 1303
Garage Stalls	4
School District	1062
Taxes	\$1,818
Taxes with Assessments	\$1,884
Tax Year	2025

Additional Features:

Basement: Crawl Space **Fuel:** Array **Garage:** 4 **Heat:** Forced Air **Sewer:** Septic System Compliant - Yes **Water:** Drilled **Air Conditioning:** Central Air

Driving Directions:

Hwy 210 West of Pillager to 57th Ave SW, Go South one block to home on right



Listed By:
Century 21 Brainerd Realty

Affinity Real Estate Inc. participates in the Regional Multiple Listing Service of Minnesota, Inc Broker Reciprocity (sm) program, allowing us to display other broker's listings on our website. All properties are subject to prior sale, change or withdrawal.



Call Affinity Real Estate

218-237-3333

info@affinityrealestate.com



Affinity Real Estate - 600 Park Avenue South - Park Rapids MN 56470

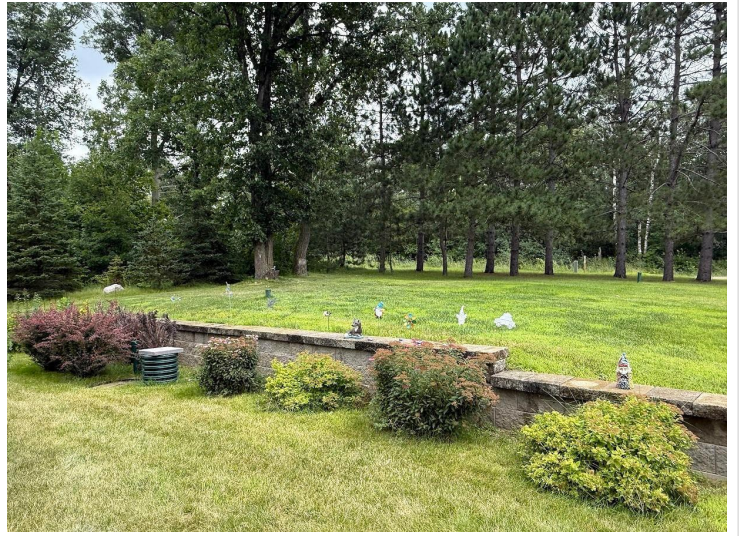

website: www.AffinityRealEstate.com | email: info@affinityrealestate.com | office: 218-237-3333 | fax:218-237-3377



\$309,000
MLS 7053132 Residential
12755 57th Avenue
Motley MN 56466



website: www.AffinityRealEstate.com | email: info@affinityrealestate.com | office: 218-237-3333 | fax:218-237-3377



\$309,000
MLS 7053132 Residential
12755 57th Avenue
Motley MN 56466



website: www.AffinityRealEstate.com | email: info@affinityrealestate.com | office: 218-237-3333 | fax:218-237-3377

Affinity
REAL ESTATE INC

\$309,000
MLS 7053132 Residential
12755 57th Avenue
Motley MN 56466



website: www.AffinityRealEstate.com | email: info@affinityrealestate.com | office: 218-237-3333 | fax: 218-237-3377

Affinity
REAL ESTATE INC

\$309,000
MLS 7053132 Residential
12755 57th Avenue
Motley MN 56466



website: www.AffinityRealEstate.com | email: info@affinityrealestate.com | office: 218-237-3333 | fax:218-237-3377

Affinity
REAL ESTATE INC

\$309,000
MLS 7053132 Residential
12755 57th Avenue
Motley MN 56466



website: www.AffinityRealEstate.com | email: info@affinityrealestate.com | office: 218-237-3333 | fax:218-237-3377



\$309,000
MLS 7053132 Residential
12755 57th Avenue
Motley MN 56466



website: www.AffinityRealEstate.com | email: info@affinityrealestate.com | office: 218-237-3333 | fax:218-237-3377



\$309,000
MLS 7053132 Residential
12755 57th Avenue
Motley MN 56466