



MLS 7055515 Land

**\$119,900**

1536 Square Feet  
Other

27 State Highway 371 NW  
Backus MN 56435

Status: Active

**Description:**

Need just a little more space than your garage can handle? Whether it's for your boat, RV, car, snowmobile, or ATV — these premium buildings have you covered! Own your space! With only 26 buildings available, now's the time to secure your spot. Each 32x48 steel building features a concrete floor with in-floor heat tubing ran, four daylight windows, a 16x14 insulated overhead door, commercial door opener, and connected electric. Swing in and out with ease located right off Highway 371 in Backus, MN. Perfect for cabin owners, hobbyists, or anyone needing extra space Up North!

**Additional Details:**

Lot Acres	1536
Lot Dimensions	32x82
School District	1065
Taxes	\$4
Taxes with Assessments	\$4
Tax Year	2025

**Additional Features:**

**Driving Directions:**

Heading North on MN-371 coming into Backus. Property will be on the left just before leaving Backus. Follow signs.



Listed By:  
Realty ONE Group Choice

Affinity Real Estate Inc. participates in the Regional Multiple Listing Service of Minnesota, Inc Broker Reciprocity (sm) program, allowing us to display other broker's listings on our website. All properties are subject to prior sale, change or withdrawal.



Call Affinity Real Estate

**218-237-3333**

[info@affinityrealestate.com](mailto:info@affinityrealestate.com)



Affinity Real Estate - 600 Park Avenue South - Park Rapids MN 56470

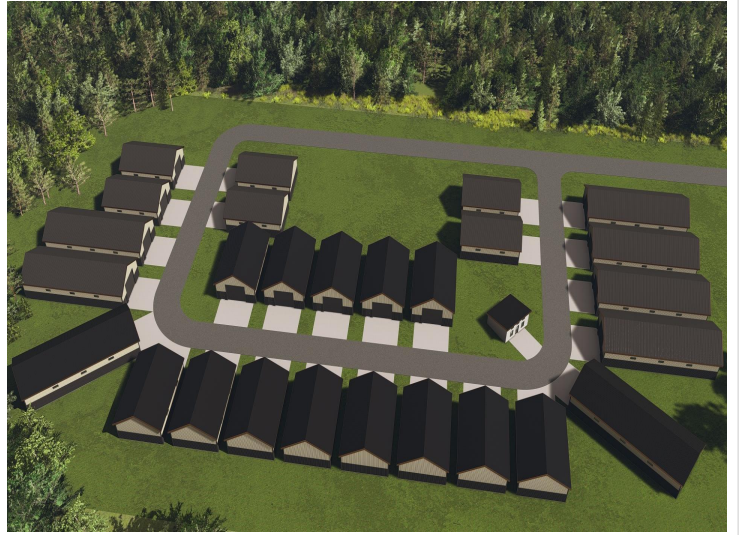

website: [www.AffinityRealEstate.com](http://www.AffinityRealEstate.com) | email: [info@affinityrealestate.com](mailto:info@affinityrealestate.com) | office: 218-237-3333 | fax:218-237-3377



**\$119,900**  
MLS 7055515 Land  
27 State Highway 371 NW  
Backus MN 56435



website: [www.AffinityRealEstate.com](http://www.AffinityRealEstate.com) | email: [info@affinityrealestate.com](mailto:info@affinityrealestate.com) | office: 218-237-3333 | fax:218-237-3377

**Affinity**  
REAL ESTATE INC

**\$119,900**  
MLS 7055515 Land  
27 State Highway 371 NW  
Backus MN 56435



website: [www.AffinityRealEstate.com](http://www.AffinityRealEstate.com) | email: [info@affinityrealestate.com](mailto:info@affinityrealestate.com) | office: 218-237-3333 | fax:218-237-3377



**\$119,900**  
MLS 7055515 Land  
27 State Highway 371 NW  
Backus MN 56435