



MLS 7058157 Residential

\$105,000

1,848 sq ft
4 bedrooms
2 baths

327 2ND Street
Barnesville MN 56514

Status: Active

Description:

Spacious two-story home offering 4 bedrooms, 2 bathrooms, and approximately 1,800 finished square feet on a large double lot overlooking a creek. Features include a detached 2-car garage, deck, and functional layout with main-level living areas and additional finished space in the basement. Property is connected to city water and sewer and includes forced air heat with central air conditioning. Convenient in-town location with easy access to local amenities.

Additional Details:

| | |
|------------------------|--------------------------|
| Year Built | 1910 |
| Lot Acres | 0.63 |
| Lot Dimensions | lot 23 - 50x200 & 80x213 |
| Garage Stalls | 2 |
| School District | 146 |
| Taxes | \$2,480 |
| Taxes with Assessments | \$2,480 |
| Tax Year | 2026 |

Additional Features:

Basement: Block **Fuel:** Natural Gas **Garage:** 2 **Heat:** Forced Air **Sewer:** City Sewer/Connected **Water:** City Water/Connected **Air Conditioning:** Central Air

Driving Directions:

North of 2nd Ave and west side of 2nd St



Listed By:
Gallery of Homes

Affinity Real Estate Inc. participates in the Regional Multiple Listing Service of Minnesota, Inc Broker Reciprocity (sm) program, allowing us to display other broker's listings on our website. All properties are subject to prior sale, change or withdrawal.



Call Affinity Real Estate

218-237-3333

info@affinityrealestate.com



Affinity Real Estate - 600 Park Avenue South - Park Rapids MN 56470



website: www.AffinityRealEstate.com | email: info@affinityrealestate.com | office: 218-237-3333 | fax: 218-237-3377

Affinity
REAL ESTATE INC

\$105,000
MLS 7058157 Residential
327 2ND Street
Barnesville MN 56514



website: www.AffinityRealEstate.com | email: info@affinityrealestate.com | office: 218-237-3333 | fax:218-237-3377

Affinity
REAL ESTATE INC

\$105,000
MLS 7058157 Residential
327 2ND Street
Barnesville MN 56514



website: www.AffinityRealEstate.com | email: info@affinityrealestate.com | office: 218-237-3333 | fax:218-237-3377

Affinity
REAL ESTATE INC

\$105,000
MLS 7058157 Residential
327 2ND Street
Barnesville MN 56514



website: www.AffinityRealEstate.com | email: info@affinityrealestate.com | office: 218-237-3333 | fax:218-237-3377

Affinity
REAL ESTATE INC

\$105,000
MLS 7058157 Residential
327 2ND Street
Barnesville MN 56514



website: www.AffinityRealEstate.com | email: info@affinityrealestate.com | office: 218-237-3333 | fax:218-237-3377



\$105,000
MLS 7058157 Residential
327 2ND Street
Barnesville MN 56514



website: www.AffinityRealEstate.com | email: info@affinityrealestate.com | office: 218-237-3333 | fax: 218-237-3377

Affinity
REAL ESTATE INC

\$105,000
MLS 7058157 Residential
327 2ND Street
Barnesville MN 56514



website: www.AffinityRealEstate.com | email: info@affinityrealestate.com | office: 218-237-3333 | fax:218-237-3377



\$105,000
MLS 7058157 Residential
327 2ND Street
Barnesville MN 56514



TOTAL: 1426 sq. ft.
 Basement: 229 sq. ft., 1st floor: 690 sq. ft., 2nd floor: 507 sq. ft.
 EXCLUDED AREAS: UTILITY: 140 sq. ft., BASEMENT: 187 sq. ft., DECK: 303 sq. ft.,
 PORCH: 91 sq. ft., UNDEFINED: 30 sq. ft., LOW CEILING: 97 sq. ft.,
 WALLS: 163 sq. ft.

Floor Plan Created By Calixtus App. Measurements Generated By Velibor But Not Guaranteed.

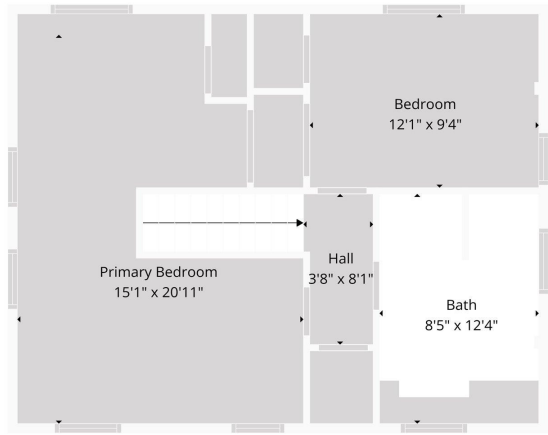

TOTAL: 1426 sq. ft.
 Basement: 229 sq. ft., 1st floor: 690 sq. ft., 2nd floor: 507 sq. ft.
 EXCLUDED AREAS: UTILITY: 140 sq. ft., BASEMENT: 187 sq. ft., DECK: 303 sq. ft.,
 PORCH: 91 sq. ft., UNDEFINED: 30 sq. ft., LOW CEILING: 97 sq. ft.,
 WALLS: 163 sq. ft.

Floor Plan Created By Calixtus App. Measurements Generated By Velibor But Not Guaranteed.

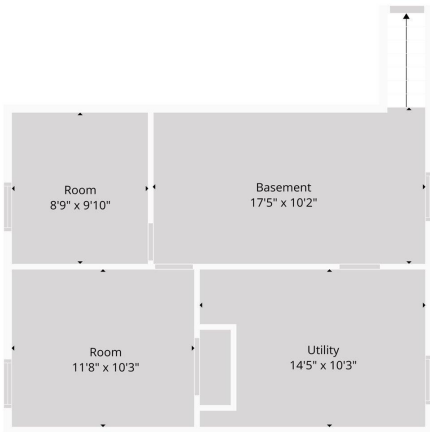

TOTAL: 1426 sq. ft.
 Basement: 229 sq. ft., 1st floor: 690 sq. ft., 2nd floor: 507 sq. ft.
 EXCLUDED AREAS: UTILITY: 140 sq. ft., BASEMENT: 187 sq. ft., DECK: 303 sq. ft.,
 PORCH: 91 sq. ft., UNDEFINED: 30 sq. ft., LOW CEILING: 97 sq. ft.,
 WALLS: 163 sq. ft.

Floor Plan Created By Calixtus App. Measurements Generated By Velibor But Not Guaranteed.

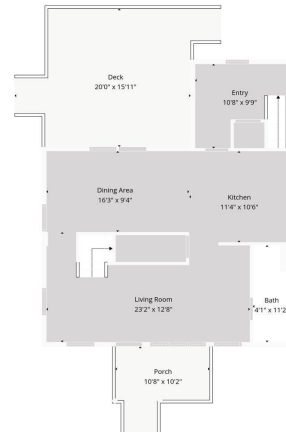

TOTAL: 1426 sq. ft.
 Basement: 229 sq. ft., 1st floor: 690 sq. ft., 2nd floor: 507 sq. ft.
 EXCLUDED AREAS: UTILITY: 140 sq. ft., BASEMENT: 187 sq. ft., DECK: 303 sq. ft.,
 PORCH: 91 sq. ft., UNDEFINED: 30 sq. ft., LOW CEILING: 97 sq. ft.,
 WALLS: 163 sq. ft.

Floor Plan Created By Calixtus App. Measurements Generated By Velibor But Not Guaranteed.

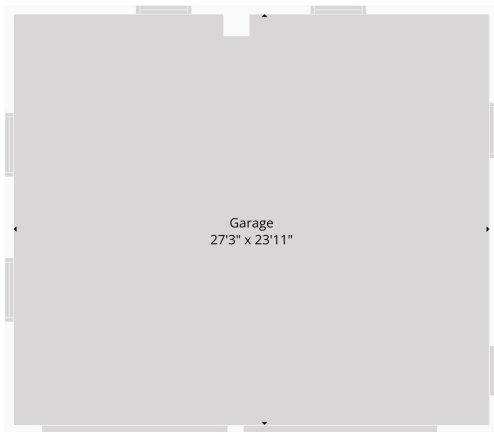

TOTAL: 0 sq. ft.
 1st floor: 0 sq. ft.,
 EXCLUDED AREAS: GARAGE: 653 sq. ft., WALLS: 52 sq. ft.

Floor Plan Created By Calixtus App. Measurements Generated By Velibor But Not Guaranteed.

website: www.AffinityRealEstate.com | email: info@affinityrealestate.com | office: 218-237-3333 | fax: 218-237-3377



\$105,000
 MLS 7058157 Residential
 327 2ND Street
 Barnesville MN 56514