

MLS 7074168 Lake Land

\$150,000

Description:

SOLD PRIOR TO LIST. DO NOT WALK PROPERTY WITHOUT AN APPOINTMENT. Incredible 4+ acre parcel located in the heart of Lake Country in the BLA. Ready for you to bring your vision to life on premier Lake Edward with generous frontage. Enjoy excellent fishing with species such as walleye, perch, crappie, bass, northern, and sunnies. With a maximum depth of 75 feet, over 2,500 acres of water and 11 miles of shoreline, there's no shortage of recreation to explore. Partially cleared, this lot offers a great starting point and is just minutes from Nisswa, Pequot Lakes, Crosslake, and Brainerd for shopping, dining, and entertainment. Nearby favorites include Mission Tavern and B Merri. Please note, access to the water may require navigating through reeds. All showings must be scheduled.

Additional Details:

Lot Acres	4.38
Lot Dimensions	1473x226x1358x158
School District	181
Taxes	\$92
Taxes with Assessments	\$92
Tax Year	2025

Additional Features:

Driving Directions:

From Hwy 210 in Brainerd, north 8.5 miles on 8th Ave NE/Mill Avenue/CO RD 3 to right at "Y" to stay on CO RD 3, property will be on the left.



Listed By:
Real Broker, LLC

Affinity Real Estate Inc. participates in the Regional Multiple Listing Service of Minnesota, Inc Broker Reciprocity (sm) program, allowing us to display other broker's listings on our website. All properties are subject to prior sale, change or withdrawal.



Call Affinity Real Estate

218-237-3333

info@affinityrealestate.com



Affinity Real Estate - 600 Park Avenue South - Park Rapids MN 56470

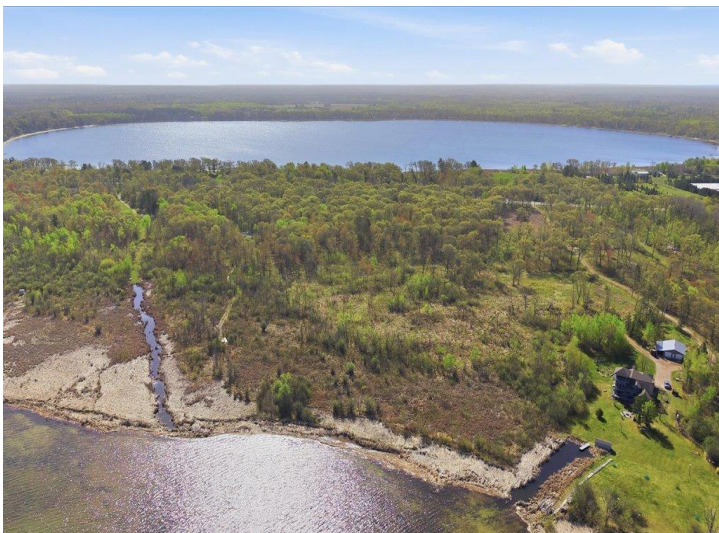

website: www.AffinityRealEstate.com | email: info@affinityrealestate.com | office: 218-237-3333 | fax:218-237-3377



\$150,000
MLS 7074168 Lake Land
TBD, LOT 3 County Rd 3
Nisswa MN 56468



website: www.AffinityRealEstate.com | email: info@affinityrealestate.com | office: 218-237-3333 | fax:218-237-3377



\$150,000
MLS 7074168 Lake Land
TBD, LOT 3 County Rd 3
Nisswa MN 56468



website: www.AffinityRealEstate.com | email: info@affinityrealestate.com | office: 218-237-3333 | fax:218-237-3377



\$150,000
MLS 7074168 Lake Land
TBD, LOT 3 County Rd 3
Nisswa MN 56468



website: www.AffinityRealEstate.com | email: info@affinityrealestate.com | office: 218-237-3333 | fax:218-237-3377



\$150,000
MLS 7074168 Lake Land
TBD, LOT 3 County Rd 3
Nisswa MN 56468