



MLS 7074611 Residential

**\$299,000**

1,341 sq ft  
3 bedrooms  
2 baths

20118 County Road 12  
Ironton MN 56455

Status: Coming Soon

**Description:**

Remodeled 3-bedroom home on 9.4 acres with a distinctive A-frame inspired entry and a setting that offers quick access to both Brainerd and Crosby. The main level has been extensively updated with a modern kitchen featuring new cabinetry, countertops, and appliances, while the open living and dining area combines tongue-and-groove ceilings with updated flooring, lighting, fixtures, trim, and custom accent wall details that give the home a warm, inviting feel. Spacious full bath includes a double vanity and updated finishes throughout. Walkout basement provides abundant storage, workshop, and utility space with flexibility for hobbies, equipment, or future use. Detached 3-stall garage and new drilled well add to the functionality and value. Located near Serpent Lake, CRMC, the Cuyuna Mountain Bike Trails, and many of the area's best lakes and outdoor recreation opportunities.

**Additional Details:**

Year Built	1972
Lot Acres	9.4
Lot Dimensions	Irregular - See Survey
Garage Stalls	3
School District	182
Taxes	\$1,779
Taxes with Assessments	\$1,804
Tax Year	2026

**Additional Features:**

**Fuel:** Propane, Wood **Heat:** Baseboard, Hot Water, Outdoor Boiler

**Driving Directions:**

Directions: From the 4-way stop in Crosby head south on 3rd Ave NW/Hwy 6, turn left onto County Rd 28, head south then turn right onto CR-12 (Deerwood Shortcut), go 2.2 miles to 20118 CR-12. Once you pull into the driveway, garage and house are to the right.



Listed By:  
Northland Sotheby's International Realty

Affinity Real Estate Inc. participates in the Regional Multiple Listing Service of Minnesota, Inc Broker Reciprocity (sm) program, allowing us to display other broker's listings on our website. All properties are subject to prior sale, change or withdrawal.



**Call Affinity Real Estate**

**218-237-3333**

**info@affinityrealestate.com**



**Affinity Real Estate - 600 Park Avenue South - Park Rapids MN 56470**



website: [www.AffinityRealEstate.com](http://www.AffinityRealEstate.com) | email: [info@affinityrealestate.com](mailto:info@affinityrealestate.com) | office: 218-237-3333 | fax:218-237-3377



**\$299,000**  
MLS 7074611 Residential  
20118 County Road 12  
Ironton MN 56455



website: [www.AffinityRealEstate.com](http://www.AffinityRealEstate.com) | email: [info@affinityrealestate.com](mailto:info@affinityrealestate.com) | office: 218-237-3333 | fax: 218-237-3377

**Affinity**  
REAL ESTATE INC

**\$299,000**  
MLS 7074611 Residential  
20118 County Road 12  
Ironton MN 56455

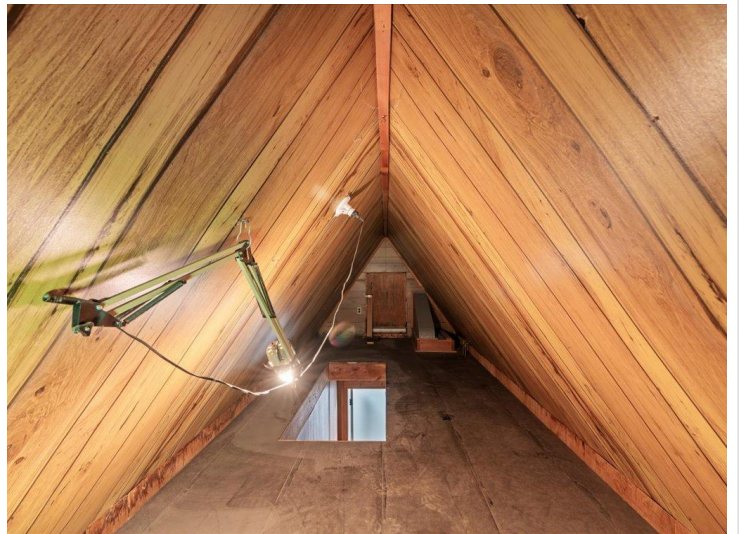

website: [www.AffinityRealEstate.com](http://www.AffinityRealEstate.com) | email: [info@affinityrealestate.com](mailto:info@affinityrealestate.com) | office: 218-237-3333 | fax:218-237-3377

**Affinity**  
REAL ESTATE INC

**\$299,000**  
MLS 7074611 Residential  
20118 County Road 12  
Ironton MN 56455



website: [www.AffinityRealEstate.com](http://www.AffinityRealEstate.com) | email: [info@affinityrealestate.com](mailto:info@affinityrealestate.com) | office: 218-237-3333 | fax:218-237-3377



**\$299,000**  
MLS 7074611 Residential  
20118 County Road 12  
Ironton MN 56455



website: [www.AffinityRealEstate.com](http://www.AffinityRealEstate.com) | email: [info@affinityrealestate.com](mailto:info@affinityrealestate.com) | office: 218-237-3333 | fax:218-237-3377

**Affinity**  
REAL ESTATE INC

**\$299,000**  
MLS 7074611 Residential  
20118 County Road 12  
Ironton MN 56455

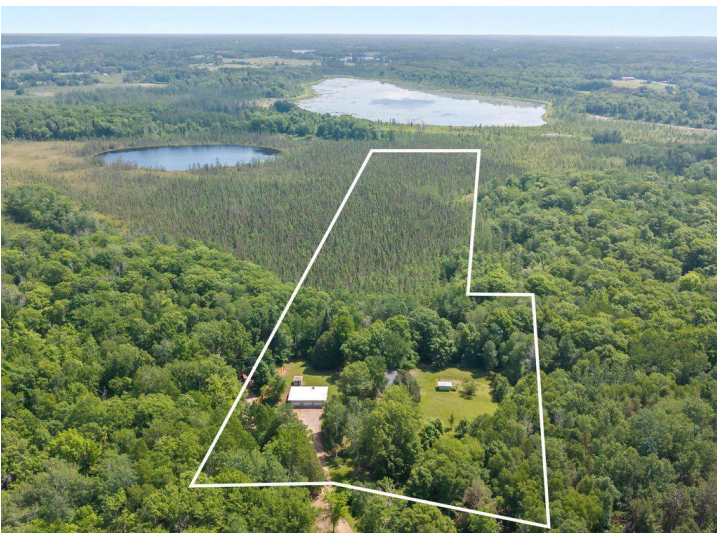

website: [www.AffinityRealEstate.com](http://www.AffinityRealEstate.com) | email: [info@affinityrealestate.com](mailto:info@affinityrealestate.com) | office: 218-237-3333 | fax:218-237-3377



**\$299,000**  
MLS 7074611 Residential  
20118 County Road 12  
Ironton MN 56455