



MLS 7076961 Lake Home

\$895,000

2,632 sq ft
3 bedrooms
3 baths

6150 Inland Trails Road
Pequot Lakes MN 56472

Waterfront: Middle Cullen

Status: Pending

Description:

Enjoy rare privacy on this 2.9-acre Middle Cullen Lake lot with 160' of shoreline privacy, just 2 miles from downtown Nisswa. The home offers a walkout lower-level family room with a wood-burning fireplace, and full kitchen and bar.

The main-floor features a spacious living and dining area with gas fireplace, and a primary bedroom suite. Updated kitchen features granite countertops, breakfast bar and quality stainless steel appliances with wall oven and induction cooktop.

Relax on the large lakeside deck overlooking Middle Cullen Lake, part of a highly desirable chain known for fishing, wildlife, and tranquility. There is a two car heated and insulated garage with an additional workshop stall and an asphalt driveway. A lawn irrigation system will keep your yard looking great!

If wake boarding and party boating isn't your thing, then this quiet, peaceful home on the Cullen chain is where you belong!

Additional Details:

Year Built	1968
Lot Acres	2.9
Lot Dimensions	160x845x125x830
Garage Stalls	2
School District	186
Taxes	\$7,492
Taxes with Assessments	\$7,492
Tax Year	2026

Additional Features:

Basement: Block, Finished, Full, Walkout **Fuel:** Natural Gas, Wood **Garage:** 2 **Heat:** Forced Air, Fireplace(s) **Sewer:** Septic System Compliant - Yes, Tank with Drainage Field **Water:** 4-Inch Submersible, Drilled, Well **Air Conditioning:** Central Air

Driving Directions:

From downtown Nisswa take Church St to Poplar, go east on Poplar to East Cullen lake Rd, follow Inland trails Rd, stay right to address.



Listed By:
Kurilla Real Estate LTD

Affinity Real Estate Inc. participates in the Regional Multiple Listing Service of Minnesota, Inc Broker Reciprocity (sm) program, allowing us to display other broker's listings on our website. All properties are subject to prior sale, change or withdrawal.



Call Affinity Real Estate

218-237-3333

info@affinityrealestate.com



Affinity Real Estate - 600 Park Avenue South - Park Rapids MN 56470



website: www.AffinityRealEstate.com | email: info@affinityrealestate.com | office: 218-237-3333 | fax:218-237-3377



\$895,000
MLS 7076961 Lake Home
6150 Inland Trails Road
Pequot Lakes MN 56472



website: www.AffinityRealEstate.com | email: info@affinityrealestate.com | office: 218-237-3333 | fax:218-237-3377



\$895,000
MLS 7076961 Lake Home
6150 Inland Trails Road
Pequot Lakes MN 56472



website: www.AffinityRealEstate.com | email: info@affinityrealestate.com | office: 218-237-3333 | fax:218-237-3377



\$895,000
MLS 7076961 Lake Home
6150 Inland Trails Road
Pequot Lakes MN 56472



website: www.AffinityRealEstate.com | email: info@affinityrealestate.com | office: 218-237-3333 | fax: 218-237-3377

Affinity
REAL ESTATE INC

\$895,000
MLS 7076961 Lake Home
6150 Inland Trails Road
Pequot Lakes MN 56472



website: www.AffinityRealEstate.com | email: info@affinityrealestate.com | office: 218-237-3333 | fax: 218-237-3377

Affinity
REAL ESTATE INC

\$895,000
MLS 7076961 Lake Home
6150 Inland Trails Road
Pequot Lakes MN 56472



website: www.AffinityRealEstate.com | email: info@affinityrealestate.com | office: 218-237-3333 | fax:218-237-3377



\$895,000
MLS 7076961 Lake Home
6150 Inland Trails Road
Pequot Lakes MN 56472



website: www.AffinityRealEstate.com | email: info@affinityrealestate.com | office: 218-237-3333 | fax:218-237-3377

Affinity
REAL ESTATE INC

\$895,000
MLS 7076961 Lake Home
6150 Inland Trails Road
Pequot Lakes MN 56472



website: www.AffinityRealEstate.com | email: info@affinityrealestate.com | office: 218-237-3333 | fax:218-237-3377



\$895,000
MLS 7076961 Lake Home
6150 Inland Trails Road
Pequot Lakes MN 56472



website: www.AffinityRealEstate.com | email: info@affinityrealestate.com | office: 218-237-3333 | fax:218-237-3377



\$895,000
MLS 7076961 Lake Home
6150 Inland Trails Road
Pequot Lakes MN 56472

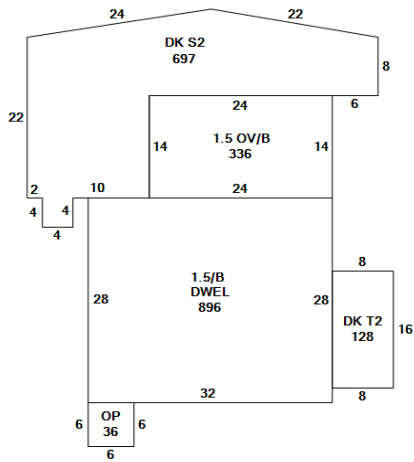

website: www.AffinityRealEstate.com | email: info@affinityrealestate.com | office: 218-237-3333 | fax: 218-237-3377



\$895,000
 MLS 7076961 Lake Home
 6150 Inland Trails Road
 Pequot Lakes MN 56472