



MLS 7077992 Residential

\$125,000

1,944 sq ft
3 bedrooms
3 baths

4856 State Hwy 84
Longville MN 56655

Status: Active

Description:

Tucked along the edge of town on a leased lot, this thoughtfully cared-for 3-bedroom home offers a setting that feels surprisingly private while still placing everyday conveniences within easy walking distance.

Set against a backdrop of woods, the property feels tucked away while still being close to everything in town. The landscaped yard creates a peaceful setting where birds and wildlife are frequent visitors, best enjoyed from the expansive screened porch or adjoining deck. Just across the road, a skating rink, pavilion, and new city playground add to the appeal, while shops, restaurants, and everyday essentials remain within easy walking distance.

Inside, the layout was designed for both gathering and everyday living. The family room centers around a charming arched stone, gas fireplace, while distinctive oversized windows bring natural light into the living and dining spaces. The kitchen offers abundant cupboard space along with an island designed for both seating and meal preparation, complete with built-in electrical access perfect for slow cookers, baking days, or holiday meals.

Two steps lead into a formal dining area, while nearby, the oversized laundry room adds exceptional practicality with extra cabinetry, space for an additional refrigerator, and its own sink and toilet. With direct access to the backyard deck, it's an ideal setup for gardening season, outdoor projects, or cleaning up before heading back into the rest of the home.

The owner's suite includes a spacious walk-through closet with dual entrances along with a private bath featuring a large soaking tub. Two additional bedrooms offer generous closet space, with a full bath conveniently located between them. A second living room provides even more flexibility for guests, hobbies, or quiet evenings at home. Complete with a large storage shed and beautifully maintained landscaping, this property reflects years of pride in ownership and a genuine love for the place they called home.

Additional Details:

Year Built 2003
Lot Acres 0.005
Lot Dimensions COMMON
School District 118

Taxes (unreported)
Listed By: (unreported)
Agents: Heartland Real Estate
Tax Year 2026
Affinity Real Estate Inc. participates in the Regional Multiple Listing Service of Minnesota, Inc Broker Reciprocity (sm) program, allowing us to display other broker's listings on our website. All properties are subject to change without notice.

Additional Features:
Basement: None Full Change of Ownership: No
Air: Forced Air, Fireplace(s) Sewer: City Sewer/Connected
Water: Shared System Air Conditioning: Central



Call Affinity Real Estate
218-237-3333
info@affinityrealestate.com



Driving Directions:

From Longville, south on HWY 84, left into the Towns Edge Park, take right after pond.



website: www.AffinityRealEstate.com | email: info@affinityrealestate.com | office: 218-237-3333 | fax: 218-237-3377

Affinity
REAL ESTATE INC

\$125,000
MLS 7077992 Residential
4856 State Hwy 84
Longville MN 56655



website: www.AffinityRealEstate.com | email: info@affinityrealestate.com | office: 218-237-3333 | fax:218-237-3377

Affinity
REAL ESTATE INC

\$125,000
MLS 7077992 Residential
4856 State Hwy 84
Longville MN 56655



website: www.AffinityRealEstate.com | email: info@affinityrealestate.com | office: 218-237-3333 | fax:218-237-3377



\$125,000
MLS 7077992 Residential
4856 State Hwy 84
Longville MN 56655



website: www.AffinityRealEstate.com | email: info@affinityrealestate.com | office: 218-237-3333 | fax:218-237-3377

Affinity
REAL ESTATE INC

\$125,000
MLS 7077992 Residential
4856 State Hwy 84
Longville MN 56655



website: www.AffinityRealEstate.com | email: info@affinityrealestate.com | office: 218-237-3333 | fax:218-237-3377

Affinity
REAL ESTATE INC

\$125,000
MLS 7077992 Residential
4856 State Hwy 84
Longville MN 56655

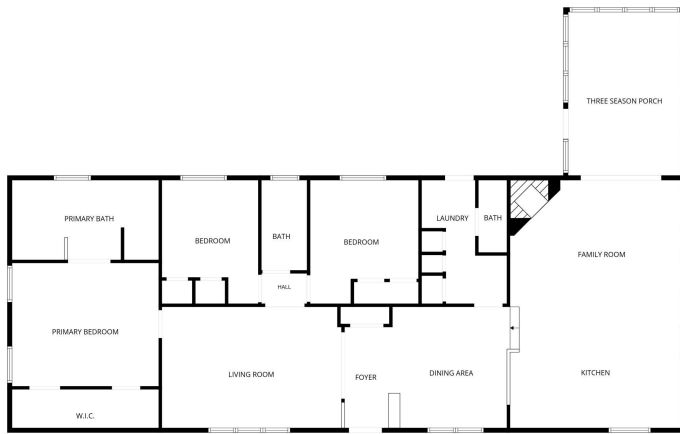

FLOOR PLAN CREATED BY CURICASA APP. MEASUREMENTS DEEMED HIGHLY RELIABLE BUT NOT GUARANTEED.

website: www.AffinityRealEstate.com | email: info@affinityrealestate.com | office: 218-237-3333 | fax: 218-237-3377



\$125,000
MLS 7077992 Residential
4856 State Hwy 84
Longville MN 56655