



MLS 7080016 Lake Home

\$1,350,000

1,592 sq ft
3 bedrooms
2 baths

23676 Melissa Drive
Detroit Lakes MN 56501

Waterfront: Melissa

Status: Active

Description:

Welcome home to your dream lake cottage on the sandy shores of Lake Melissa. This stunning, fully updated property boasts 155 feet of pristine, level lake frontage and offers the perfect blend of luxury, comfort, and timeless lake-life charm. Designed for effortless main-floor living, the property includes a charming main cottage, boathouse, bunkhouse, sauna, and playground — everything you need to create unforgettable memories at the lake. Start your mornings with breathtaking sunrises over the water and unwind each evening around the bonfire as the sun sets in peaceful serenity. Inside the main cottage, you'll find vaulted ceilings with exposed beams, a beautiful wood-burning stone fireplace, and panoramic lake views throughout. The spacious 38' x 14' screened porch with skylights creates the perfect indoor-outdoor entertaining space, while the sunroom offers a cozy retreat year-round.

The beautifully updated kitchen is a true showpiece, featuring:

- Expansive Wolf gas cooktop and range
- Stainless steel appliances
- Farmhouse sink overlooking the lake
- Tile backsplash and open shelving
- Massive eat-up island ideal for gathering and entertaining

Additional highlights include:

- 2 bedrooms
- Updated full bath with double sinks and leathered granite countertops
- Main-floor laundry
- Solid wood doors
- Luxury vinyl plank flooring throughout
- Central air conditioning
- Forced-air heat
- In-floor heat in the garage
- Tankless water heater
- Panoramic windows with incredible lake views

The private bunkhouse provides an ideal guest retreat complete with its own half bath. Near the shoreline, the 16' x 30' boathouse offers two garage doors, a service door, and convenient lakeside storage adjacent to the included dock. Relax in the sauna, watch the kids enjoy the playground, and soak in the unmatched beauty of lakeside living. The striking black cedar exterior is accented with copper soffits and copper accents that elevate the

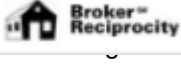
 Listed By:
 Berkshire Hathaway Home Services Premier
 Property
 Buyer will have the first option to purchase the adjoining
 portion of Melissa Dr. Parcel (3.51) acreage, allowing
 us to display other broker's listings on our website. All properties are
 subject to prior sale, change of withdrawal.



Call Affinity Real Estate
218-237-3333
info@affinityrealestate.com

Additional Details:

Year Built	1967
Lot Acres	0.76
Lot Dimensions	31,000 SQ. FT.

Affinity Real Estate - 600 Park Avenue South - Park Rapids MN 56470



website: www.AffinityRealEstate.com | email: info@affinityrealestate.com | office: 218-237-3333 | fax: 218-237-3377

Affinity
REAL ESTATE INC

\$1,350,000
MLS 7080016 Lake Home
23676 Melissa Drive
Detroit Lakes MN 56501



website: www.AffinityRealEstate.com | email: info@affinityrealestate.com | office: 218-237-3333 | fax: 218-237-3377

Affinity
REAL ESTATE INC

\$1,350,000
MLS 7080016 Lake Home
23676 Melissa Drive
Detroit Lakes MN 56501



website: www.AffinityRealEstate.com | email: info@affinityrealestate.com | office: 218-237-3333 | fax: 218-237-3377

Affinity
REAL ESTATE INC

\$1,350,000
MLS 7080016 Lake Home
23676 Melissa Drive
Detroit Lakes MN 56501



website: www.AffinityRealEstate.com | email: info@affinityrealestate.com | office: 218-237-3333 | fax: 218-237-3377

Affinity
REAL ESTATE INC

\$1,350,000
MLS 7080016 Lake Home
23676 Melissa Drive
Detroit Lakes MN 56501



website: www.AffinityRealEstate.com | email: info@affinityrealestate.com | office: 218-237-3333 | fax:218-237-3377



\$1,350,000
MLS 7080016 Lake Home
23676 Melissa Drive
Detroit Lakes MN 56501



website: www.AffinityRealEstate.com | email: info@affinityrealestate.com | office: 218-237-3333 | fax:218-237-3377



\$1,350,000
MLS 7080016 Lake Home
23676 Melissa Drive
Detroit Lakes MN 56501



website: www.AffinityRealEstate.com | email: info@affinityrealestate.com | office: 218-237-3333 | fax:218-237-3377

Affinity
REAL ESTATE INC

\$1,350,000
MLS 7080016 Lake Home
23676 Melissa Drive
Detroit Lakes MN 56501



website: www.AffinityRealEstate.com | email: info@affinityrealestate.com | office: 218-237-3333 | fax:218-237-3377

Affinity
REAL ESTATE INC

\$1,350,000
MLS 7080016 Lake Home
23676 Melissa Drive
Detroit Lakes MN 56501

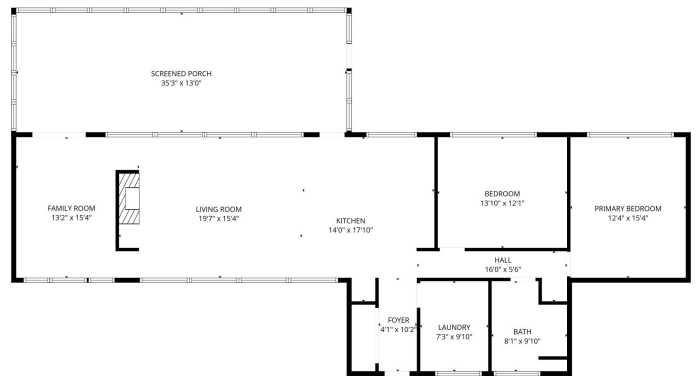

FLOOR PLAN CREATED BY CUBICASA APP. MEASUREMENTS DEEMED HIGHLY RELIABLE BUT NOT GUARANTEED.

website: www.AffinityRealEstate.com | email: info@affinityrealestate.com | office: 218-237-3333 | fax: 218-237-3377

Affinity
REAL ESTATE INC

\$1,350,000
MLS 7080016 Lake Home
23676 Melissa Drive
Detroit Lakes MN 56501